



Three Bedroom Semi-Detached House  
Station Road, Gillingham, Kent, ME8 7PS

Offers in Region of £270,000  
Freehold

Station Road, Gillingham, Kent, ME8 7PS

Offers in Region of £270,000

Freehold

## Description

Ready to move? Brilliant opportunity for a first-time buyer or buy-to-let investor seeking to diversify their portfolio. A three bedroom, recently refurbished, semi-detached home in the heart of Rainham. To the ground floor, an entrance hall, dining room, generously sized lounge, modern style kitchen and bathroom. Leading to the first floor, three light and airy bedrooms- the two main bedrooms of a generous size and the primary bedroom benefitting from an en-suite shower room. Externally, a considerably sized garden, detached garage and summer house/lodge - great for entertaining! Contact the Greyfox Sales Team in Rainham to book in your viewing and avoid disappointment.

## Key Features

- Three bedroom semi-detached home
- Summer house
- Garage
- En-suite
- Contemporary style kitchen
- Lounge and dining room
- Well served by many local amenities and transport links
- Rear garden measuring approximately 70' x 20'
- EPC energy rating C

## Local Area

Rainham in the Medway towns is located descending towards the banks of the river Medway, approximately 39 miles from London. The ancient Watling Street main road (A2) runs through the town with the M2 motorway on the southern edge with good links to the M25/M20. There are a good number

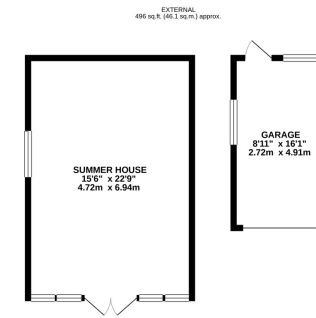

GROUND FLOOR  
524 sq.ft. (48.7 sq.m.) approx.

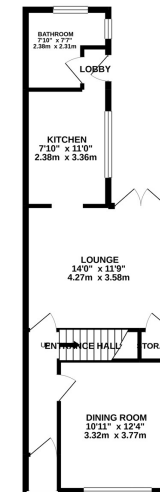

1ST FLOOR  
465 sq.ft. (43.2 sq.m.) approx.



TOTAL FLOOR AREA : 1485 sq.ft. (137.9 sq.m.) approx.

Whilst every attempt has been made to ensure the accuracy of the floorplan contained here, measurements of doors, windows, rooms and any other items are approximate and no responsibility is taken for any error, omission or mis-statement. This plan is for illustrative purposes only and should be used as such by any prospective purchaser. The services, systems and appliances shown have not been tested and no guarantee as to their operability or efficiency can be given.

Made with Metropix ©2020



## Property Location

Station Road, Gillingham, Kent, ME8 7PS

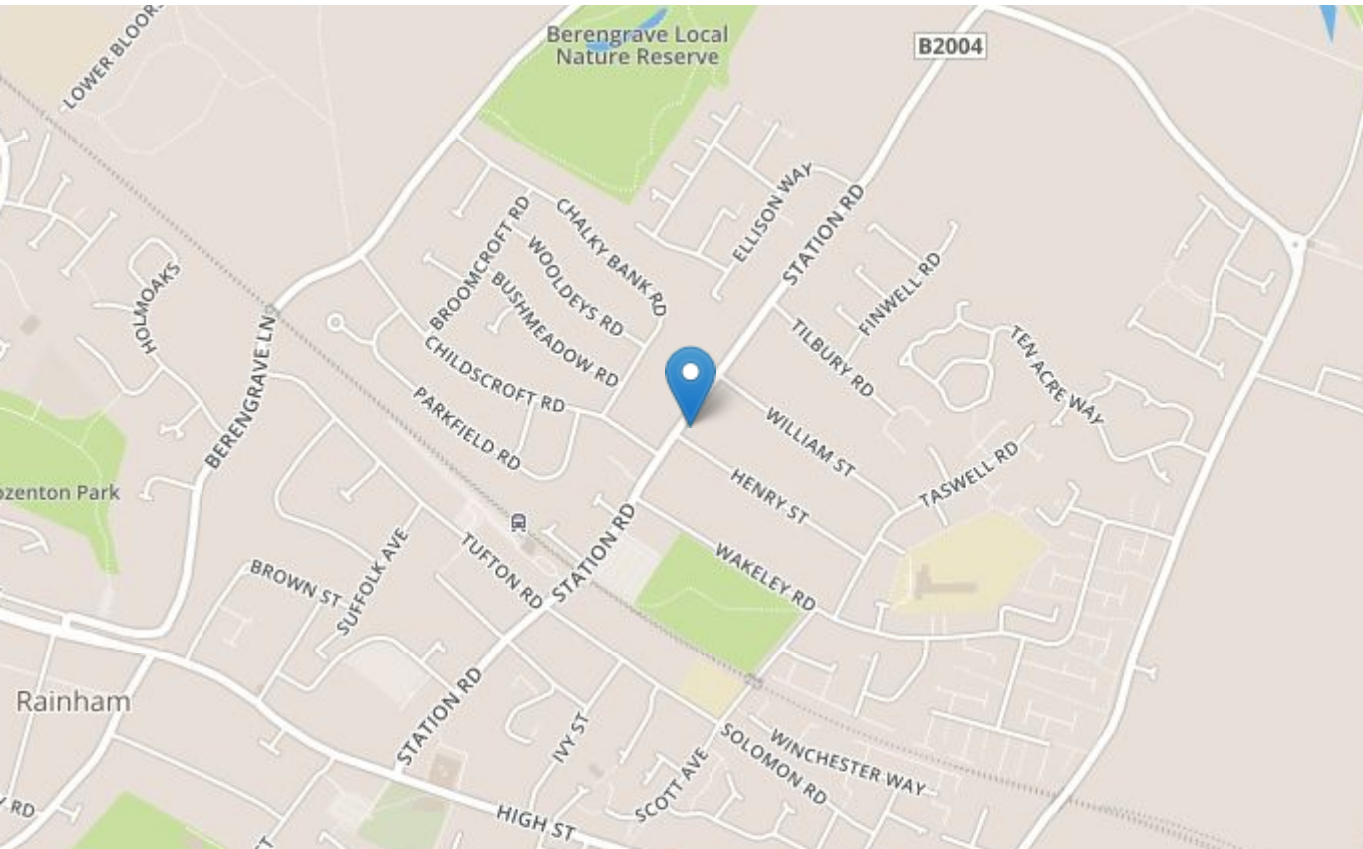

<b>Tenure</b>	Freehold
<b>Lease Term</b>	N/A
<b>Ground Rent</b>	N/A
<b>Service Charge</b>	N/A
<b>Local Authority</b>	Medway
<b>Council Tax</b>	Band B

### Greyfox Walderslade

Unit 2, Thetford House  
Walderslade Village Centre  
Walderslade Road  
Chatham  
Kent  
ME5 9LR  
Tel: 01634 672227 Email:  
walderslade@greyfox.co.uk

### Greyfox Rainham

67C High Street  
Rainham  
Kent  
ME8 7HS  
Tel: 01634 377737 Email:  
rainham@greyfox.co.uk

#### Agent Notes

These particulars are prepared as a general guide to a broad description of the property and should not be relied upon as a statement or representation of fact and do not constitute part of an offer or contract. The seller does not make or give nor do our employees or Greyfox have authority to make or give any representation or warranty to the property. We have not carried out a structural survey and the services, appliances and specific fittings have not been tested. All photographs, measurements, floorplans and distances referred to are given as a guide only and should not be relied upon for the purchase of carpets or any other fixtures or fittings. Lease details, service charges and ground rent (where applicable) and council tax are given as a guide only and should be checked and confirmed by you on inspection and your solicitor prior to exchange of contracts. If there are any points of particular importance to you we will be pleased to check the information for you and to confirm that the property remains available. This is particularly important should you be travelling some distance to view and where statements have been made by us to the effect that the information has not been verified. The copyright of all details, photographs and floorplans remain exclusive to Greyfox. For details of our privacy policy and referral fee arrangements with any of our selected partner companies please visit <https://www.greyfox.co.uk/legal/privacy> and <https://www.greyfox.co.uk/referral-fees>.