



Maltings Close

Baldock,

Hertfordshire, SG7 6RU

Freehold - Guide Price £300,000

country
properties

Chain free 2 bedroom semi detached home in need of cosmetic updating. Located on the ever popular Clothall Common development the home in Maltings Close has previously been let and as such is low being offered to the market chain free. In need of cosmetic modernisation throughout and priced to sell this would make an ideal first time/investment purchase!

- Chain free
- 2 Double bedrooms
- Cosmetic modernisation required throughout
- Allocated parking space
- Popular residential location
- Council Tax band C / EPC rating D

Accommodation

Entrance door to:-

Lounge/Diner

15' 6" x 12' 3" (4.72m x 3.73m)

Window to the front aspect, two radiators, stairs to the first floor, door to:-

Kitchen

12' 3" x 7' 0" (3.73m x 2.13m)

Window to the rear aspect, radiator, range of wall mounted and base level units with work surface over and inset sink with drainer, space for cooker, fridge/freezer, washing machine, wall mounted boiler, external door to rear garden.

First Floor

Landing

Doors to:-

Bedroom One

12' 3" x 8' 2" (3.73m x 2.49m)

Two windows to the front aspect, radiator.

Bedroom Two

12' 3" x 7' 3" max (3.73m x 2.21m)

Window to the rear aspect, radiator, airing cupboard.



Bathroom

WC, wash hand basin, heated towel rail, bath with shower attachment over.

External

Front

Small front garden laid to lawn with gated access at side to rear, allocated parking space.

Rear

Easterly facing rear garden laid to lawn measuring approx 30ft x 17ft with timber storage shed and gated access to front at side.





40 Maltings Close, Baldock

Ground Floor

Area: 26.5 m² ... 285 ft²

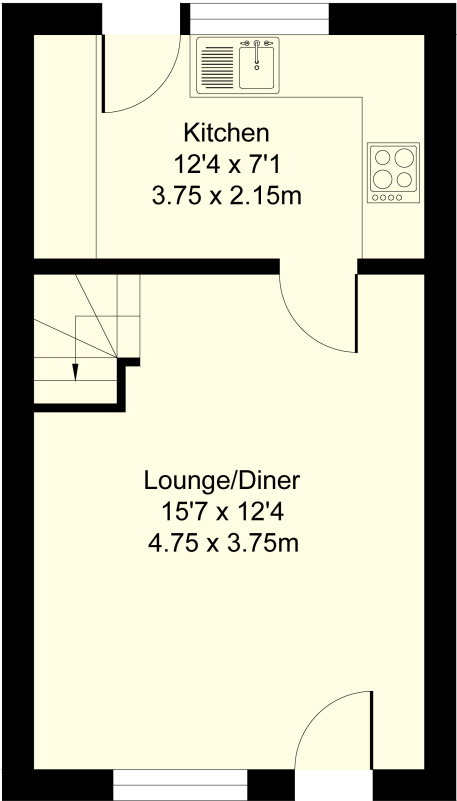

First Floor

Area: 26.3 m² ... 283 ft²

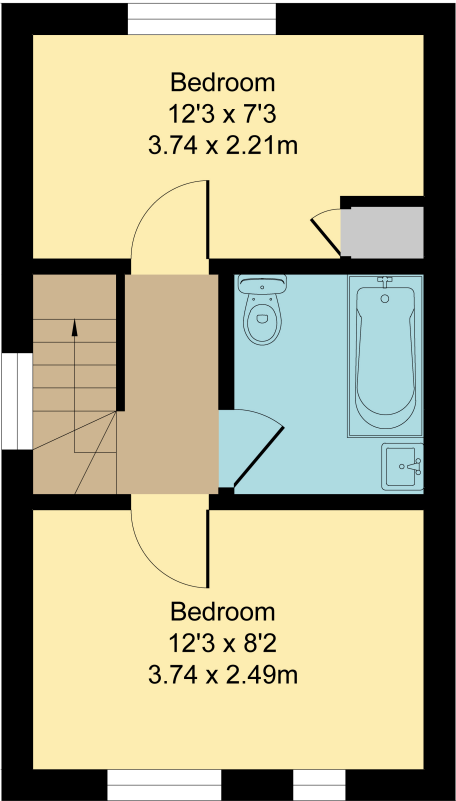

Total Area: 52.8 m² ... 568 ft²
All Measurements are approximate and for display purposes only

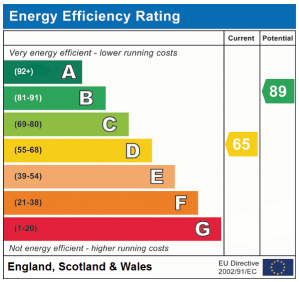

All measurements are approximate and quoted in metric with imperial equivalents and for general guidance only and whilst every attempt has been made to ensure accuracy, they must not be relied on. The fixtures, fittings and appliances referred to have not been tested and therefore no guarantee can be given and that they are in working order. Internal photographs are reproduced for general information and it must not be inferred that any item shown is included with the property. For a free valuation, contact the numbers listed on the brochure.

Viewing by appointment only

Country Properties | 39, High Street | SG7 6BG

T: 01462 895061 | E: baldock@country-properties.co.uk

www.country-properties.co.uk

country
properties