

FOR SALE

£240,000

Pitch Close, Greasby, Wirral. CH49 2RR



Popular Family Location! This charming three bedroom semi-detached residence is situated on the quiet Pitch Close in Greasby and is in close proximity to excellent local schools and amenities.

The ground floor comprises a a spacious, bright and airy lounge which is tastefully decorated with a glass staircase and a well-presented kitchen which has an array of wall and base units.

Ground Floor

Lounge

14' 2" x 16' 0" (4.32m x 4.88m)

Kitchen/Diner

14' 1" x 8' 6" (4.29m x 2.59m)

First Floor

Bedroom

13' 11" x 8' 3" (4.24m x 2.51m)

Bedroom

8' 3" x 10' 6" (2.51m x 3.20m)

Bedroom

5' 11" x 10' 1" (1.80m x 3.07m)

Bathroom

5' 11" x 5' 11" (1.80m x 1.80m)





Ground Floor

1st Floor

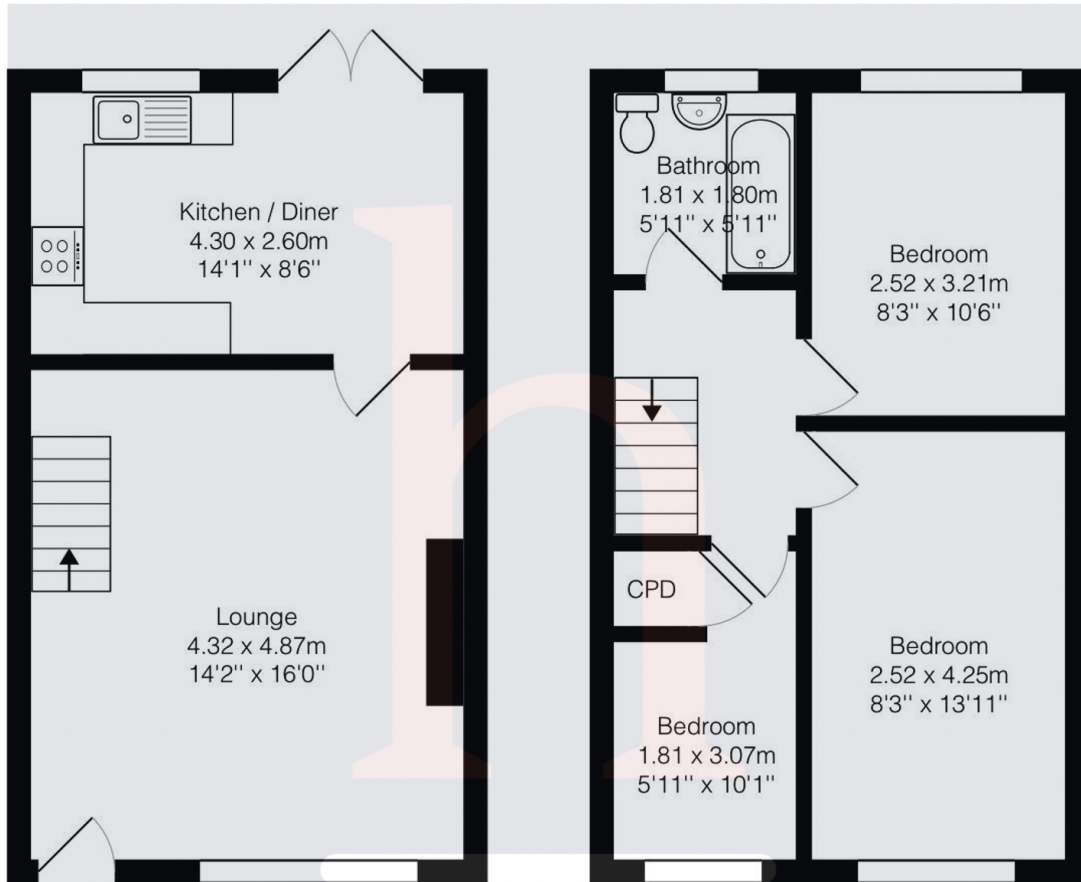

Total Area: 67.1 m² ... 722 ft²

All measurements are approximate and for display purposes only.