



One Bedroom Maisonette

Warnett Court, Willowside, Snodland, Kent, ME6 5QS

Offers in Excess of £165,000

Leasehold

Warnett Court, Willowside, Snodland, Kent, ME6 5QS

Offers in Excess of £165,000

Leasehold

Description

**** Open House**** Saturday 20th September . Call to secure appointment

A great opportunity for the first time buyer or investor to purchase this well maintained ground floor maisonette, situated in a quiet cul-de-sac. This lovely home is ready to move into and offers a modern, new fitted kitchen integrated oven and hob and washing machine to remain & worksurfaces with open plan living with lounge/diner. Continuing through you are welcomed to a good size bedroom and shower room. It also has the benefit of storage cupboards. Externally you have a well maintained communal garden and allocated parking space.

Leasehold has 88 years left.

Key Features

- One Bedroom Ground Floor Marionette
- Perfect for First Time Buyer
- Modern Fitted Kitchen
- Lounge/Dining Area
- Shower Room
- Allocated Parking
- Excellent Commuter Links
- Leasehold

Local Area

Snodland benefits from a good selection of local shops and services with a bus service into either Strood town centre or West Malling. There is easy access to the A228 that leads through to both the M20 and M2, whilst Snodland station has commuter trains to London. The nearby Medway Valley offers a large cinema, gym, 10 pin

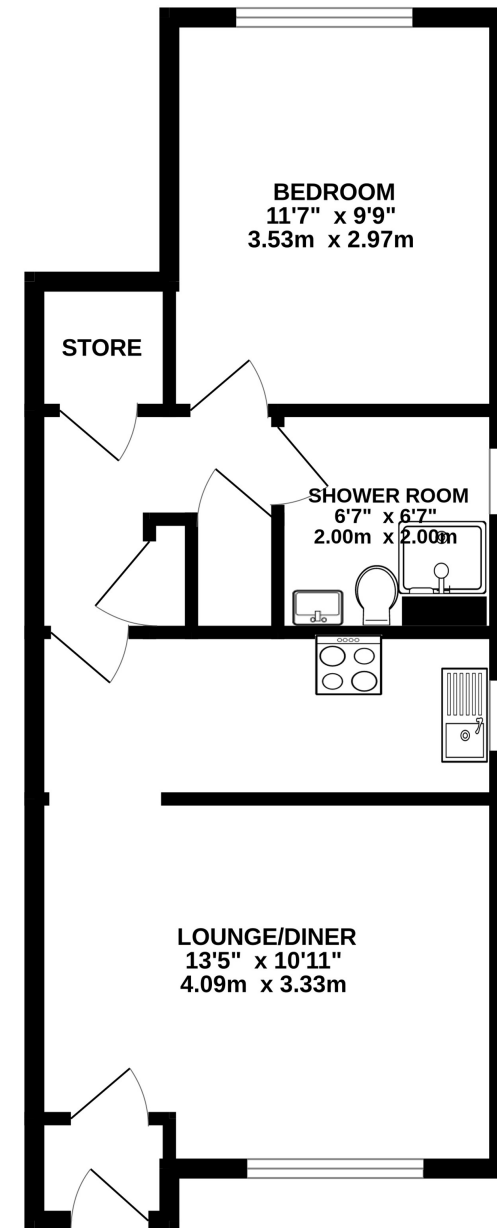

TOTAL FLOOR AREA : 442 sq.ft. (41.0 sq.m.) approx.

Whilst every attempt has been made to ensure the accuracy of the floorplan contained here, measurements of doors, windows, rooms and any other items are approximate and no responsibility is taken for any error, omission or mis-statement. This plan is for illustrative purposes only and should be used as such by any prospective purchaser. The services, systems and appliances shown have not been tested and no guarantee as to their operability or efficiency can be given.

Made with Metropix ©2025



Property Location

Warnett Court, Willowside, Snodland, Kent, ME6 5QS

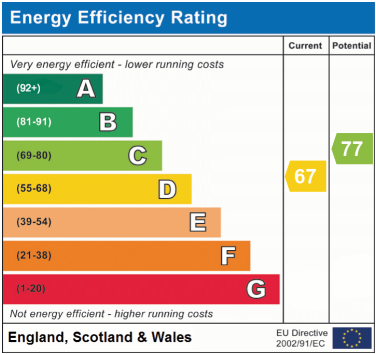
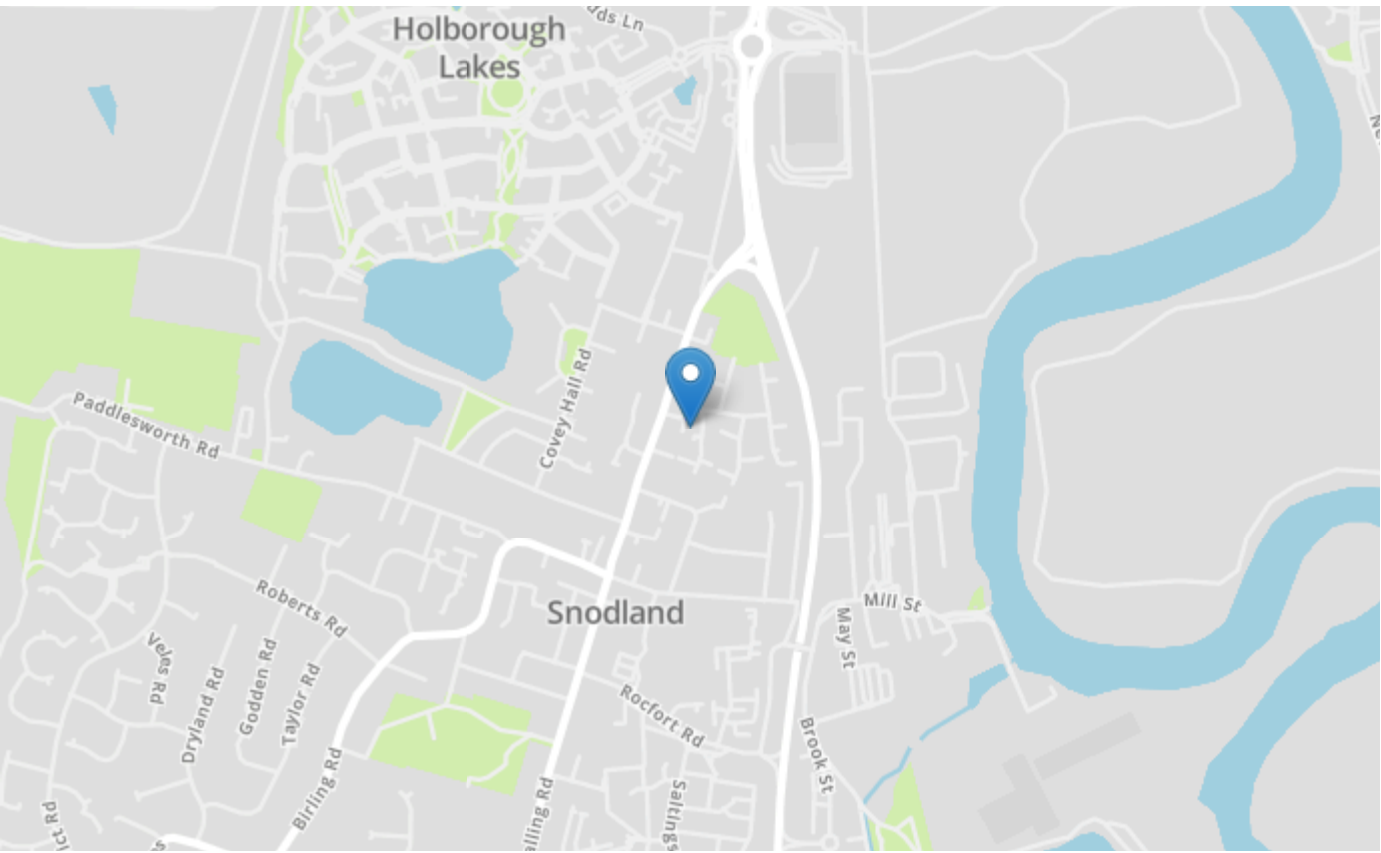

Tenure	Leasehold
Lease Term	88 years remaining (2025)
Ground Rent	£90 per annum
Service Charge	£1400 per annum
Local Authority	Tonbridge & Malling
Council Tax	Band A

Greyfox Walderslade
Unit 2, Thetford House
Walderslade Village Centre
Walderslade Road
Chatham
Kent
ME5 9LR
Tel: 01634 672227 Email:
walderslade@greyfox.co.uk

Greyfox Rainham
67C High Street
Rainham
Kent
ME8 7HS
Tel: 01634 377737 Email:
rainham@greyfox.co.uk

Agent Notes
These particulars are prepared as a general guide to a broad description of the property and should not be relied upon as a statement or representation of fact and do not constitute part of an offer or contract. The seller does not make or give nor do our employees or Greyfox have authority to make or give any representation or warranty to the property. We have not carried out a structural survey and the services, appliances and specific fittings have not been tested. All photographs, measurements, floorplans and distances referred to are given as a guide only and should not be relied upon for the purchase of carpets or any other fixtures or fittings. Lease details, service charges and ground rent (where applicable) and council tax are given as a guide only and should be checked and confirmed by you on inspection and your solicitor prior to exchange of contracts. If there are any points of particular importance to you we will be pleased to check the information for you and to confirm that the property remains available. This is particularly important should you be travelling some distance to view and where statements have been made by us to the effect that the information has not been verified. The copyright of all details, photographs and floorplans remain exclusive to Greyfox. For details of our privacy policy and referral fee arrangements with any of our selected partner companies please visit <https://www.greyfox.co.uk/legal/privacy> and <https://www.greyfox.co.uk/referral-fees>.