



Rosedawn Close East,
Hanley



OneAgency

01782 970222

hello@oneagencygroup.co.uk



£750 pcm

A modern furnished two bedroom first floor apartment located within walking distance to Hanley Town Centre. The property benefits from a hallway, lounge/diner/kitchen, two bedrooms and family bathroom suite. The property is located close to amenities, commuter links and nearby schools. Viewing is highly advised!





Ground Floor

Communal Entrance

Entered via a secure locked door, postal box and stairs to first floor.

First Floor

Hall

Front door, storage cupboard, radiator and carpet flooring.

Lounge/Kitchen/Diner

7.41m x 2.96m (24' 4" x 9' 9") A range of wall and base units with worktops, stainless steel sink basin, integral oven and gas hobs with extractor over, plumbing for a washing machine, space for a fridge/freezer, space for a table/chairs, double glazed windows, radiators, balcony and laminate flooring.



Bedroom One

3.81m x 2.70m (12' 6" x 8' 10") A Juliet balcony, radiator and laminate flooring.

Bedroom Two

2.27m x 2.09m (7' 5" x 6' 10") A double glazed window, fitted wardrobe unit, radiator and laminate flooring.

Bathroom

2.76m x 1.73m (9' 1" x 5' 8") A white suite with bath and overhead shower unit, pedestal hand wash basin, low level W/C, chrome towel radiator, double glazed window and vinyl flooring.

External

Communal gardens to the rear with a canal view.

GROUND FLOOR

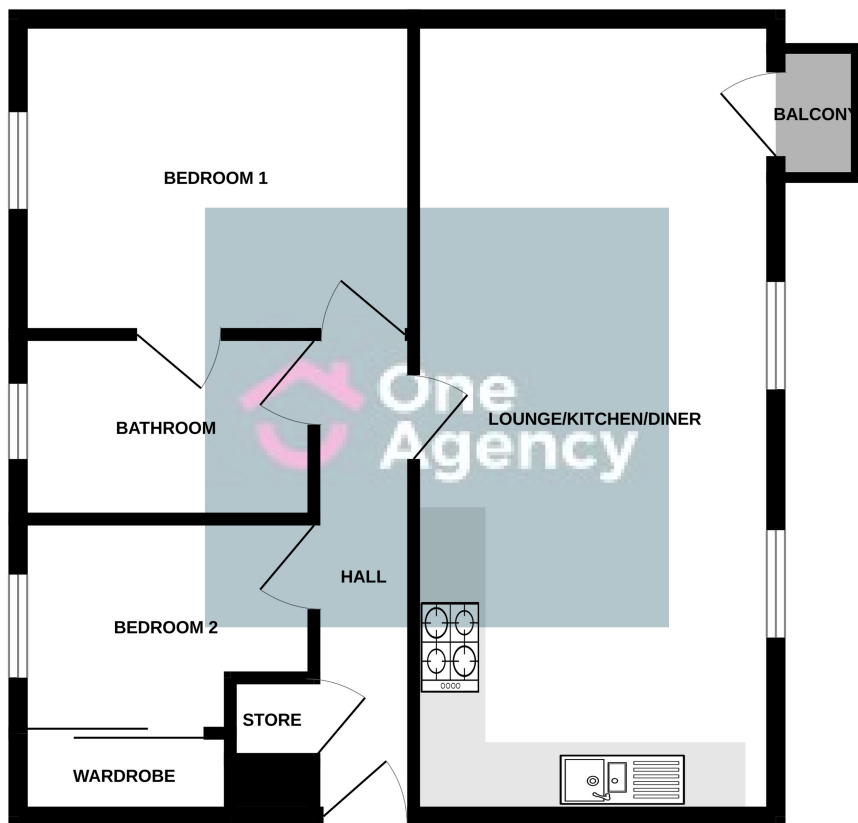

Whilst every attempt has been made to ensure the accuracy of the floorplan contained here, measurements of doors, windows, rooms and any other items are approximate and no responsibility is taken for any error, omission or mis-statement. This plan is for illustrative purposes only and should be used as such by any prospective purchaser. The services, systems and appliances shown have not been tested and no guarantee as to their operability or efficiency can be given.
Made with Metropix ©2023

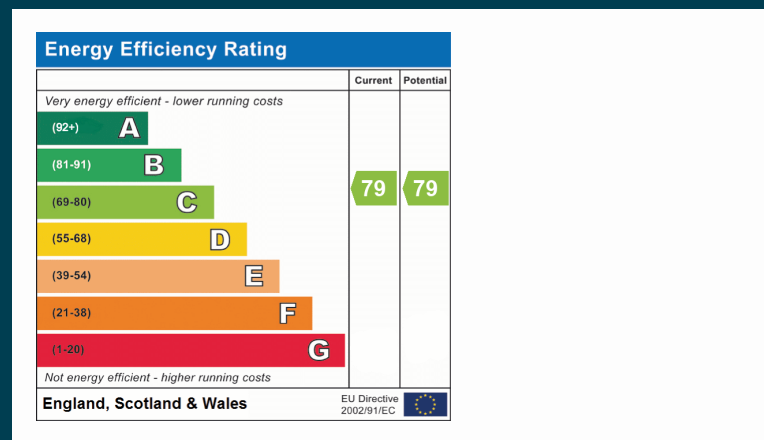

OneAgency, 9 & 10 Ridge House Drive, Festival Park, Stoke-on-Trent, ST1 5SJ

01782 970222

hello@oneagencygroup.co.uk

Every attempt has been made to ensure accuracy, however, all measurements are approximate and for illustrative purposes only. **Not to scale.**

In accordance with The Consumer Protection from Unfair Trading Regulations 2008 the following particulars have been prepared in good faith and they are not intended to constitute part of an offer or contract. We have not carried out a structural survey and the services, appliances and specific fittings have not been tested. All photographs, measurements, floor plans and distances referred to are given as a guide only and should not be relied upon for the purchase of carpets or any other fixtures and fittings. Lease details, service charges and ground rent (where applicable) are given as a guide only and should be checked and confirmed by your Solicitor prior to exchange of contracts.