

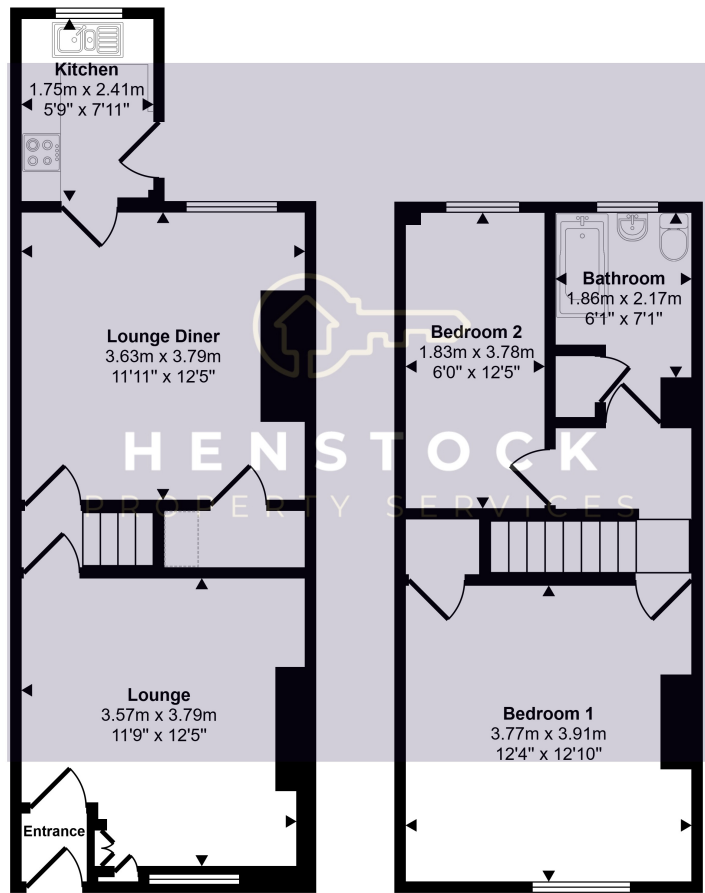

Approx Gross Internal Area
71 sq m / 760 sq ft



Ground Floor
Approx 37 sq m / 401 sq ft

First Floor
Approx 33 sq m / 360 sq ft

 Denotes head height below 1.5m

This floorplan is only for illustrative purposes and is not to scale. Measurements of rooms, doors, windows, and any items are approximate and no responsibility is taken for any error, omission or mis-statement. Icons of items such as bathroom suites are representations only and may not look like the real items. Made with Made Snappy 360.

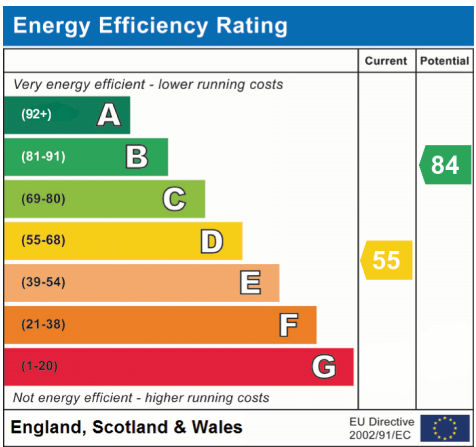

HENSTOCK
PROPERTY SERVICES



204 Coalshaw Green Road, Chadderton, Oldham, Lancashire OL9 8JS

- 2 BEDROOMED TERRACED
- NO CHAIN
- COUNCIL TAX BAND A
- EPC RATING D
- 2 RECEPTION ROOMS
- GAS CENTRAL HEATING
- DOUBLE GLAZED WINDOWS

Offers in Region of £150,000



PROPERTY DESCRIPTION

Henstock Property Services are pleased to market this 2 bedroomed mid terraced home which has been recently refurbished. The living accommodation briefly comprises; entrance into front lounge, 2nd lounge/diner, modern fitted kitchen, 2 bedrooms and a bathroom. The property also has the benefit of gas central heating, double glazed windows and a yard to rear. Ideally situated in this extremely popular spot within easy reach of schools, shops/supermarkets, leisure/fitness facilities, good public transport services and a short distance from the M60 & M62 motorway links.

GROUND FLOOR

Lounge

3.57m x 3.79m (11' 9" x 12' 5") views to front, double radiator.

Lounge/Diner

3.63m x 3.79m (11' 11" x 12' 5") views to rear, under stair storage, single radiator.

Kitchen

1.75m x 2.41m (5' 9" x 7' 11") views to rear, dark grey units with white marble style worktops, Asterite sink, chrome mixer tap, built in single electric oven, 4 ring ceramic hob, extractor, part tiled walls, door to rear.

FIRST FLOOR

Bedroom 1

3.77m x 3.91m (12' 4" x 12' 10") views to front, built in storage cupboard, double radiator.

Bedroom 2

1.83m x 3.78m (6' 0" x 12' 5") views to rear, double radiator.

Bathroom

1.86m x 2.17m (6' 1" x 7' 1") modern white suite comprising; bath with over bath wall mounted electric shower, glass screen, close coupled w.c, sink, part tiled / part marble effect boarded walls, built in storage, chrome heated towel rail.

Exterior

Paved rear yard.

