



DERBYSHIRE
PROPERTIES
— SALES & LETTINGS —

DERBYSHIRE



Hillary Close, Belper, Derbyshire DE56 0JH
£350,000 - Freehold



PROPERTY DESCRIPTION

Derbyshire Properties are delighted to offer for sale this spacious and attractively presented four-bedroom detached family home, ideally suited to growing families. The property is located within a peaceful cul-de-sac and benefits from landscaped gardens, generous living accommodation and excellent presentation throughout. The accommodation briefly comprises: entrance hallway, guest cloakroom/WC, dining room/sitting room, spacious living room and a well-appointed breakfast kitchen. To the first floor, the landing provides access to four bedrooms, a family bathroom and a modern en-suite shower room to the master bedroom. Externally, the property enjoys an attractive landscaped frontage with block-paved driveway providing off-road parking for 2-3 vehicles, leading to an integral garage. The tiered rear garden has been thoughtfully landscaped and offers elevated views across Belper, creating an ideal outdoor entertaining space. An early internal inspection is highly recommended to fully appreciate the quality and location of this superb family home.

POINTS OF INTEREST

- Detached Family Home
- 4 Bedrooms & 2 Reception Rooms
- En-Suite & Bathroom
- Attractive Blocked Paved Driveway
- Integral Garage
- Landscaped Gardens
- Fitted Kitchen
- Quiet Cul De Sac Location
- View Essential
- Council Tax Band D

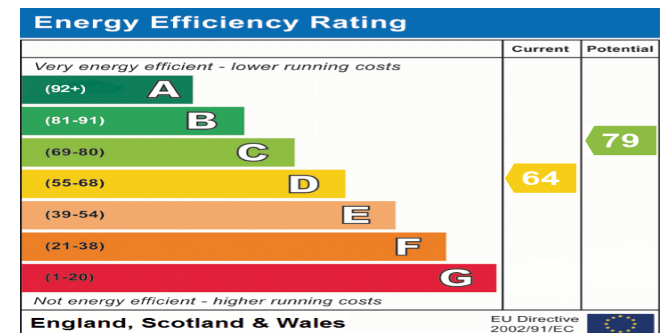

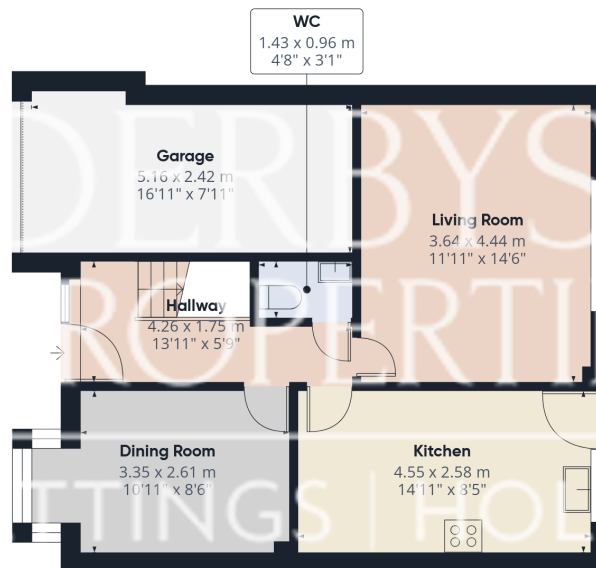

Ground Floor

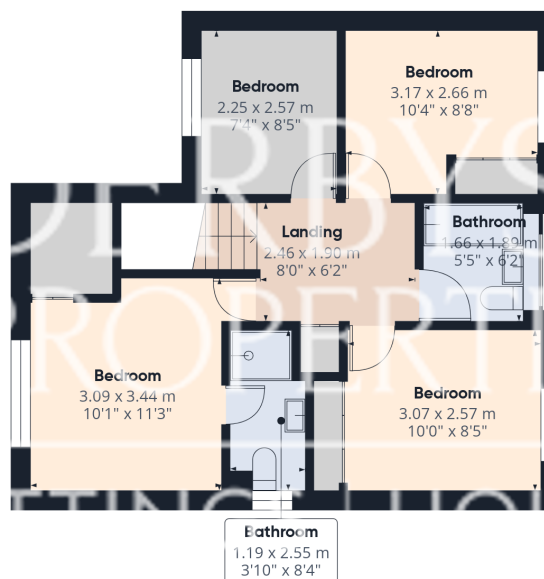

Floor 1



Approximate total area⁽¹⁾

105.9 m²

1142 ft²

(1) Excluding balconies and terraces

Calculations reference the RICS IPMS 3C standard. Measurements are approximate and not to scale. This floor plan is intended for illustration only.

GIRAFFE360