

## HAZLE CLOSE

£315,000



### Key Features

- ✓ Set in an established residential location.
- ✓ Three Bedroom Detached House.
- ✓ Two Bathrooms.
- ✓ Enclosed Garden.
- ✓ Garage and Off Road Parking.
- ✓ No Onward Chain.



GROUND FLOOR  
507 sq.ft. (47.1 sq.m.) approx.

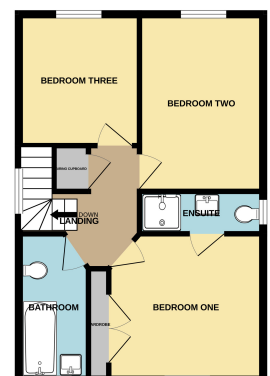
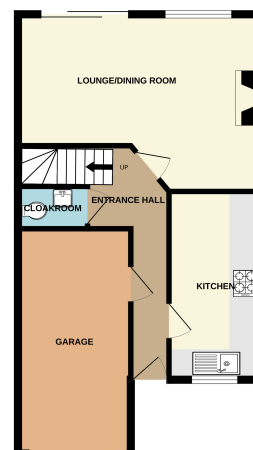

TOTAL FLOOR AREA: 916 sq.ft. (84.7 sq.m.) approx.  
Made with Merge 0205