

Mead Vale, Worle, Weston super Mare. BS22 8RA

£212,500 Freehold

FOR SALE



[www.housefox.co.uk](http://www.housefox.co.uk)

 **HOUSE FOX**  
ESTATE AGENTS

 **HOUSE FOX**  
THE FAIRER FEES ESTATE AGENTS

01934 314242  
01275 404601  
01278 557700  
[sales@housefox.co.uk](mailto:sales@housefox.co.uk)



## PROPERTY DESCRIPTION

HOUSE FOX ESTATE AGENTS PRESENTS.....A mid terraced 3 bedroom house with a garage for only £225,000

This mid terraced house is offered for sale with no onward chain and is set on the level and within a 10 minute walk of Worle High Street, local shops and schools.

The property would benefit from a bit of TLC, and comprises hallway, lounge, kitchen/diner, 3 bedrooms, bathroom, double glazing, gas central heating, enclosed rear garden and a garage

So if you need 3 bedrooms, want to move quickly, want to be walking distance of amenities, then look no further and call House Fox Estate Agents

## FEATURES

- WALK THROUGH 360 VIDEO TOUR AVAILABLE
- Terraced house
- 3 bedrooms
- 15ft kitchen/diner
- No onward chain
- Garage
- Gas central heating
- Double glazing
- In need of a bit of TLC
- EPC-C



## ROOM DESCRIPTIONS

**Main front door to the hallway:**

**Hallway:**

Stairs to the first floor, door to the lounge

**Lounge:**

15' 8" x 12' 9" (4.78m x 3.89m)

Double glazed window, radiator, under stairs cupboard, door to the kitchen/diner

**Kitchen/diner**

15' 11" x 8' 0" (4.85m x 2.44m)

Sink unit, floor and wall units, built in oven and hob, 2 double glazed windows, radiator, double glazed door to the garden

**First floor landing**

**Bedroom 1:**

12' 6" x 9' 11" (3.81m x 3.02m)

Radiator, double glazed window

**Bedroom 2:**

11' 10" x 9' 8" (3.61m x 2.95m)

Radiator, double glazed window

**Bedroom 3:**

9' 6" x 5' 9" (2.90m x 1.75m)

Radiator, double glazed window, cabin bed

**Bathroom:**

Bath, wash hand basin, low level WC, double glazed window, radiator

**Garage**

To the rear of the property is a SINGLE GARAGE

**Garden:**

The garden has patio area, lawn area and rear gate access







## FLOORPLAN & EPC

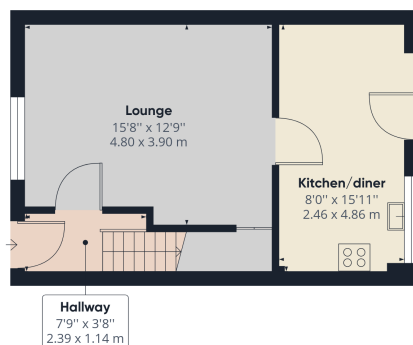

## Floor 0

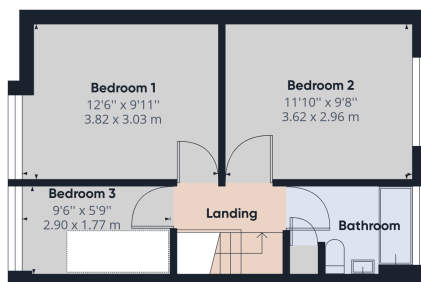

### Floor 1



**Approximate total area<sup>(1)</sup>**  
722.73 ft<sup>2</sup>  
67.14 m<sup>2</sup>

(1) Excluding balconies and terraces

While every attempt has been made to ensure accuracy, all measurements are approximate, not to scale. This floor plan is for illustrative purposes only.

GIRAFFE360

