

Plummers Hill

Paulton, BS39 7NR

COOPER
AND
TANNER



Offers in Excess of £200,000

A semi-detached period cottage dating from the 1750's and situated within the centre of this sought after village and offering ample driveway parking and a large garage.

Plummers Hill

Paulton

BS39 7NR



2



1



1

EPC E

Offers in Excess of £200,000

ACCOMMODATION

ENTRANCE PORCH

LOUNGE/DINING ROOM 16'6" max x 11'7"

KITCHEN 11'5" x 6'0" (3.48m x 1.83m)

BEDROOM ONE 9'9" x 8'5" (2.97m x 2.57m)

BEDROOM TWO 12'8" x 5'4" max (3.86m x 1.63m)

Council Tax - BANES - Band 'A'

BATHROOM 8'10" x 5'8" (2.69m x 1.73m)

GARAGE 17'6" length x 15'2" (5.33m x 4.62m)





GROUND FLOOR

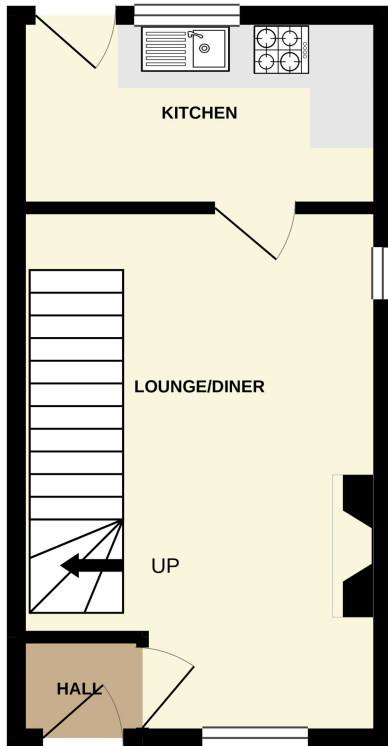

1ST FLOOR

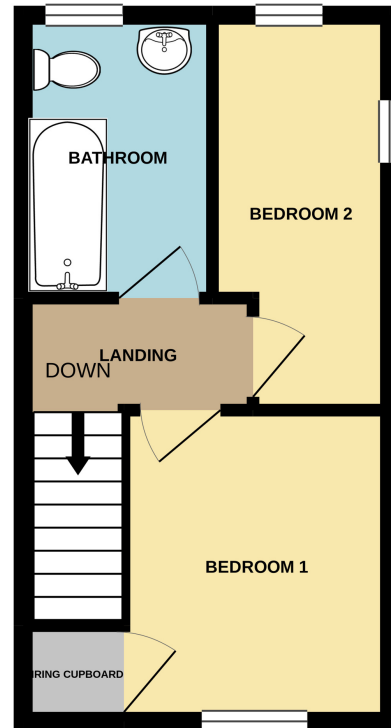

Whilst every attempt has been made to ensure the accuracy of the floorplan contained here, measurements of doors, windows, rooms and any other items are approximate and no responsibility is taken for any error, omission or mis-statement. This plan is for illustrative purposes only and should be used as such by any prospective purchaser. The services, systems and appliances shown have not been tested and no guarantee as to their operability or efficiency can be given.
Made with Metropix ©2021

MIDSOMER NORTON OFFICE

Telephone 01761 411010

14, High Street, Midsomer Norton, Somerset BA3 2HP

midsomernorton@cooperandtanner.co.uk

COOPER
AND
TANNER

Important Notice: These particulars are set out as a general outline only for the guidance of intended purchasers and do not constitute, nor constitute part of, an offer or contract. All descriptions, dimensions, reference to condition and necessary permissions for use and occupation, warranties and other details are given without responsibility and any intending purchasers should not rely on the m as statements or representations of fact but must satisfy themselves by inspection or otherwise as to the correctness of each of them.

