



28 Heywood Close, Onchan, Isle of Man. IM3 3AF

Immaculate semi-detached home which has recently benefitted from new windows, new boiler and new four piece bathroom. The property is located within a quiet Cul-de-Sac perfect for families due to its proximity to Cronk Y Berry and Bemahague schools.



£329,950 Freehold

PROPERTY DESCRIPTION

Manxmove are pleased to bring to market 28 Heywood Close, Onchan.

This superb semi detached home is offered in immaculate order throughout providing a turn key move for discerning buyers. Heywood Close is a quiet and well regarded Cul-de-Sac which is close to Cronk Y Berry Primary School, Bemahague Secondary School, Hailwood Medical Centre and Cat with no tail pub.

As you arrive at the property you will find a spacious driveway providing off road parking for several vehicles in tandem. On the ground floor is a large front facing lounge with under-stairs storage and a well appointed dining kitchen with level access into the private South facing garden.

The home boasts three bedrooms, providing comfort and space for the entire family, along with a recently fitted four piece bathroom and airing cupboard for storage.

Outside, you'll find a private South facing garden mainly laid to lawn, featuring a small flagged patio, gated access to one side and a practical storage shed with power and lighting.

FEATURES

- Immaculate Semi Detached Home
- Desirable Cul-de-Sac Location
- Close to Schools, Doctors, Pub and Shops
- Generous Lounge plus Kitchen/Diner
- 3 Bedrooms plus Modern Bathroom
- New Windows & Boiler
- Private South Facing Garden
- No Onward Chain



Property Images



FLOORPLAN

GROUND FLOOR
403 sq.ft. (37.4 sq.m.) approx.

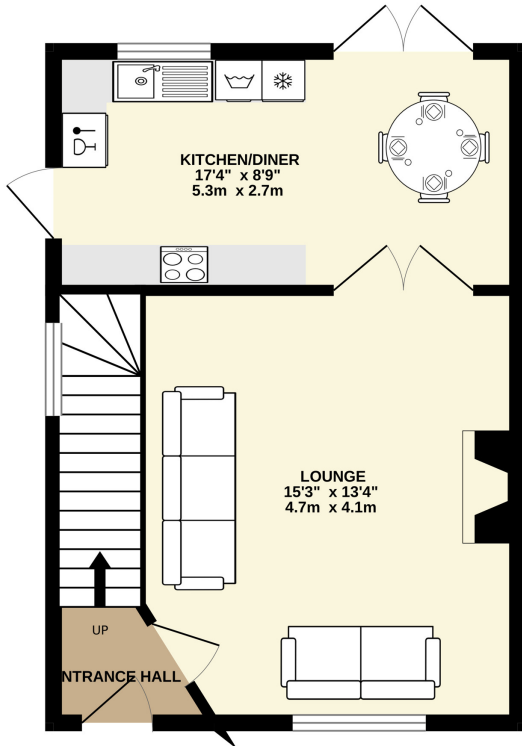

1ST FLOOR
396 sq.ft. (36.8 sq.m.) approx.

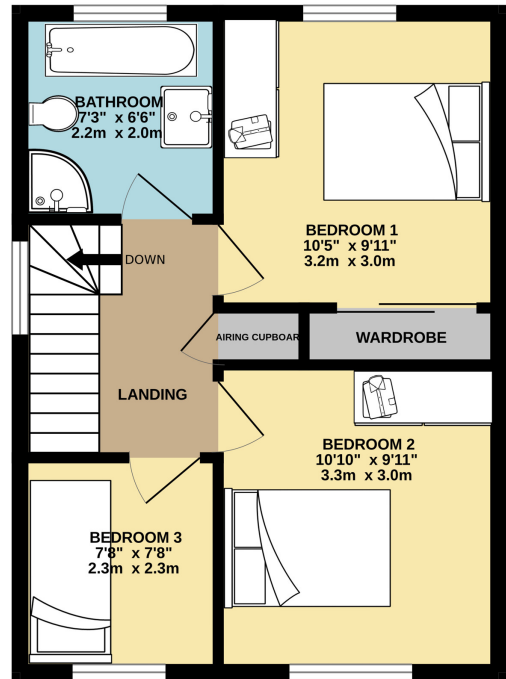

TOTAL FLOOR AREA: 799 sq.ft. (74.2 sq.m.) approx.

Whilst every attempt has been made to ensure the accuracy of the floorplan contained here, measurements of doors, windows, rooms and any other items are approximate and no responsibility is taken for any error, omission or mis-statement. This plan is for illustrative purposes only and should be used as such by any prospective purchaser. The services, systems and appliances shown have not been tested and no guarantee as to their operability or efficiency can be given.
Made with Metropix ©2024

DISCLAIMER: Whilst Manxmove Ltd believe that these details are correct, neither Manxmove Ltd or their clients guarantee their accuracy in any way. Consequently, these details are not to be used to form part of any legally binding contract. Prospective purchasers or tenants are advised to visit this property to satisfy themselves as to the correctness of these details. Please note, we use wide angle camera lenses in order to show as much of each room as possible. This is not intended to mislead any prospective purchasers or tenants in any way and an honest verbal description is always available prior to viewing if required.