



## **Becquerel Court, West Parkside, Greenwich, London. SE10 0QA.**

**£420,000**

Light and spacious two/three bedroom apartment located in the highly sought after Greenwich Millennium Village. Offering spacious accommodation with ample space for dining and entertaining.

Ideally positioned just a short walk from North Greenwich Underground Station (Jubilee Line), the Emirates Cable Car, and The O2 Arena, offering an extensive selection of bars, restaurants, and entertainment facilities. Everyday amenities are close at hand, with Sainsbury's, Aldi, Asda, and IKEA all within walking distance. Further benefits include an on-site primary school, nursery, Eco Park, 24-hour concierge service, excellent transport links, and a prime riverside location moments from The O2.

Viewing by appointment with 1st avenue.

**Call: 020 8293 8600**

1st avenue, 128 Metcalfe Court, West Parkside, London SE10 0EL  
email: [info@1stavenue.co.uk](mailto:info@1stavenue.co.uk)

100 Becquerel Court, West  
Parkside, Greenwich, London, .  
SE10 0QA

£420,000

1stavenue  
Real Estate Services

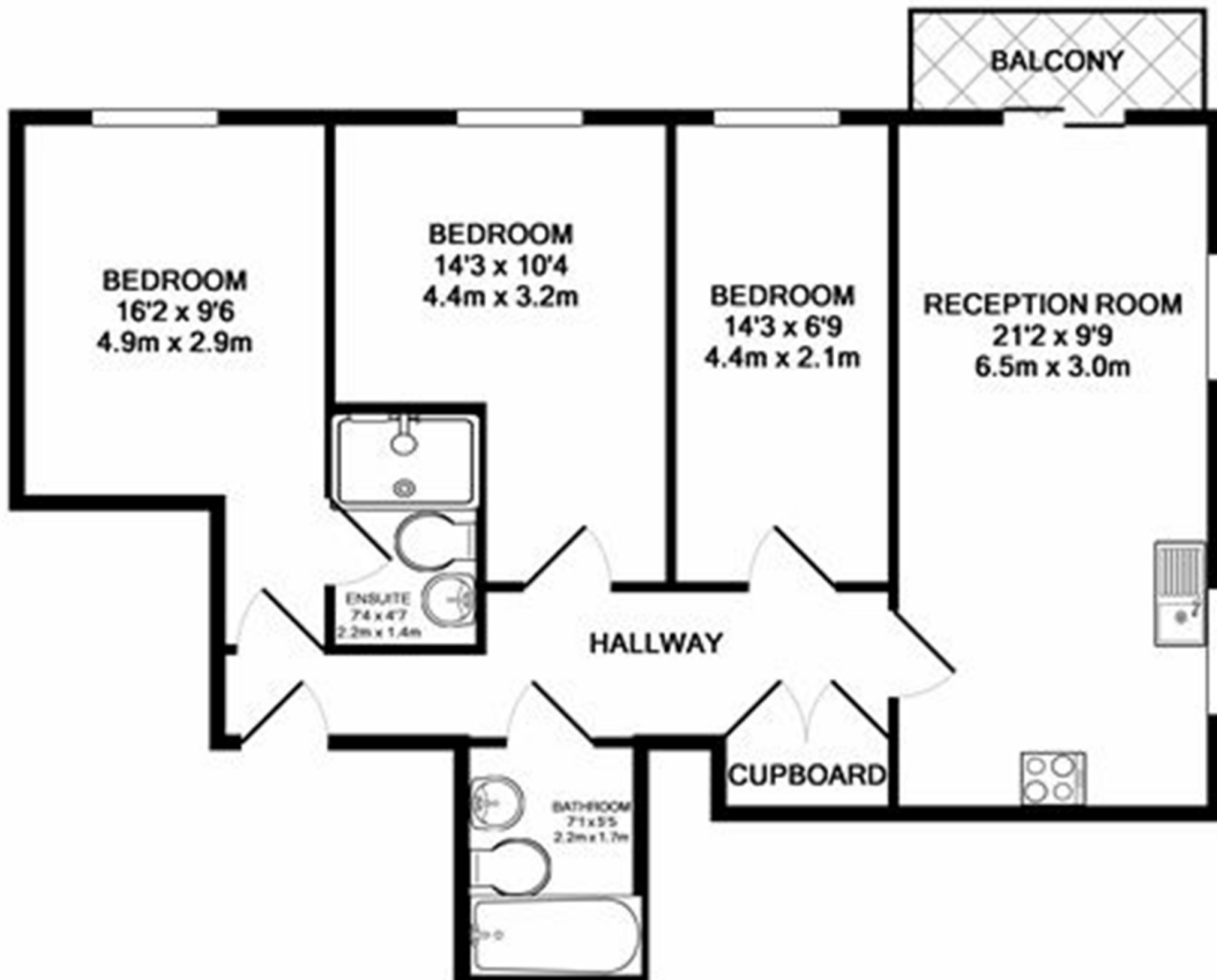

TOTAL APPROX. FLOOR AREA 719 SQ.FT. (66.8 SQ.M.)

Whilst every attempt has been made to ensure the accuracy of the floor plan contained here, measurements of doors, windows, rooms and any other items are approximate and no responsibility is taken for any error, omission, or mis-statement. This plan is for illustrative purposes only and should be used as such by any prospective purchaser. The services, systems and appliances shown have not been tested and no guarantee as to their operability or efficiency can be given

Made with Metropix ©2014

Viewing by appointment with 1st avenue.

**Call: 020 8293 8600**

1st avenue, 128 Metcalfe Court, West Parkside, London SE10 0EL  
email: info@1stavenue.co.uk

**1stavenue**  
Real Estate Services