

Rent
Me



Rockford Gardens, Great Sankey.

£1,250 pcm

4 Bedrooms | Detached Garage | Kitchen | Separate Dining Room | Off road parking | Cul De Sac
Position | Chapelford Development | Popular Location |



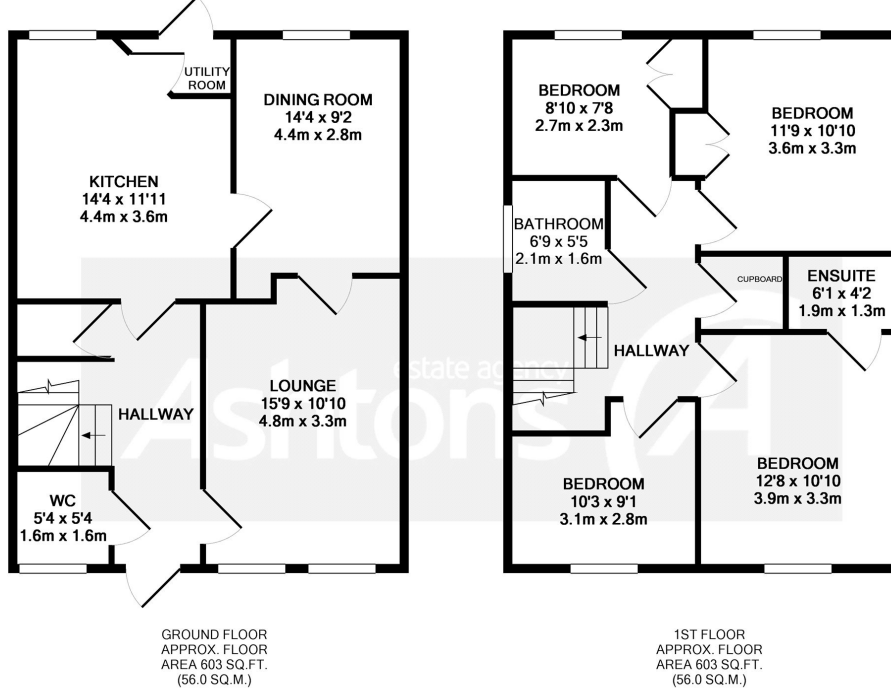

Whilst every attempt has been made to ensure the accuracy of the floor plan contained here, measurements of doors, windows, rooms and any other items are approximate and no responsibility is taken for any error, omission, or mis-statement. This plan is for illustrative purposes only and should be used as such by any prospective purchaser. The services, systems and appliances shown have not been tested and no guarantee as to their operability or efficiency can be given
Made with Metropix ©2017

Ashtons have available to let this superb detached family home which commands a larger than average plot. Its location is perfectly suited to those who regularly commute with its direct access to major motorway networks. It is also sits within the catchment to a number of highly regarded schools both primary and secondary, they are just a few minutes' walk away as are a number of essential amenities.

Arranged over two storeys it features; entrance hall with stair access, ground floor cloaks/W.C., a lounge and a separate dining room, utility room, a well equipped fitted kitchen which offers a range of wall/base units and breakfast bar area. There are four bedrooms on the first floor which are well proportioned with the master having access to its own en-suite shower room, landing with loft access, airing cupboard and a three piece family bathroom. Outside the rear garden has been mainly laid to



Contact your local office to arrange a viewing:

- Padgate:** 01925 479334
- Great Sankey:** 01925 454300
- Winwick:** 01925 232146
- Stockton Heath:** 01925 453400
- St.Helens:** 01744 754120
- Wigan:** 01942 498862
- Culcheth:** 01925 764744
- Ashton-In-Makerfield:** 01942 364446
- Newton-Le-Willows:** 01925 907770
- Commercial Office:** 01925 907709
- Lettings Head Office:** 01925 873533
- Financial Services:** 01925 221234

Viewing Arrangements
Viewing is strictly by appointment only through Ashtons Estate Agency.

Disclaimer Property Details
These particulars, whilst being believed to be accurate are set out as a general outline only for guidance and do not constitute any part of an offer or contract. Intending purchasers should not rely on them as statements of representation of fact, but must satisfy themselves by inspection or otherwise as to their accuracy. We have not carried out a detailed survey nor tested the services, appliances and specific furnishings. The measurements given are approximate. No person in this firms employment has the authority to make or give any representation or warranty in respect of the property.

All details, photographs and floorplans are the copyright of Ashtons Estate Agency.

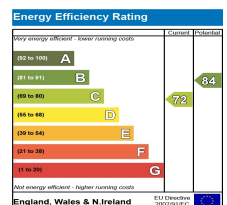

How much you can borrow?
Speak to a mortgage expert in your local office.

Ashtons Financial Services