

This family home is situated within easy walking distance of Slough Train Station (Elizabeth Line) and several OUTSTANDING local schools such as St Bernard's catholic Grammar School, Upton Court Grammar School & Iqra Slough Islamic School.

The house itself is completely FREEHOLD and offered to the market with NO ONWARD CHAIN. The accommodation is spread across three floors ensuring that space is never compromised on. All THREE bedrooms are large double bedrooms with the master having the entire top floor just for this bedroom separate dressing room and the en suite bathroom. Bedroom's two & three are located on on the first floor along with the family bathroom. Finally the entrance / ground floor allows access the the downstairs WC, separate kitchen and family lounge area. At the rear of the family lounge you will find the patio doors allowing access into the private enclosed rear garden.

Allocated parking to the front completes this home and ensures that everything your family could need is catered for.



Property Information

-  ALLOCATED PARKING
-  NO ONWARD CHAIN
-  DOWNSTAIRS WC
-  SOUGHT AFTER LOCATION
-  FREEHOLD
-  THREE BEDROOMS
-  TWO BATHROOMS
-  DRESSING ROOM OFF MASTER BEDROOM

					
x3	x1	x2	x1	Y	N
Bedrooms	Reception Rooms	Bathrooms	Parking Spaces	Garden	Garage

Location

Uxbridge Road is conveniently situated in the town of Slough and with access to Slough train station which is located within a short walk of the property. Everyday amenities can be found at The Town Centre, Windsor, and Burnham, with more comprehensive facilities available in Beaconsfield and Maidenhead. The National Trust property, Cliveden House, also located in Taplow has over 300 acres of woodlands and gardens leading down to the River Thames.

Communication links in the area are excellent with rail connections to London (Paddington) from Slough. The area also benefits from Crossrail (Elizabeth Line) which is now up and running, giving direct and fast journey times from Slough station to London's West End, City and Canary Wharf. The M40 and M4 motorways are within reach and provide access to the M25 and Heathrow.

Transport Links

Nearest stations:
Slough (1 mile)
Langley (1.8 miles)

All of these stations are on the Elizabeth Line.

The M40 (Junction 2) can be joined at Beaconsfield linking with the M25. The M4 (Junction 6 & 7) also provides access to the M25 and the national road network giving access to London, Heathrow, Reading and the west. There is a mainline railway station in Slough (Queen Elizabeth Line) offering services to Central London and Reading. A direct line to London Waterloo runs from Datchet & Windsor & Eton Riverside. From Beaconsfield there is a service to Marylebone.

Schools

Primary Schools:

Iqra Slough Islamic School
0.6 miles away State school

Wexham Court Primary School
0.6 miles away State school

St Ethelbert's Catholic Primary School
0.6 miles away State school

Willow Primary School
0.5 miles away State school

Secondary Schools:
Upton Court Grammar School
1 mile away State school

St Joseph's Catholic High School
0.8 miles away State school

St Bernard's Catholic Grammar School
1 mile away Grammar school

Council Tax

Band D

Floor Plan

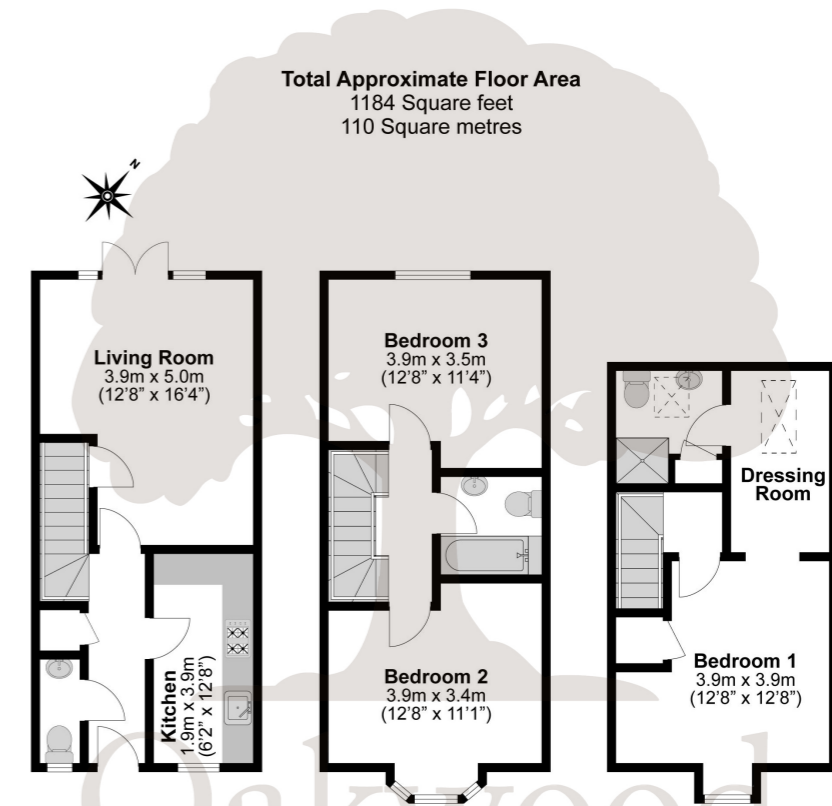

Illustrations are for identification purposes only, measurements are approximate, not to scale.

Prospective purchasers should be aware that these sales particulars are intended as a general guide only and room sizes should not be relied upon for carpets or furnishing. We have not carried out any form of survey nor have we tested any appliance or services, mechanical or electrical. All maps are supplied by Goview.co.uk from Ordnance Survey mapping. Care has been taken in the preparation of these sales particulars, which are thought to be materially correct, although their accuracy is not guaranteed and they do not form part of any contract.

