



THE ESTATE AGENTS  
1977





Cedar Road, Northampton NN1 4RW  
Offers Over £250,000 - Freehold



## PROPERTY DESCRIPTION

The Estate Agents are pleased to present this spacious, well presented, three bedroom Victorian terrace in the highly desirable and sought after area of Abington. The accommodation briefly comprises; entrance hall with stairs to the first floor and cellar, open plan living/dining room, breakfast room, kitchen and W.C. On the first floor are three generous bedrooms and bathroom. Outside the property benefits from a low maintenance rear garden leading to a double garage with power and lighting. The property has recently undergone repairs and maintenance work ready for the new owners to decorate to their taste.

Abington is a desirable area close to all the amenities, restaurants and bars found on the Wellingborough Rd, Abington Park is also nearby. The property is within easy reach of Northampton Racecourse, Town Centre and Train Station which has a regular service to London Euston in under an hour.

## POINTS OF INTEREST

- Bay Fronted Victorian Terrace
- Three Generous Bedrooms
- Through Hallway
- Open Plan Living /Dining Room
- Breakfast Room
- Ground Floor W.C
- Cellar
- Double Garage
- Highly Desirable And Sought After Area Of Abington
- No Upward Chain

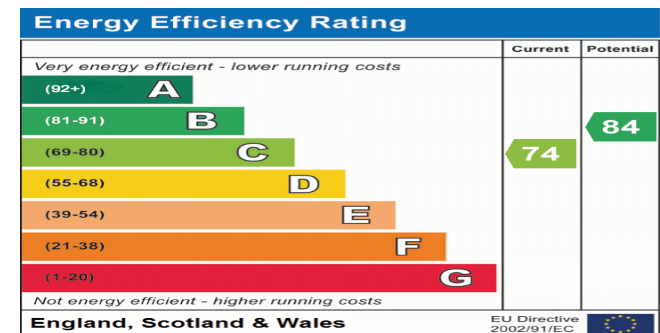

GROUND FLOOR  
641 sq.ft. (59.6 sq.m.) approx.

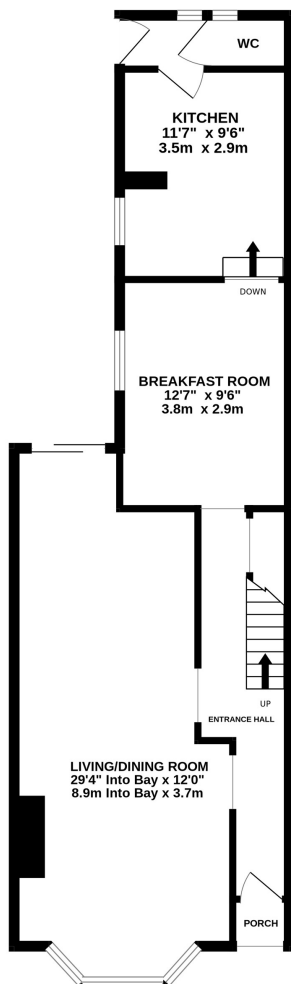

539 sq.ft. (50.1 sq.m.) approx.



1ST FLOOR  
508 sq.ft. (47.2 sq.m.) approx.

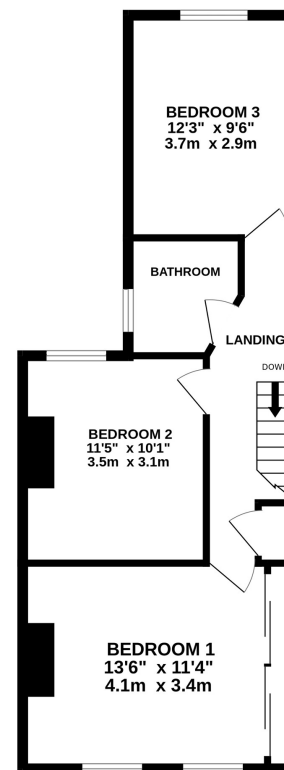

TOTAL FLOOR AREA : 1688 sq.ft. (156.8 sq.m.) approx.

Whilst every attempt has been made to ensure the accuracy of the floorplan contained here, measurements of doors, windows, rooms and any other items are approximate and no responsibility is taken for any error, omission or mis-statement. This plan is for illustrative purposes only and should be used as such by any prospective purchaser. The services, systems and appliances shown have not been tested and no guarantee as to their operability or efficiency can be given.  
Made with Metropix ©2025