



19 Hythe Road, Staines-upon-Thames, Surrey, TW18 3ED

STUNNING TWO BEDROOM SEMI-DETACHED CHARACTER PROPERTY SITUATED ALONG THIS MUCH SOUGHT AFTER ROAD IDEALLY LOCATED FOR EASY ACCESS TO STAINES TOWN CENTRE & LOCAL MOTORWAY NETWORKS. The property benefits from a spacious lounge, luxury kitchen/diner, family room, downstairs W.C, two double bedrooms, modern white bathroom suite and large secluded rear garden. Viewings Highly Recommended!

ROOM DESCRIPTIONS

Partly glazed door leading to:

Entrance Hall

Light and power points, vertical radiator, stairs to first floor, doors to:

Downstairs W.C.

Low level W.C, wash hand basin inset to cabinet, understairs storage cupboard housing fuseboard.

Lounge

Front aspect UPVC double glazed Bay window, light and power points, double radiator, cast-iron feature fireplace with tiled insert, wood-style laminate flooring.

Family Room

Rear aspect UPVC double glazed door to Garden, light and power points, TV point, vertical radiator, leading to Kitchen.



Kitchen/Diner

Side aspect UPVC double glazed window, range of modern fitted units at eye and base level, 1 1/2 bowl ceramic sink, built-in oven and hob with extractor over, integrated fridge/freezer, washing machine and dishwasher. Recessed downlighters. Dining Area with rear aspect UPVC double glazed French doors to Garden, Velux windows, vertical radiator and side aspect UPVC double glazed window.



First Floor

Landing

Side aspect double glazed window, light point, access to loft space, doors to:

ROOM DESCRIPTIONS

Bedroom 1

Rear aspect UPVC double glazed window, light and power points, radiator, door to walk-in wardrobe with light, power points and radiator.

Door to:



Bathroom

Rear aspect UPVC double glazed window, panel enclosed bath with shower over, low level W.C, partly tiled walls, tiled floor, recessed downlighters, extractor.



Bedroom 2

Front aspect UPVC double glazed window, light and power points, radiator.



Outside

Front Garden

Mainly laid to gravel, pathway to door with gated side access.

Rear Garden

Patio area nearest to house, mainly laid to lawn, enclosed by wood-panel fencing, hardstanding for timber shed, outside light and power.



FLOORPLAN

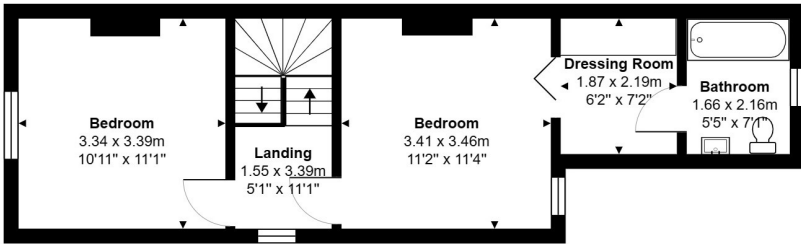

First Floor

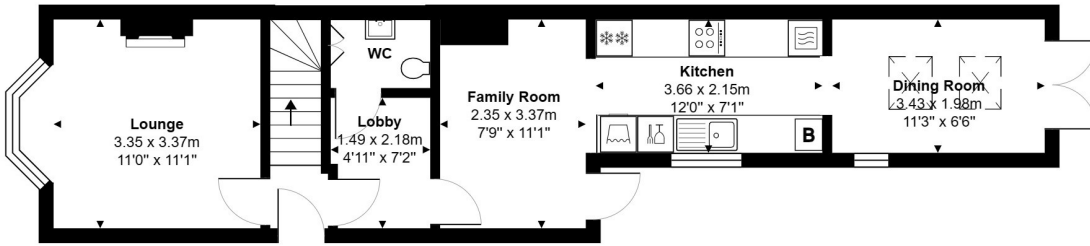

Ground Floor

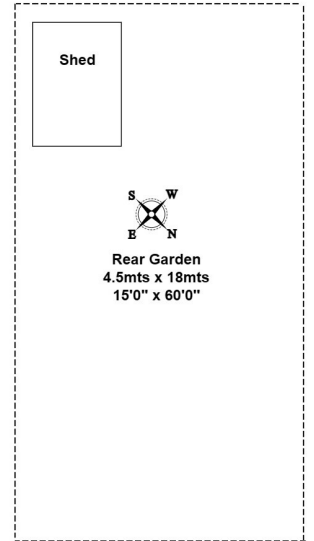

Garden

Total Area: 83.1 m² ... 894 ft²

All measurements are approximate and for display purposes only.