

46 Jeffery Street,
Gillingham, ME7 1BZ

Tel: 01634 780760
info@cobblestoneestates.co.uk



89 King Street, Gillingham, ME7 1ER

£1,495 pcm Freehold

- AVAILABLE NOW
- 3 SEPARATE BEDROOMS
- LARGE MASTER BEDROOM
- CLOSE TO GILLINGHAM HIGH STREET & TRAIN STATION
- EPC Rating





Cobblestone Estates is pleased to offer this fantastic 3 bedroom property located on King Street. Three bedroom mid terrace property house with two separate reception rooms on the ground floor leading onto a kitchen and the bathroom to the rear of the ground floor. To the first floor there are three bedrooms, The property also benefits from double glazing and gas central heating.

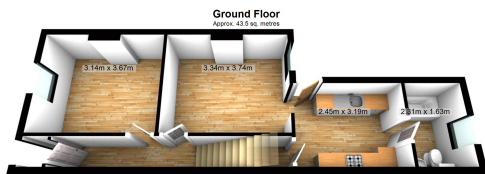

All images used are for illustrative purposes only, and are intended to convey the concept of the property. There for to be used as guide only may not necessarily represent a true and accurate description and look of the property.
Plan produced using Planity