



Brudenell Road, Tooting Bec, SW17 8DE

£875,000 Freehold

3 Bedroom Terrace House For Sale



PROPERTY DETAILS

- Edwardian Terrace House
- Potential to Extend (STP)
- Excellent Location
- A Low Maintenance Garden
- 3 Bedrooms (2 Double 1 Single)
- 2 Spacious Reception Rooms
- Large Eat-In Kitchen
- Close to Popular Schools
- 2 Bathrooms
- Gas Central Heating
- Chain Free / Freehold
- EPC Rating = D



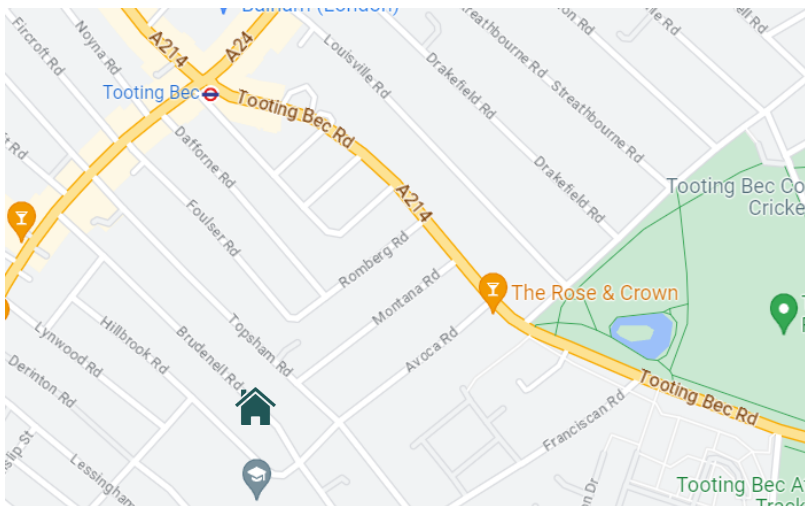

 **Tooting Bec 8 Minute Walk**

 **Tooting Broadway 15 Minute**

 **Tooting Bec Common 7 Min Walk**

 **Hillbrook Primary 2 Minute Walk**

 **Ernest Bevin 12 Minute Walk**

GROUND FLOOR

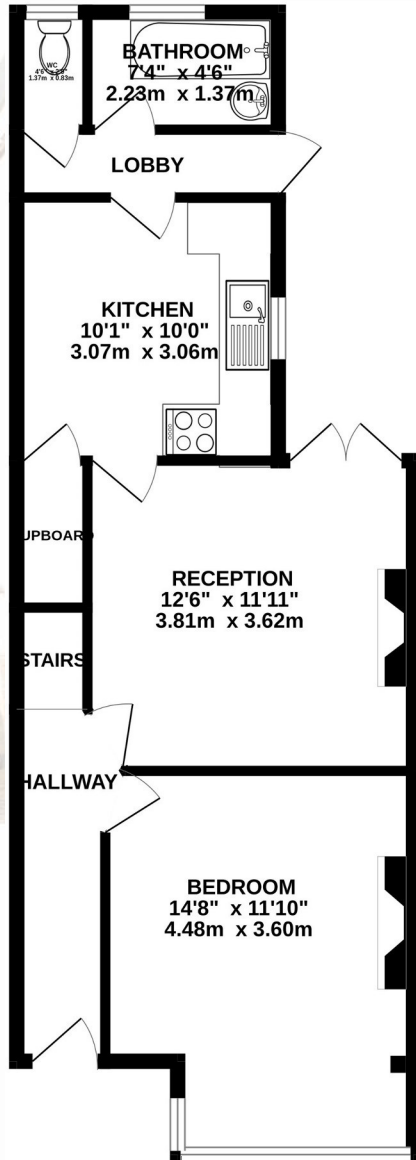

FIRST FLOOR



TOTAL APPROX. FLOOR AREA: 93.1 SQ.M. / 1002 SQ.FT.
(Gardens not shown)

Cross & Prior endeavour to maintain accurate depictions of properties in Floor Plans and descriptions, however, these are intended only as a guide and purchasers must satisfy themselves by personal inspection.

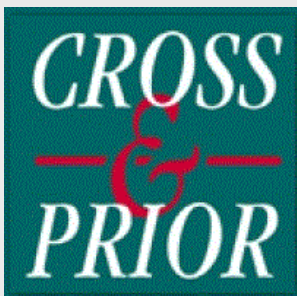

Established Since 1910

CONTACT

103 High Street, Colliers Wood,
London SW19 2JF

enquiries@crossprior.co
www.crossprior.co.uk

0208 715 0555

VIEWING ARRANGEMENTS

Strictly by appointment with
Cross & Prior

