

FOR SALE

OIEO £375,000

Sellindge Close, Beckenham, BR3



An immaculately presented three bedroom apartment, situated within easy reach of both New Beckenham and Beckenham Junction train stations. Offered to the market chain free and with excellent storage and communal garden.

A fantastic opportunity for any first time buyer or investor to own this chain free purpose built apartment, located just off the popular Copers Cope Road.

The property comprises of three bedrooms, modern bathroom, a fully integrated separate kitchen, and large reception room with hardwood flooring throughout. The property also benefits from a long lease, good storage within the apartment and an additional large storage cupboard before entering the communal garden.

The property gives easy access to Beckenham High Street with its array of shops, bars and restaurants, as well as many green spaces nearby, including Beckenham Place Park.

- Chain free
- Long lease
- Three bedrooms
- Modern integrated kitchen
- Excellent storage
- Communal garden
- Close to New Beckenham & Beckenham J BR
- EPC rating D





Sellindge Close, Beckenham, BR3

Approximate Area = 786 sq ft / 73 sq m

For identification only - Not to scale

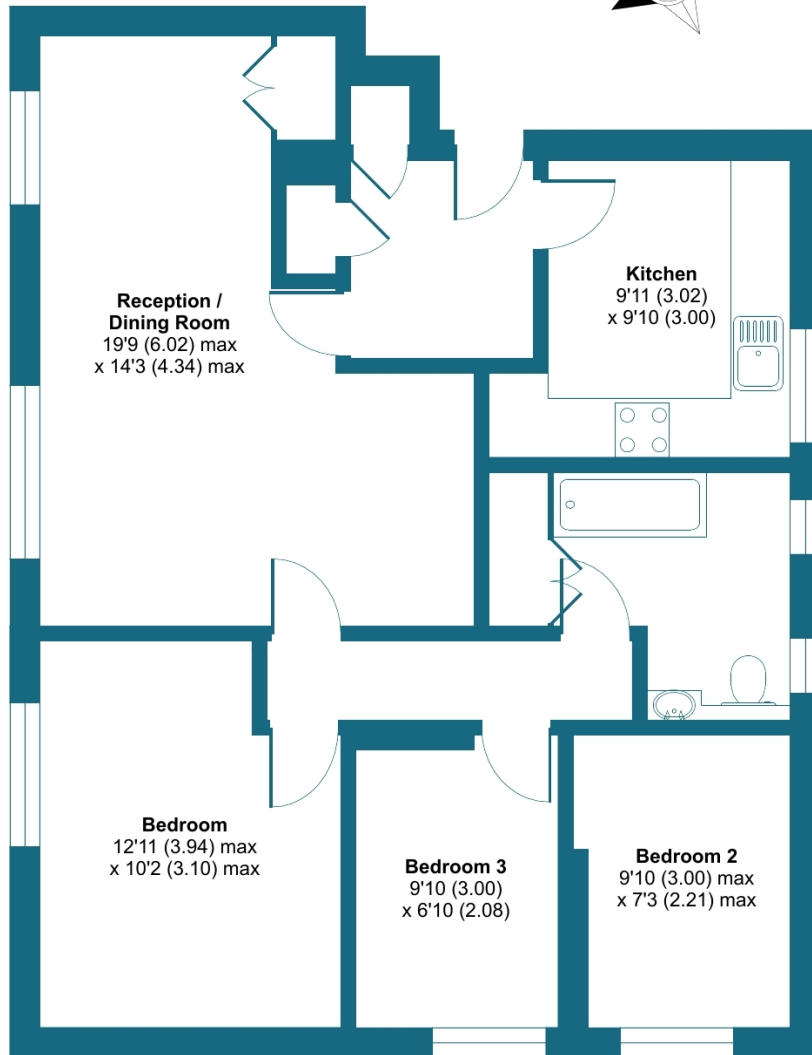

SECOND FLOOR



Floor plan produced in accordance with RICS Property Measurement Standards incorporating International Property Measurement Standards (IPMS2 Residential). © nchecon 2024. Produced for Grafton Estate Agents. REF: 1182684

