

TO LET  
£1,000 pcm



## DESCRIPTION

An amazing first floor Grade II listed Duplex apartment situated in the heart of Newbury town centre with lovely views of the church within walking distance of the railway station.

**DON'T MISS OUT ON THIS GRAND OPPORTUNITY TO RENT THIS AMAZING APARTMENT- AVAILABLE IMMEDIATELY.**

The property has been fully refurbished to a very high standard in a contemporary style retaining some original features including wall and ceiling timbers. The accommodation comprises communal entrance with security intercom system reception hallway with storage cupboard and bin store, solid oak balustrade and turned stair case leading to the first floor. Hallway with utility cupboard and washing machine, kitchen fitted with a range of top quality cabinets with with ample worksurface with built-in single oven, ceramic hob and extractor, lounge. On the first floor there is a bedroom and a shower room.

## FLOOR PLAN

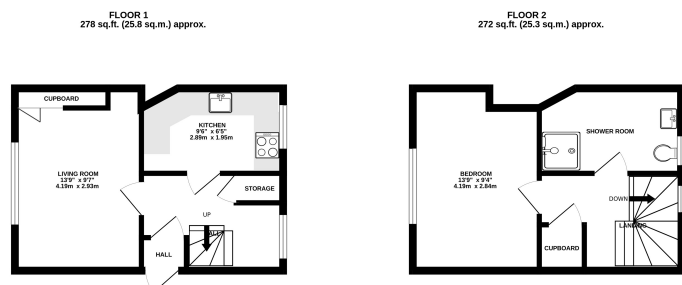

**TOTAL FLOOR AREA : 550 sq.ft. (51.1 sq.m.) approx.**  
While every attempt has been made to ensure the accuracy of the floorplan contained here, measurements of floors, walls, stairs and cupboards have an approximate nature and responsibility is taken for any errors or omissions. The plan is for illustrative purposes only and should be used as a guide only for any prospective purchaser. The services, systems and appliances shown have not been tested and no guarantee is to be taken regarding their efficiency or condition.

- Town centre location
- Recently refurbished
- Duplex apartment
- Gas fired central heating
- White good included
- Open plan living
- Features
- Available immediately

