



17 The Doultons Octavia Way, Staines-Upon-Thames, TW18 2QX

RARELY AVAILABLE TWO BEDROOM GROUND FLOOR RETIREMENT APARTMENT SITUATED IN THIS MUCH SOUGHT AFTER DEVELOPMENT IDEALLY LOCATED FOR EASY ACCESS TO STAINES TOWN CENTRE & LOCAL SHOPS. The property benefits from a spacious lounge/diner with patio doors, separate fitted kitchen, two well proportioned bedrooms and bathroom. Residents also enjoy access to a Communal lounge with Kitchen facilities and laundry room. No Onward Chain. Viewings Highly Recommended!

ROOM DESCRIPTIONS

Communal Entrance

With security-entry system. UPVC double glazed door leading to Apartment.

Entrance Hall

Light and power points, built-in storage cupboards, cupboard housing hot water tank.

Lounge

Front aspect UPVC double glazed sliding patio door, light and power points, TV point.



Kitchen

Side aspect UPVC double glazed window, range of fitted units at eye and base level, roll edged worktops, sink drainer unit, space for cooker, washing machine and fridge/freezer. Partly tiled walls.



Bedroom 1

Front aspect UPVC double glazed window, light and power points, built-in wardrobes.



Bedroom 2

Front aspect UPVC double glazed window, light and power points.



Bathroom

Panel enclosed bath with shower over, wash hand basin inset to cabinet, low level W.C, partly tiled walls, extractor, light point, heated towel rail.



ROOM DESCRIPTIONS

Communal Areas & Gardens

Communal Residents Room & Laundry

Residents enjoy access to a Communal lounge with Kitchen facilities and laundry room.



Communal Grounds

Well-kept communal gardens, residents parking bays.



FLOORPLAN

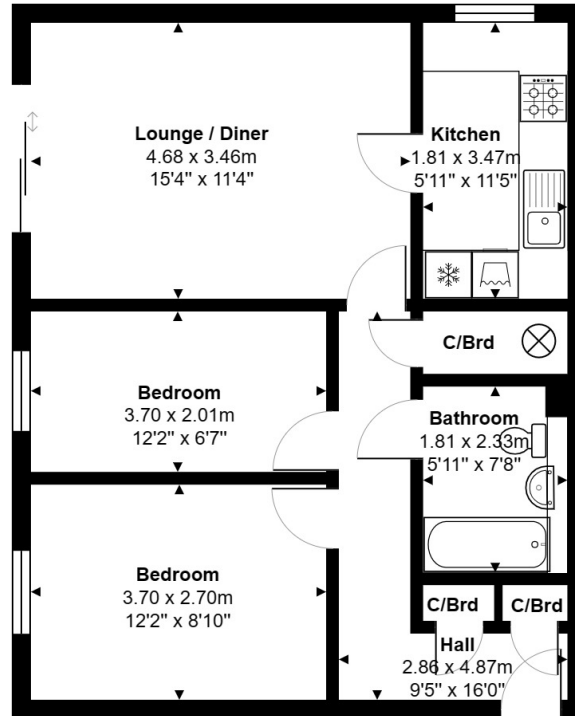

Ground Floor

Total Area: 57.1 m² ... 614 ft²

All measurements are approximate and for display purposes only.

127a, High Street, Staines-upon-Thames, TW18 4PD

01784 451458

staines@gregory-brown.co.uk