

Hollies Road, W5

Approximate Floor Area = 61.8 sq m / 665 sq ft

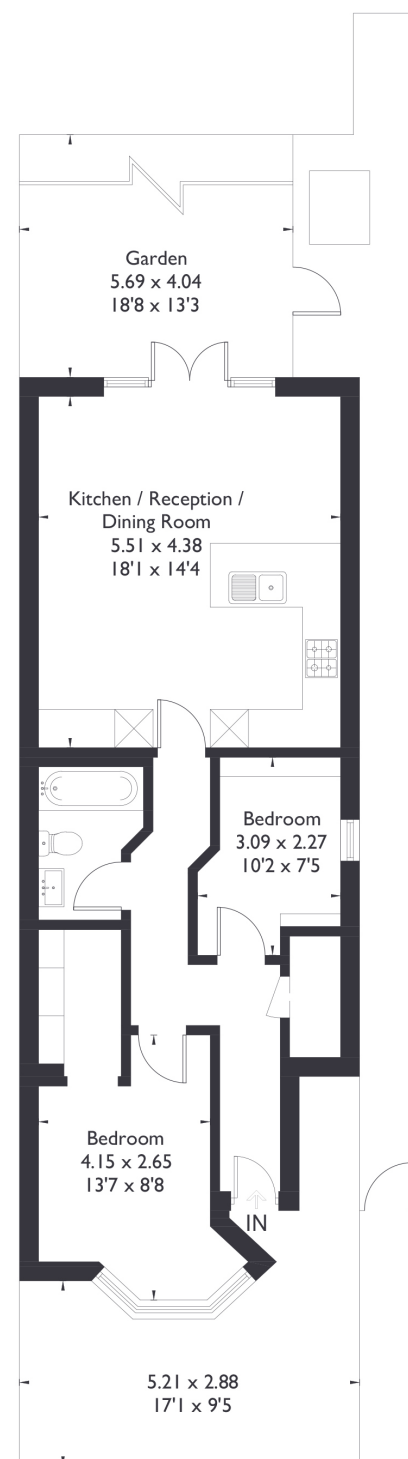

Ground Floor



2 BEDROOM FLAT

Hollies Road, W5

O.I.E.O £599,000

Welcome to this well-presented ground floor, two bedroom, one-bathroom flat.

As you enter, the larger bedroom is to your left and benefits from a spacious walk-in wardrobe. Straight ahead and to the right is the second bedroom, while a generously sized bathroom sits just beyond on the left.

FEATURES

- Two Bedrooms
- One Bathroom
- Open Plan Kitchen/Diner
- Private Garden
- Little Ealing & Ealing Fields School Catchment
- Northfields Station
- EPC Rating B



2 BEDROOM FLAT

Hollies Road, W5

The property features a bright and open plan kitchen and living area that flows directly out to a lovely private garden — ideal for both relaxing and entertaining.

Conveniently located just a 10-minute walk from Northfields Station and five minutes from a range of local amenities, this home also sits within the sought-after Ealing Fields and Little Ealing school catchments.

EPC Rating B.

