



**Marsh Lane  
Ince  
Chester  
Cheshire  
CH2 4NP**

**Offers in Excess of £111,000**

**bettermove**



# Marsh Lane Chester

Bettermove are delighted to present this charming one bedroom bungalow in Ince, available with no forward chain.

The property benefits from double glazing, gas central heating throughout and on street parking to the front with open planning permission to add a driveway for off road parking.

The interior of this well-presented property consists of a lounge with bow window, separate fitted kitchen, double bedroom and bathroom. The exterior boasts an enclosed rear garden with patio seating area, perfect for spending time during the summer months.

Situated in the sought after village of Ince, the property enjoys beautiful countryside views and excellent transport links from Ince & Elton and Stanlow & Thornton rail stations, as well as the M56 and M53. Many local amenities can be found nearby including supermarkets, shops, restaurants and pubs.

This exciting investment opportunity is not to be missed! All enquiries can be made through Bettermove on 0330 004 0050.



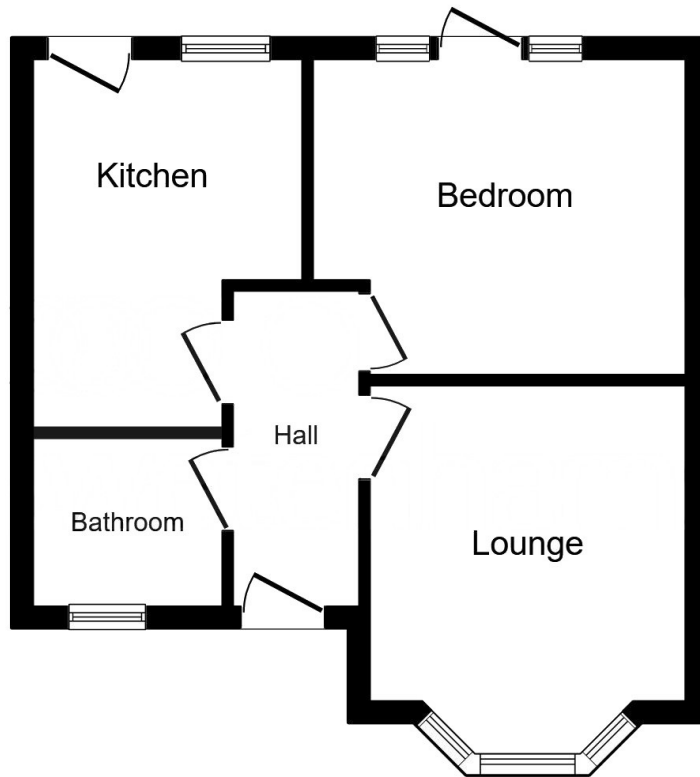

**Floor Plan**

This plan is for illustration purposes only and may not be representative of the property.  
Plan not to scale.

Powered by audioagent.com

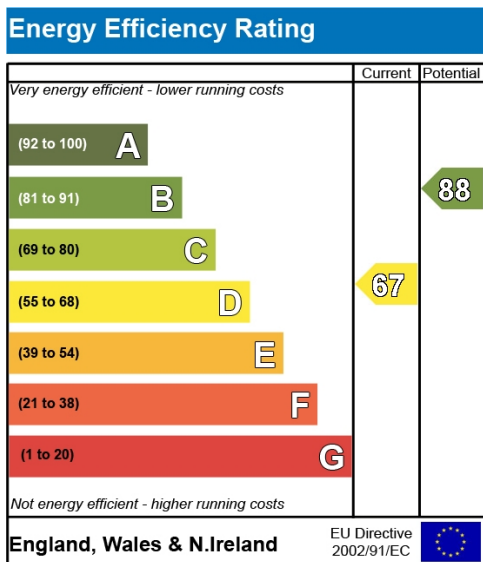





20-22 Bridge End, Leeds, LS1 4DJ  
t: 0330 004 0050 e: [hello@bettermove.co.uk](mailto:hello@bettermove.co.uk)  
[www.bettermove.co.uk](http://www.bettermove.co.uk)