



## Princess Road, Croydon, Surrey, CR0 2QS

£425,000 Freehold

- Stunning semi-detached property
- Victorian home
- Modern decor throughout
- Arranged over three floors
- Lovely features
- Impressive garden for entertaining

# Princess Road, Croydon, Surrey, CR0 2QS

£425,000 Freehold

\*\*\*Vendor comments\*\*\* "Welcome to a unique family home! Our stunning Victorian property on Princess Road has a ton of character, is arranged over three floors and has been our family home for the last 20 years. This has been a happy, safe and peaceful place, but now we are ready to move on and begin a new chapter. It's time for the house to become a home for a new family and for them to add to the memories it holds.

The house is close to transport links into London including East Croydon, West Croydon, Selhurst, Tramlink, Superloop buses and West Croydon Overground (Windrush). This makes access to London and beyond extremely convenient."

Fern Cottage

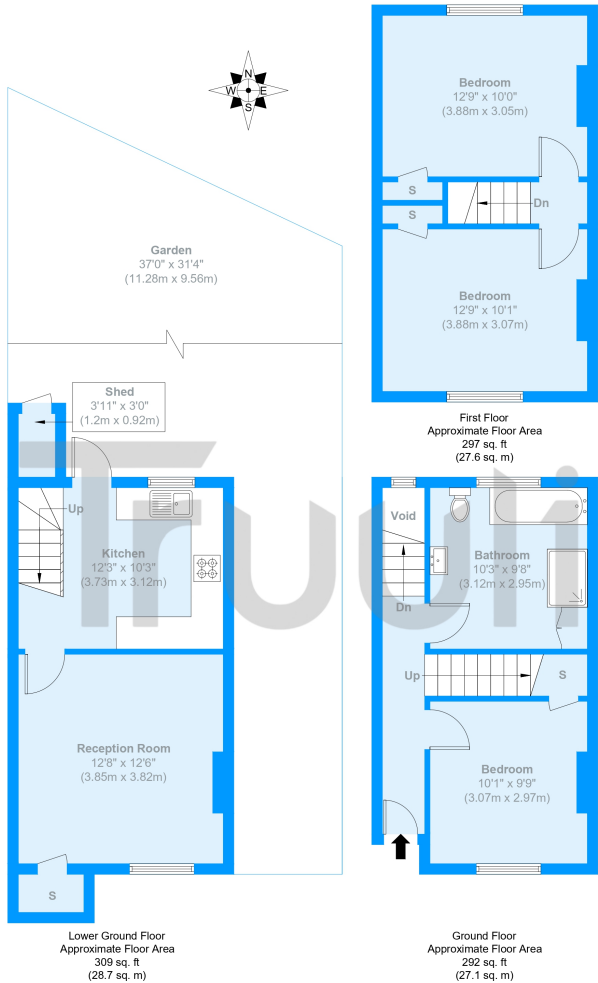

Approximate Gross Internal Area = 83.4 sq m / 898 sq ft

The Floor plan is not to scale and measurements and areas shown are approximate and therefore should be used for illustrative purposes only. The plan has been prepared in accordance with the RICS code of Measuring Practice and whilst we have confidence in the information produced it must not be relied on. Maximum lengths and widths are represented on the floor plan. If there is any aspect of particular importance, you should carry out or commission your own inspection of the property.

Copyright @ BleuPlan

