



Estate Agents and Solicitors

16 Chesser Gardens, Edinburgh, EH14 1SR

Immaculately Presented & Spacious, Three Bedroom, Upper Villa.

Up to date price and viewing info at mov8realestate.com/property

espc rightmove  Zoopla
find your happy

Property Description

Immaculately presented and spacious, three-bedroom, upper villa, with professionally landscaped gardens and a driveway. Located in the popular Chesser area, lying to the west of Edinburgh city centre.

Comprises an entrance hall and stairway, living room, kitchen, three flexible bedrooms, and a bathroom.

Finished to an exemplary standard, ready-to-move-in. Highlights include a stylish kitchen and bathroom, contemporary lighting, and a gas fireplace for the lounge with quality surround. In addition, there is gas central heating, double glazing (with a two-year warranty), and superb storage including bedroom wardrobes, and a loft.

Externally there is a driveway to the front, a lawn to the side, and a generous south-facing rear garden with a wood-decked patio, a lawn and two store sheds both with power.

The carpeted entrance stairway leads to the upper hall which provides access to each room on the first floor, except the kitchen. To the rear, the living room features carpeted flooring, a central light fitting, plain coving, a feature fireplace and access to the kitchen which is fitted with modern units, wood effect worktops, a matching upstand and a sink with drainer. Appliances include an integrated oven and gas hob, a fridge/freezer and a dishwasher.

To the front, two bedrooms are similarly well finished, both with integrated wardrobe space and featuring carpeted flooring. While bedroom two is set adjacent, featuring carpeted flooring, built-in wardrobes and ample space for freestanding bedroom furniture. Completing the accommodation, the bathroom is fitted with a modern two-piece suite, an electric shower over the bath, tiled flooring and tiled splash walls.

A 360 Virtual Tour is available online.

mov8 REAL ESTATE
Estate Agents and Solicitors

16 Chesser Gardens, Edinburgh, EH14 1SR
Approximate Gross Internal Area: (936 sq ft - 87 sq m.)

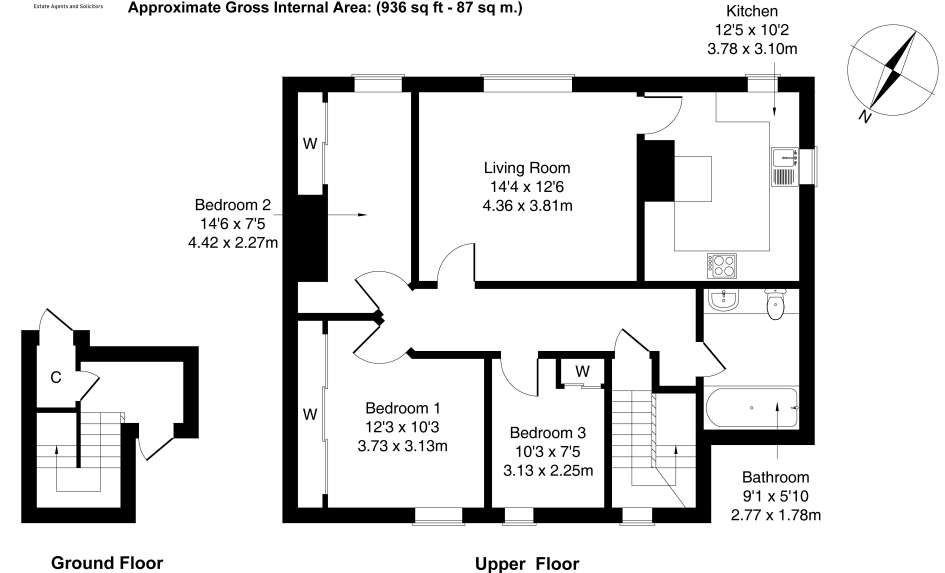

Area Description

Chesser is a popular residential area situated west of the city centre, and conveniently placed for a wide range of amenities, which include a great selection of local shops, banking and post office facilities, a 24-hour ASDA superstore and the new Edinburgh West Retail Park. Recreational facilities are well catered for by the nearby Edinburgh Corn Exchange, Fountain Park multi-complex, Nuffield Health Club.

Craiglockhart Sports Centre, and numerous golf courses. Excellent transport links are available locally, including regular bus services to and from the city centre, and a railway station at Slateford. Schooling is well represented in the area and Napier, Heriot-Watt and Edinburgh universities are all easily accessible.





Our Services

- Free pre-sale property valuations
- Great value fixed estate agency fees
- Extensive buyer matching database
- Purchase and sale conveyancing

Contact Us

0345 646 0208

sales@mov8realestate.com

www.mov8.com

Head Office

6 Redheughs Rigg, Edinburgh, EH12 9DQ

Glasgow Office

77 Renfrew Street, Glasgow, G2 3BZ



Estate Agents and Solicitors

