



Estate Agents and Solicitors

335 Bonnyton Drive, Eaglesham, Glasgow, East Renfrewshire, G76 0NH

Spacious, Three-Bedroom, Mid-Terrace House.

Up to date price and viewing info at [mov8realestate.com/property](https://www.mov8realestate.com/property)

espc rightmove  **Zoopla**
find your happy

Property Description

Beautifully-presented, three bedroom, mid-terrace house with private gardens, set off a quiet road in a residential development, the property is conveniently located in Eaglesham, lying to the south of Glasgow city centre.

Comprises a lounge, kitchen, three bedrooms and a bathroom.

Features include generous room sizes, gas central heating, uPVC double glazing, TV and telephone points.

Externally the property benefits from an easily maintained private rear garden, with paving and a brick built shed, a small garden to the front and ample on street parking.

A welcoming lounge gives access throughout the ground floor, featuring laminate flooring, a feature fireplace and a large window offering natural light.

Set to the rear, is the kitchen/dining area, including stone-effect worktops, wall tiling, sink with drainer, a washing machine, fridge/freezer and an integrated oven with gas hob.

On the first floor, bedroom one is set to the front with a built-in wardrobe, carpeted flooring and a fitted light fixture; whilst two further carpeted bedrooms complete the accommodation.

The bright family bathroom is fitted with a three-piece suite, stand alone shower and contemporary paneling and flooring.

mov⁸ REAL ESTATE
Estate Agents and Solicitors

335 Bonnyton Drive, Eaglesham, G76 0NH

Approximate Gross Internal Area: (840 sq ft - 78 sq m.)

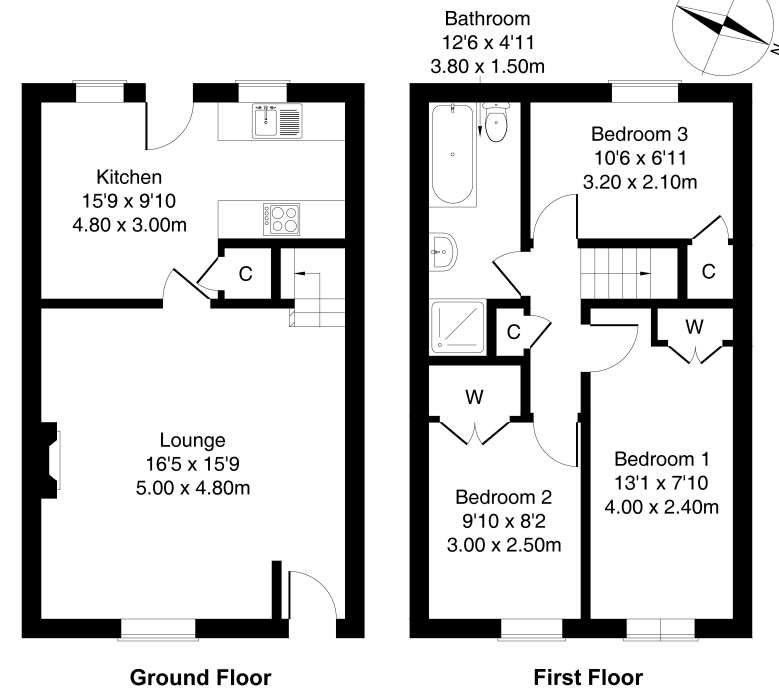

Legal Disclaimer : Floor-plan and measurements are for illustrative guidance only, and not intended to form part of any contract.

Area Description

Newtown Mearns, 7 miles southwest of Glasgow, is a growing and popular commuter suburb in East Renfrewshire. The M77 can be reached in under a minute, and lying on the main road to Ayrshire, the town has direct public transport links to Glasgow, Kilmarnock and Ayr. It is also served by two local rail stations at Patterton and Whitecraigs, for journeys further afield. All the expected

shopping, restaurants and facilities are available in the town centre, with The Avenue Shopping Centre providing high-street names. With numerous primary and secondary schools to choose from, the area also offers family activities with a wealth of outdoor parks, trails, and golf courses, including nearby Rouken Glen Park, Crookfur Park and the reservoirs along the Dams to Damley Trail.





Our Services

- Free pre-sale property valuations
- Great value fixed estate agency fees
- Extensive buyer matching database
- Purchase and sale conveyancing

Contact Us

0345 646 0208

sales@mov8realestate.com

www.mov8.com

Head Office

6 Redheughs Rigg, Edinburgh, EH12 9DQ

Glasgow Office

77 Renfrew Street, Glasgow, G2 3BZ



Estate Agents and Solicitors

