



Three Bedroom Terraced House
Ploughmans Way, Rainham, Gillingham, Kent, ME8 8LJ

Guide Price £240,000
Freehold

Ploughmans Way, Rainham, Gillingham, Kent, ME8 8LJ

Guide Price £240,000

Freehold

Description

Guide Price £240,000 - £260,000. Exciting Opportunity for First-Time Buyers or Project Enthusiasts!

Nestled in a fantastic Rainham location, this extended mid-terrace home is bursting with potential! Chain-free and ready for you to add your personal touch, this is the perfect opportunity to transform a house into your dream home.

Step inside to find a welcoming porch with handy storage, a spacious lounge, and a generous kitchen and dining area, ideal for entertaining or family meals. Upstairs, you'll discover three well-proportioned bedrooms and a family bathroom.

Outside, enjoy the benefits of a west-facing rear garden with rear access, a front garden, on-road parking, and even a garage en-bloc for extra convenience.

Properties like this don't stay on the market for long! Call the Greyfox Sales Team in Rainham to book your viewing today!

Key Features

- Chain Free
- Extended Mid Terraced Family Home
- Popular Rainham Location, Close to Shops, Schools & Amenities
- Great Access To Motorway Links , Public Transport & Rainham Train Station
- West Facing Rear Garden Measuring Approx 17 x 12 ft
- Garage En-Bloc & On Road Parking
- Three Separate Bedrooms
- Spacious Kitchen & Dining Area

Local Area

Rainham in the Medway towns is located descending towards the banks of the river Medway, approximately 39 miles from London. The ancient Watling Street main road (A2) runs through the town with the M2 motorway on the southern edge with good links to the M25/M20. There are a good number of shops and facilities within the town, a mainline station and a selection of local schools including Rainham Mark Grammar School.

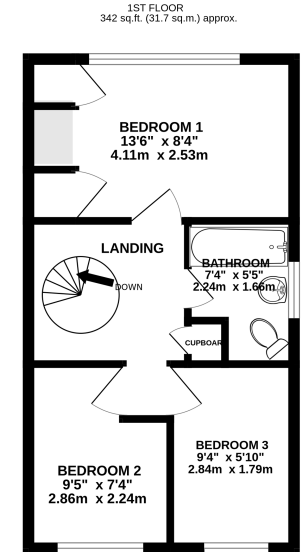
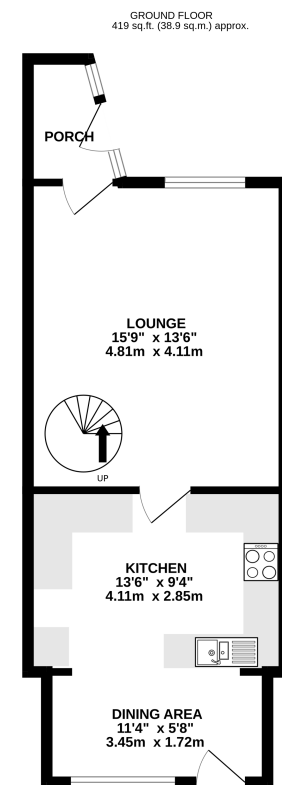

TOTAL FLOOR AREA: 761 sq.ft. (70.7 sq.m.) approx.
Whilst every attempt has been made to ensure the accuracy of the floorplan contained here, measurements of doors, windows, rooms and any other items are approximate and no responsibility is taken for any error, omission or mis-statement. This plan is for illustrative purposes only and should be used as such by any prospective purchaser. The services, systems and appliances shown have not been tested and no guarantee as to their operability or efficiency can be given.
Made with Metropix ©2025



Property Location

Ploughmans Way, Rainham, Gillingham, Kent, ME8 8LJ

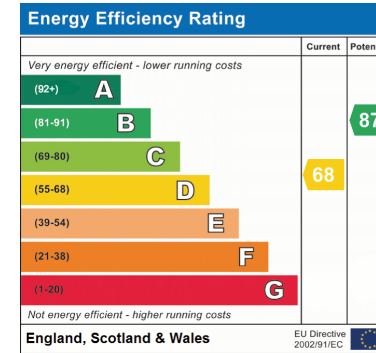
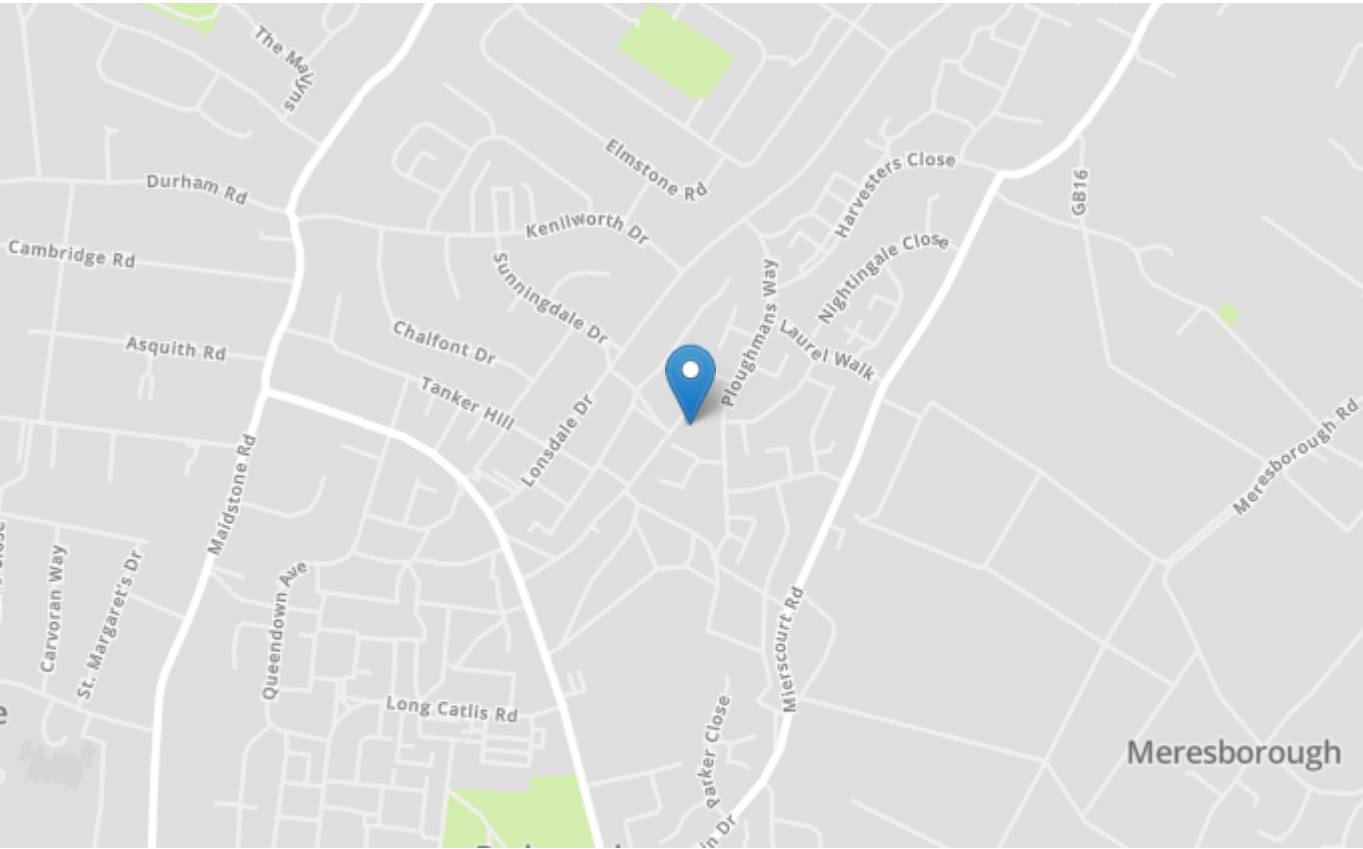

| | |
|------------------------|----------|
| Tenure | Freehold |
| Lease Term | N/A |
| Ground Rent | N/A |
| Service Charge | N/A |
| Local Authority | Medway |
| Council Tax | Band C |

Greyfox Walderslade

Unit 2, Thetford House
Walderslade Village Centre
Walderslade Road
Chatham
Kent
ME5 9LR
Tel: 01634 672227 Email:
walderslade@greyfox.co.uk

Greyfox Rainham

67C High Street
Rainham
Kent
ME8 7HS
Tel: 01634 377737 Email:
rainham@greyfox.co.uk

Agent Notes

These particulars are prepared as a general guide to a broad description of the property and should not be relied upon as a statement or representation of fact and do not constitute part of an offer or contract. The seller does not make or give nor do our employees or Greyfox have authority to make or give any representation or warranty to the property. We have not carried out a structural survey and the services, appliances and specific fittings have not been tested. All photographs, measurements, floorplans and distances referred to are given as a guide only and should not be relied upon for the purchase of carpets or any other fixtures or fittings. Lease details, service charges and ground rent (where applicable) and council tax are given as a guide only and should be checked and confirmed by you on inspection and your solicitor prior to exchange of contracts. If there are any points of particular importance to you we will be pleased to check the information for you and to confirm that the property remains available. This is particularly important should you be travelling some distance to view and where statements have been made by us to the effect that the information has not been verified. The copyright of all details, photographs and floorplans remain exclusive to Greyfox. For details of our privacy policy and referral fee arrangements with any of our selected partner companies please visit <https://www.greyfox.co.uk/legal/privacy> and <https://www.greyfox.co.uk/referral-fees>.