



**Four Bedroom Semi-Detached House**  
Green Top Court, Rainham, Gillingham, Kent, ME8 7EQ

**Guide Price £425,000**  
Freehold

## Green Top Court, Rainham, Gillingham, Kent, ME8 7EQ

Guide Price £425,000

Freehold

### Description

**\*\*Guide Price £425,000 - £450,000 \*\***

Located on the popular Berengrave Gardens development, this fabulous four bedroom family home is a must see! Offering ample living space with a generous lounge and a fully integrated kitchen/diner overlooking a beautifully landscaped east facing garden, which is ideal for entertaining. On the first floor there are four great sized double bedrooms, all with built in wardrobes and the main bedroom also benefits from a spacious ensuite. This property will not be available for long, so please call Greyfox Sales and Lettings to book your viewing now!

### Key Features

- Semi Detached Family Home
- Fabulous Open Plan Kitchen/Diner
- Large Separate Living Room
- Four Good Sized Bedrooms
- Ensuite to master bedroom
- Downstairs Cloakroom
- Driveway for multiple vehicles
- East Facing Garden measuring approx 40ft x 27ft

### Local Area

Rainham in the Medway towns is located descending towards the banks of the river Medway, approximately 39 miles from London. The ancient Watling Street main road (A2) runs through the town with the M2 motorway on the southern edge with good links to the M25/M20. There are a good number of shops and facilities within the town, a mainline station and a selection of local schools including Rainham Mark Grammar School.

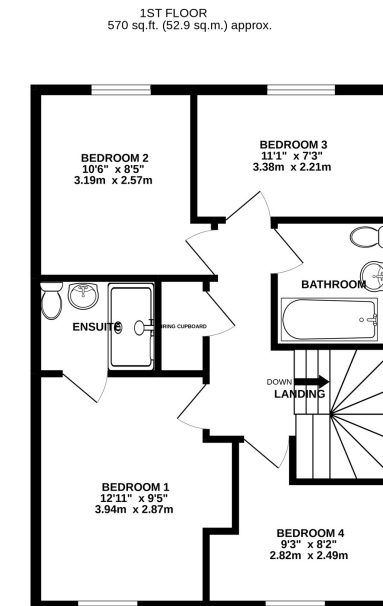
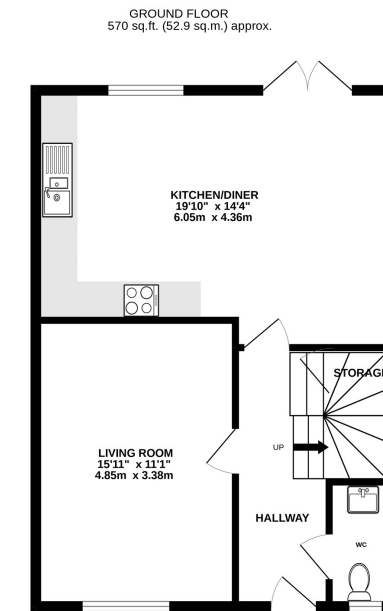

TOTAL FLOOR AREA : 1139 sq.ft. (105.8 sq.m.) approx.

Whilst every attempt has been made to ensure the accuracy of the floorplan contained here, measurements of doors, windows, rooms and any other items are approximate and no responsibility is taken for any error, omission or mis-statement. This plan is for illustrative purposes only and should be used as such by any prospective purchaser. The services, systems and appliances shown have not been tested and no guarantee as to their operability or efficiency can be given.  
Made with Metropix ©2022



## Property Location

Green Top Court, Rainham, Gillingham, Kent, ME8 7EQ

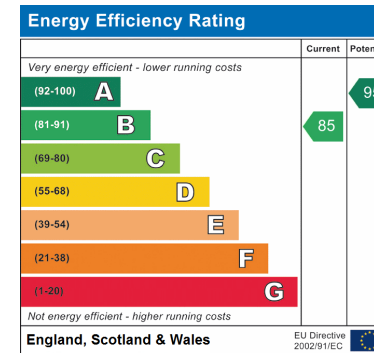
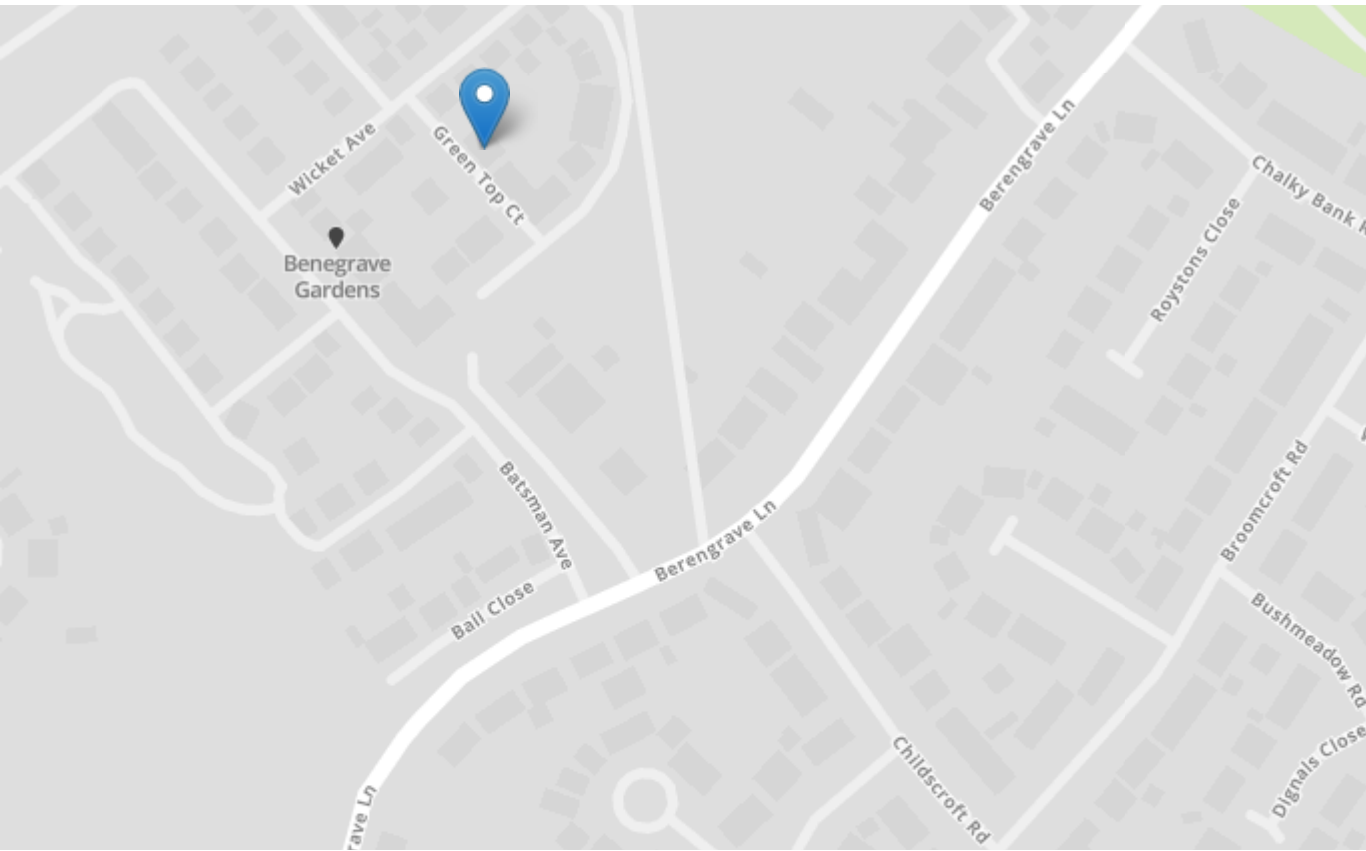

**Tenure**

Freehold

**Lease Term**

N/A

**Ground Rent**

£207.79 maintenance

**Service Charge**

charges 1.4.24-30.9.24

**Local Authority**

Medway

**Council Tax**

Band D

## Greyfox Walderslade

Unit 2, Thetford House  
Walderslade Village Centre  
Walderslade Road  
Chatham  
Kent  
ME5 9LR  
Tel: 01634 672227 Email:  
walderslade@greyfox.co.uk

## Greyfox Rainham

67C High Street  
Rainham  
Kent  
ME8 7HS  
Tel: 01634 377737 Email:  
rainham@greyfox.co.uk

### Agent Notes

These particulars are prepared as a general guide to a broad description of the property and should not be relied upon as a statement or representation of fact and do not constitute part of an offer or contract. The seller does not make or give nor do our employees or Greyfox have authority to make or give any representation or warranty to the property. We have not carried out a structural survey and the services, appliances and specific fittings have not been tested. All photographs, measurements, floorplans and distances referred to are given as a guide only and should not be relied upon for the purchase of carpets or any other fixtures or fittings. Lease details, service charges and ground rent (where applicable) and council tax are given as a guide only and should be checked and confirmed by you on inspection and your solicitor prior to exchange of contracts. If there are any points of particular importance to you we will be pleased to check the information for you and to confirm that the property remains available. This is particularly important should you be travelling some distance to view and where statements have been made by us to the effect that the information has not been verified. The copyright of all details, photographs and floorplans remain exclusive to Greyfox. For details of our privacy policy and referral fee arrangements with any of our selected partner companies please visit <https://www.greyfox.co.uk/legal/privacy> and <https://www.greyfox.co.uk/referral-fees>.