



6/12 Wardlaw Street, Edinburgh, EH11 1TS

Light and Neatly Presented, One-Bedroom, Second-Floor Flat

Up to date price and viewing info at mov8realestate.com/property

espc rightmove[®] Zoopla
find your happy

Property Description

Light and neatly presented, one-bedroom, second-floor flat, forming part of the traditional stone-built tenement. Conveniently located in the popular Gorgie area, west of Edinburgh city centre.

Comprises an entrance hall, a living/kitchen area, a double bedroom and a separate shower room.

Features include a stylish kitchen area, modern fitted shower room, gas central heating and double glazing. Externally, there are communal grounds to the rear, and on-street parking to the front and surrounding areas.

A welcoming entrance hall provides access to all rooms throughout the property. The open-plan living and kitchen area is well-presented and functional. The living space features carpeted flooring, a wall-mounted TV point, a window allowing in plenty of natural light, and a central ceiling light. The kitchen area is fitted with tiled-effect flooring, marble-effect worktops, a tiled splashback surround, and a stainless steel sink with drainer. Integrated appliances include an oven and a gas hob with a canopy extractor above.

The spacious bedroom benefits from carpeted flooring and a built-in storage cupboard. There is ample room for a double bed along with additional furnishings such as a wardrobe, bedside tables, or a chest of drawers, making it a comfortable and practical sleeping space. Completing the property is a modern fitted shower room, which includes tiled flooring, a tiled splashback surround, recessed spotlighting, and a ladder-style radiator.



6/12 Wardlaw Street, Edinburgh, EH11 1TS

Approximate Gross Internal Area: (388 sq ft - 36 sq m.)

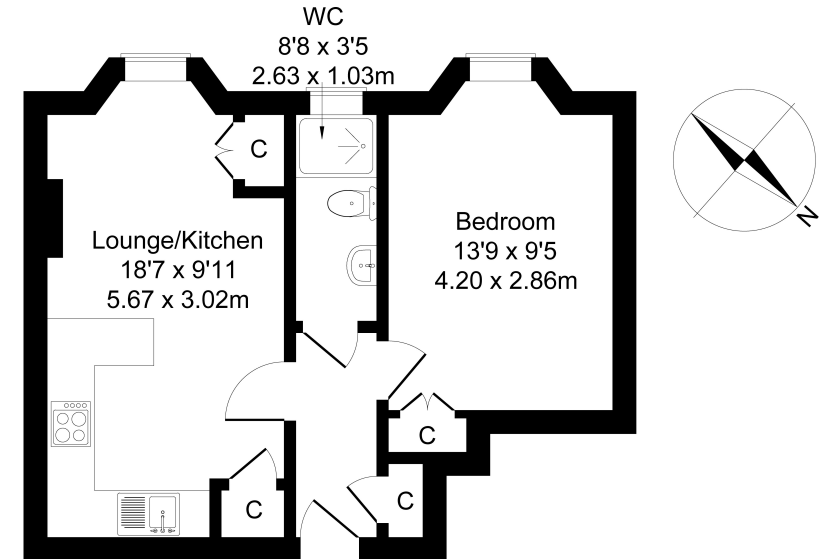

Legal Disclaimer : Floor-plan and measurements are for illustrative guidance only, and not intended to form part of any contract.

Area Description

Gorgie is a popular and historic district just west of Edinburgh city centre, known for its traditional stone-built tenements. The vibrant Gorgie Road offers extensive local amenities, including a Sainsbury's and Aldi, with a 24-hour ASDA superstore located nearby at Chesser. The area is home to Heart of Midlothian Football Club and offers a variety of leisure facilities such as Gorgie

Farm, Dalry Swimming Pool, Craiglockhart Sports Centre, and Fountain Park, which features a multi-screen cinema, fitness centre, and several restaurants. Frequent bus services run along Gorgie Road, and Haymarket Station, as well as Napier and Heriot-Watt universities and Edinburgh College, are all easily accessible.





Our Services

-  Free pre-sale property valuations
-  Great value fixed estate agency fees
-  Extensive buyer matching database
-  Purchase and sale conveyancing

Contact Us

0345 646 0208

sales@mov8realestate.com

www.mov8.com

Head Office

6 Redheughs Rigg, Edinburgh, EH12 9DQ

Glasgow Office

77 Renfrew Street, Glasgow, G2 3BZ



Estate Agents and Solicitors



These particulars do not form part of any contract and the statements or plans contained herein are not warranted nor are they to scale. All descriptions, dimensions, areas, reference to condition and necessary permissions for use and occupation and other details are given in good faith, and are believed to be correct, but any prospective purchaser should not rely on them as statements or representations of fact, and any prospective purchaser must satisfy themselves by inspection or otherwise as to the correctness of each of them. The Seller shall not be bound to accept the highest or any offer nor to accept a full offer of the Fixed Price where this is applicable. Approximate measurements have been taken by sonic device and measurements are most often taken to the widest point of any room or space. Services and appliances have not been tested for efficiency or safety and no warranty is given as to their compliance with any Regulations. Offers should be made using the Combined Standard Clauses.