



philip INDEPENDENT
ESTATE AGENT
Jarvis

Mount Castle Cottage Mount Castle Lane, Lenham Heath, Kent. ME17 2JE.

£1,100,000 Freehold



Property Summary

"This property offers fantastic space and flexibility for different family dynamics. The scope being offered here, with the annexe, barn and paddock must be viewed to be fully appreciated". - Sam Newman, Senior Sales Negotiator.

We are delighted to bring to the market Mount Castle Cottage in rural Lenham Heath. The property is accessed at the end of Mount Castle Lane within a farm complex.

The main family accommodation is an 18th century four bedroom detached cottage with a wealth of character features throughout. The ground floor is arranged to include an inner hall with access to both reception areas currently configured as a lounge with large brick feature fireplace and a dining room/sitting area with its own log burner.

To the rear of the property is a well appointed cottage style gallery kitchen and utility area which has a lovely aspect over the garden.

To the first floor there are two large double bedrooms. The larger of the two bedrooms presents a brick feature wall and gorgeous fireplace. There are two further bedrooms with bedroom three also containing a walk in shower. The main bathroom features a most stunning free standing roll top bath.

Accessed via either the kitchen of the cottage or its own entrance door, is the two bedroom annexe which will certainly appeal to those looking for multi-generational living. The annexe has its own oil central heating system, meaning it could also offer a rental potential.

The annexe consists of a utility entrance area, open plan living room and kitchen, There are two bedrooms and a family bathroom. The annexe also boasts its own self contained garden.

Outside the mature gardens are beautifully maintained. There is a two bay kennel with power and light. A large timber workshop with power and a most useful home office log cabin, with its own kitchenette and telephone points.

In addition, to the above offering, there are two separate paddocks and a large barn currently used for storage. The overall plot measures just over three acres.

The large barn has recently been granted prior approval for a conversion into a detached four bedroom dwelling.

Well positioned both Lenham and Charing are only a short drive away. Both offer a range of amenities to include shops, railway stations and schools. The M20 is accessed at junction eight, approximately twelve miles away.



Features

- Four Bedroom Detached Cottage
- Two Paddocks
- No Onward Chain
- Separate Log Cabin Home Office
- Flexible Living Accommodation
- Council Tax Band F
- Two Bedroom Self-Contained Annexe
- Overall Plot of Just Over Three Acres
- Planning Permission For Four Bedroom Barn Conversion
- Well Presented Throughout
- EPC Rating: TBC

Ground Floor

Front Door To

Inner Lobby

Tiled floor.

Lounge

12' 9" x 12' 3" (3.89m x 3.73m) Double glazed window to front and side. Brick feature fireplace. Radiator. Wall lights. Fitted carpet. TV & BT point.

Dining Room/Family Room

18' 8" x 14' 3" this is measurement for both the dining room and family area combined (5.69m x 4.34m) Double glazed window to front and side. Log burner. Wall lights. Recess lighting. Two radiators. Fitted carpet. Tiled floor. Door to cellar.

Kitchen

15' 1" x 8' 1" (4.60m x 2.46m) Double glazed window to rear. Radiator. Range of modern cottage style base and wall units with wooden worktops. Butler sink. Cold water tap and water softer. Electric oven and induction hob. Splash back. Space for dishwasher and fridge/freezer. Tiled flooring. Localised tiling. Door to annexe.

Utility Area

Double glazed window to rear. Stable door into garden.. Storage cupboard housing oil boiler and electric consumer unit. Space for washing machine and tumble dryer. Tiled floor. Radiator. Doors into dining room.

First Floor

Landing

Feature stainless window to front. Access to loft. Storage cupboard housing water cylinder. Fitted carpet.

Bedroom One

13' 2" x 12' 4" (4.01m x 3.76m) Double glazed window to front. Radiator. Feature fireplace. Recess lighting. Fitted carpet.

Bedroom Two

10' 11" x 10' 10" (3.33m x 3.30m) Double glazed window to front. Radiator. Fitted carpet.

Bedroom Three

15' 8" x 5' 11" (4.78m x 1.80m) Double glazed window to rear and side. Radiator. Shower unit with Aqualisa mixer. Localised tiling to shower area. Vinyl flooring. Restricted head height.

Bedroom Four

12' 4" x 4' 11" (3.76m x 1.50m) Double glazed window to rear. Radiator. Fitted carpet. Restricted head height.

Bathroom

Double glazed window to side. Heated chrome towel rail. Suite comprising of modern WC, pedestal basin and freestanding bath with shower attachment. Wooden flooring. Three walls tiled floor to ceiling. Extractor.

Exterior

Kennels

Two bay kennels. Power and lighting.

Workshop

Power and lighting.

Log Cabin

Windows to front and side. Kitchenette area. Power and water. Vinyl flooring. BT point.

Barn

Power and lighting. Large open space. Three lock up kennels. Door to side. Electric roller room for access to front. Barn offers secure parking.

Paddocks

Two paddocks both fenced and gated. Separate to one another.

Garden

Mature garden with a mix of plants, shrubs, hedges and trees. Feature pond. Patio area and decking area. Outside lighting. Outside water taps. External power points.

Parking

Ample parking for numerous vehicles.

Annexe

Stable Front Door To

Utlity Area

Double glazed window to both sides. Space for fridge/freezer. Plumbing for washing machine. Recess lighting. Tiled floor.

Living Area

18' 8" x 15' 5" this is measurement for both kitchen and living room combined (5.69m x 4.70m) Double glazed window to rear and side. Radiator. Tv point. BT point. Recess lighting. Wood laminate flooring. Leads to

Kitchen Area

Double glazed window to side. Modern base and wall units with wood effect worktops. Stainless steel sink. Integrated microwave. Electric oven and hob. Extractor over. Recess lighting. Hive thermostat. Tiled flooring.

Bathroom

Double glazed window to side. Modern suite of low level WC, pedestal hand basin, 'L' shaped panelled bath with shower attachment. Floor to ceiling tiling. Tiled floor.

Bedroom One

12' 2" x 8' 8" (3.71m x 2.64m) Double glazed window to front and side. Radiator. Wall lighting. Storage space to side and above. Fitted carpet.

Bedroom Two

13' 2" x 8' 1" (4.01m x 2.46m) Double glazed window to front. Radiator. Fitted carpets. Consumer unit. Access door to main Cottage.

Agents Note

Full details for the barn conversion can be found on the Maidstone Borough Council planning portal Ref no: 24/501269/PNQCLA



1ST FLOOR

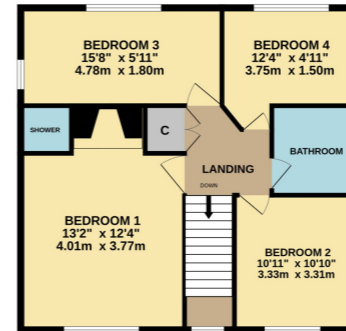

GROUND FLOOR



Viewing Strictly By Appointment With



Please Note: All dimensions are approximate and quoted for guidance only. Reference to appliances and/or services does not imply they are necessarily in working order or fit for purpose. interested parties are advised to obtain verification from their solicitors as to the freehold/leasehold status of the property, the position regarding any fixtures and fittings and where the property has been extended/converted as to Planning Approval and Building Regulations compliance. These particulars do not constitute or form part of an offer or contract, nor may they be regarded as representations. All interested parties must themselves verify their accuracy. Where a room layout or virtual tour included this is for the general guidance only, it is not to scale and its accuracy cannot be confirmed.

