

Jack Taggart & Co

RESIDENTIAL SALES

WINDSOR CLOSE, BN3 6WQ

£675,000

WINDSOR CLOSE, BN3 6WQ

Welcome to this truly exceptional three-bedroom mock Tudor family residence, nestled within a peaceful and highly sought-after cul-de-sac in the picturesque Goldstone Valley. Offering an abundance of light, space, and style throughout, this home is perfect for growing families in search of their forever home in one of Hove's most desirable locations.

From the moment you arrive, the home's striking curb appeal is evident. The mock Tudor architecture adds a charming and timeless quality, while the wide, modern block-paved driveway provides ample off-street parking. As you ascend the front steps and pass through the front door, you are greeted by a spacious and welcoming entrance hallway, flooded with natural light and offering a warm first impression.

To the front of the property lies the beautifully appointed living room. This elegant space features a large south-facing window that not only fills the room with sunlight but also offers captivating views across the rooftops of Goldstone Valley. Tastefully finished with wooden flooring and a stylish log burner, this room is the perfect place to relax and unwind, whether it's enjoying a quiet evening or entertaining guests.

The heart of the home is undoubtedly the stunning kitchen and dining area located at the rear of the property. The kitchen

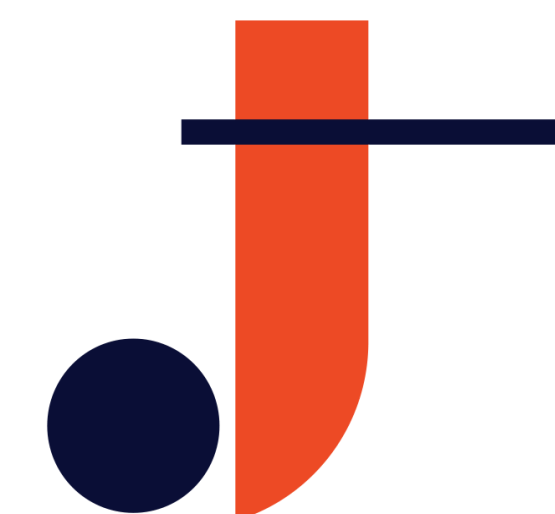
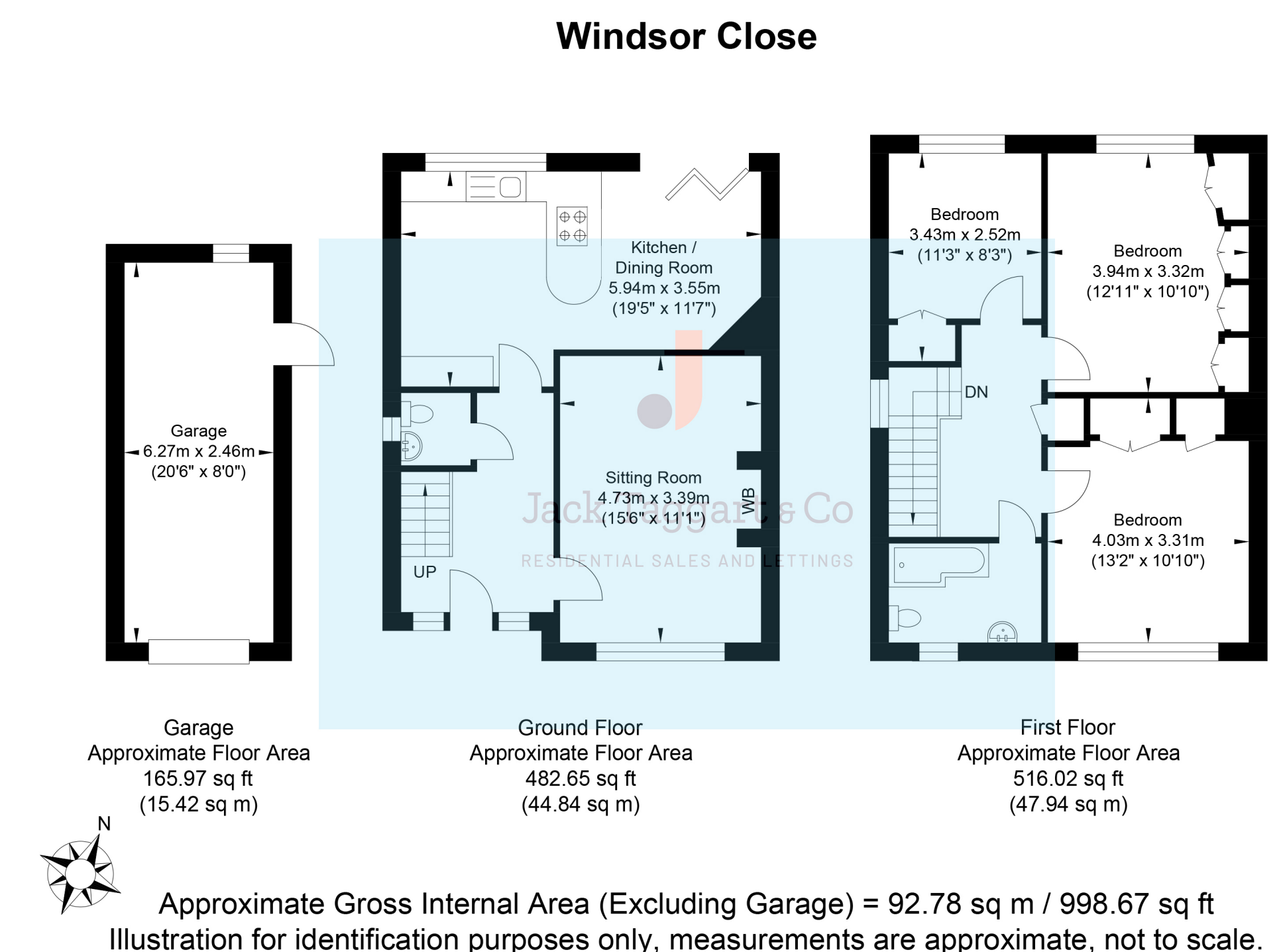

Jack Taggart & Co

RESIDENTIAL SALES

boasts a sleek, contemporary design with crisp white cabinetry, rich solid wood countertops, and a classic butler sink positioned beneath a window that overlooks the rear garden. Integrated appliances include a high-quality double Bosch oven, and a central breakfast bar provides a casual dining space while naturally dividing the room. The adjoining dining area is bright and spacious, enhanced by elegant bifold doors that open directly onto the garden—creating a wonderful indoor-outdoor flow that is ideal for summer gatherings and family meals alike.

A convenient and stylish downstairs WC is also located on the ground floor, providing added practicality for everyday family life.

Upstairs, the generous landing provides seamless access to all rooms on the first floor. Each of the three bedrooms are well-proportioned doubles, making them perfect for family living or flexible use as a home office or guest room. All bedrooms benefit from integrated storage and enjoy far-reaching views—either across the rolling hills of the South Downs or the charming rooftops of Goldstone Valley.

The family bathroom has been thoughtfully designed with modern luxury in mind. Fully tiled for a sleek and durable finish, it features a spacious wash hand basin with a contemporary LED mirror above, and a spa-style L-shaped whirlpool bath complete with an overhead rainfall shower, perfect for both quick morning routines and relaxing evening soaks.

Step out through the bifold doors into your own private garden oasis. The large L-shaped decking area is ideal for al fresco dining, entertaining, or simply enjoying the outdoors in peace and privacy. The Venetian-style fencing adds a sense of seclusion and style, while the expansive lawn provides space for children to play or for keen gardeners to further personalise. Raised flower beds along one side add colour and texture, and a useful shed is tucked away at the rear, offering ample storage for garden tools and equipment.

To the side of the property is a detached garage, providing additional storage or workshop space, and a side gate gives secure access back to the front of the house.

Situated in a quiet cul-de-sac yet conveniently located close to a wide range of amenities, this home enjoys the best of both worlds. Goldstone Valley is renowned for its family-friendly atmosphere, excellent schooling options, and proximity to beautiful green spaces. Hove Park, just a short walk away, offers open fields, sports facilities, and a café—perfect for weekend outings with family and pets.

There is easy access to local shops, transport links into Brighton and London, and popular schools, making this an ideal setting for families seeking quality of life without compromising on convenience.

With its blend of timeless character, contemporary finishes, generous living spaces, and unbeatable location, this beautifully

maintained family home truly stands out. Homes of this calibre in Goldstone Valley rarely come to market, and early viewing is highly recommended to fully appreciate everything this outstanding property has to offer.