

FOR SALE

£175,000

Flat 1 Queens Court, 65-67 Shrewsbury Road, Oxton, Wirral. CH43 6TE



Huge Lower Ground Floor Apartment! This modern self contained apartment is definitely larger than your average. The generous living space has direct access to the private rear decked patio area and the spacious master bedroom benefits from built in robes/storage and modern en-suite shower room. With designated parking, outside space, fresh decor and flooring throughout and the added benefit of No Onward Chain we highly recommend a view of this fantastic home to fully appreciate the space and quality on offer in this highly sought-after location!

Lower Ground Floor

Vestibule

Kitchen

14' 10" x 10' 10" (4.52m x 3.30m)

Lounge Diner

22' 10" x 14' 8" (6.96m x 4.47m)

Inner Hall

Bedroom

14' 10" x 12' 5" (4.52m x 3.78m)

En-Suite

8' 4" x 4' 3" (2.54m x 1.30m)

Bedroom

14' 11" x 14' 7" (4.55m x 4.45m)

Bathroom

7' 10" x 6' 8" (2.39m x 2.03m)





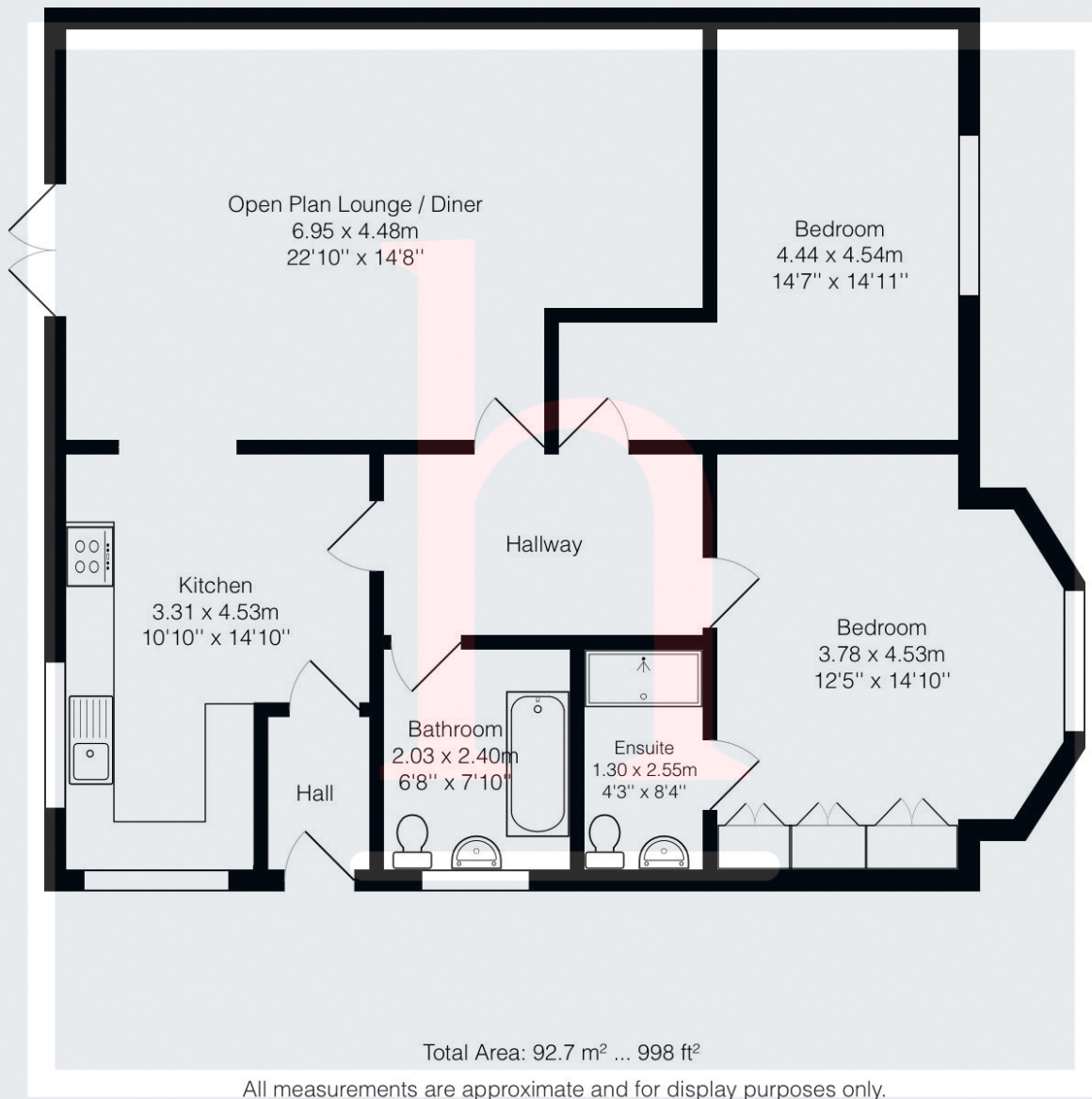

Energy Efficiency Rating		Current	Potential
Very energy efficient - lower running costs			
(92+)	A		
(81-91)	B		
(69-80)	C	73	79
(55-68)	D		
(39-54)	E		
(21-38)	F		
(1-20)	G		
Not energy efficient - higher running costs			
England, Scotland & Wales		EU Directive 2002/91/EC	