



NEWSON & BUCK
ESTATE AGENTS

3 Laurel Cottages
Ongar Hill Road
Terrington St Clement
King's Lynn
Norfolk
PE34 4JB

£249,995

Newson & Buck are delighted to present this exciting opportunity to acquire a three-bedroom semi-detached home offering scope for improvement and development (STPP), set on a generous plot of approximately 0.25 acres (STMS), with beautiful open field views. Located just two miles from the centre of Terrington St. Clement, this property offers the perfect blend of rural surroundings and village convenience. The accommodation comprises a spacious lounge/diner, kitchen, conservatory, ground floor bathroom, and three first-floor bedrooms. Occupying a sizeable plot with ample outside space, the property provides excellent potential for extension or redevelopment, subject to the necessary permissions. Additional benefits include off-road parking and oil-fired central heating and has had replacement UPVC windows mostly throughout. This is an ideal opportunity for buyers looking to modernise or create a home tailored to their own taste in a peaceful countryside setting. To arrange a viewing or for further information, please contact the sales team today.

- Three Bedroom Semi Detached House
- Rural & Picturesque Location
- 0.25 of an Acre Plot (STMS)
- Potential to extend and modernise
- Kitchen
- Conservatory/Utility Room
- Outbuildings
- Oil Central Heating & New Double Glazing



Lounge

17' 11" x 11' 11" (5.46m x 3.63m) Entrance door, carpeted, feature brick fireplace, storage, radiator, window to front and side

Kitchen

14' 11" x 8' 11" (4.55m x 2.72m) tiled flooring, window to rear aspect, range of base and wall cabinets, worktops, steel sink with mixer tap over, radiator, storage cupboard, space for fridge/freezer, space for under counter appliance, stairs to first floor

Rear Lobby

7' 02" x 4' 02" (2.18m x 1.27m) Tiled flooring, radiator, doors leading to

Bathroom

09' 04" max x 5' 10" (2.84m x 1.78m) Tiled floors and tiled walls, panelled bath, hand basin and shower cubicle with thermostatic shower, towel radiator window to side aspect

W/C

2' 08" x 5' 04" (0.81m x 1.63m) Low level flush w/c, tiled flooring, window to side

Conservatory/Utility

9' 06" x 7' 09" (2.90m x 2.36m) Range of base cabinets with space and plumbing for washing machine and tumble dryer, worktops, door leading to rear garden, tiled flooring, radiator

Landing

Carpeted, radiator

Bedroom One

15' 00" x 10' 08" (4.57m x 3.25m) Carpeted, radiator, built in wardrobes with sliding doors, storage cupboard, window to rear aspect, radiator

Bedroom Two

12' 04" x 10' 04" (3.76m x 3.15m) Carpeted, radiator, window to front aspect

Bedroom Three

9' 08" x 7' 06" (2.95m x 2.29m) Carpeted, radiator, window to side aspect, storage cupboard

External

The property has a shingle driveway leading to ample off road parking, the property sits on a 0.25 acre plot (STMS) with field views to the front and the rear. The private rear garden houses the oil tank and has a outbuilding providing four different rooms for storage.

Council Tax - A

EPC - E



GROUND FLOOR
537 sq.ft. (49.9 sq.m.) approx.

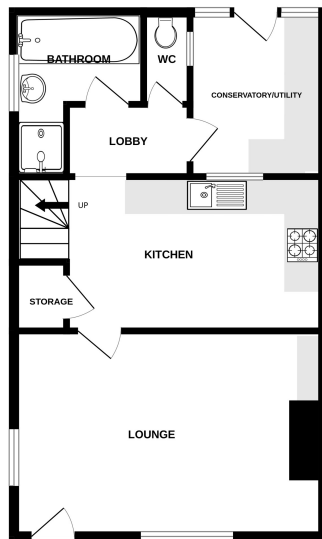

1ST FLOOR
366 sq.ft. (34.0 sq.m.) approx.

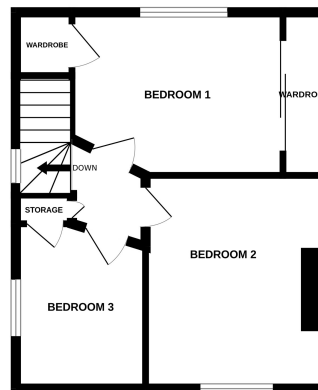

TOTAL FLOOR AREA : 903 sq.ft. (83.9 sq.m.) approx.

Whilst every attempt has been made to ensure the accuracy of the floorplan contained here, measurements of doors, windows, rooms and any other items are approximate and no responsibility is taken for any error, omission or mis-statement. This plan is for illustrative purposes only and should be used as such by any prospective purchaser. The services, systems and appliances shown have not been tested and no guarantee as to their operability or efficiency can be given.
Made with Neogis i2502.



18-20 King Street, King's Lynn, Norfolk, PE30 1ES

Tel: 01553 775151 Email: kingslynn@millsopps.com www.millsopps.com