



Fair Close, Bushey.
WD23 1FR



£549,950

Freehold

This surprisingly spacious 3 bedroom terraced house is situated in a quiet close on Bushey Heath, very close to the area's amenities and facilities. Some excellent schools are very close by, as are places of worship, shops, bus stops, motorway and rail links, and the local library.

The house has been appropriately priced to reflect that it requires some renovation but nevertheless it is absolutely ideal for first time purchasers or for those who are scaling down from a larger home.

Bushey Railway Station, with links to Euston (33 minutes), and Birmingham (1 hour 30 minutes), is only a short







- TERRACED HOUSE
- QUIET LOCATION

- THREE BEDROOMS
- CLOSE TO LOCAL FACILITIES

- GARAGE
- CLOSE TO SHOPS AND TRANSPORT

Fair Close, Bushey, WD23

Approximate Area = 1164 sq ft / 108.1 sq m
Garage = 170 sq ft / 15.8 sq m
Total = 1334 sq ft / 124 sq m
For identification only - Not to scale

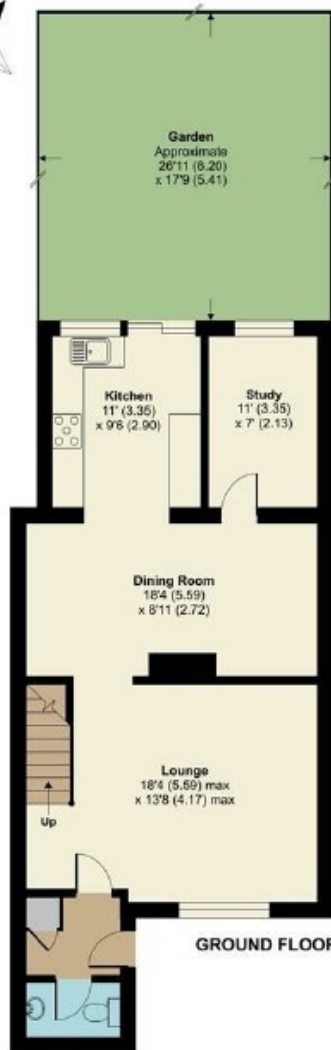

Edgware

02086 214 000

office@abcestates.co.uk