



Englesfield, CAMBERLEY, Surrey GU15 1RT

PRICE £600,000 Freehold

Jigsaw Estates are pleased to offer this link detached home in the rarely available Englesfield cul-de-sac of Heatherside. Accommodation comprises four double bedrooms, en-suite shower room to the principal bedroom and a family bathroom with a separate shower cubicle. Downstairs there is a large open plan feel to the living room which then flows into the dining room which overlooks the rear garden. The kitchen spans across the back of the house, overlooking the garden and has a door onto the patio.

The garden has a high degree of privacy, the wood panel fencing has been replaced and looks out onto the redwood trees. Further benefits include a cloakroom, longer than average garage, driveway and UPVC double glazing with bespoke wooden shutters.

In terms of location, there are various amenities including a Sainsburys local supermarket, takeaways, bus routes, a large recreation field and most importantly the schools which are Heather Ridge Infants, Ravenscote Juniors and Tomlinscote Secondary.



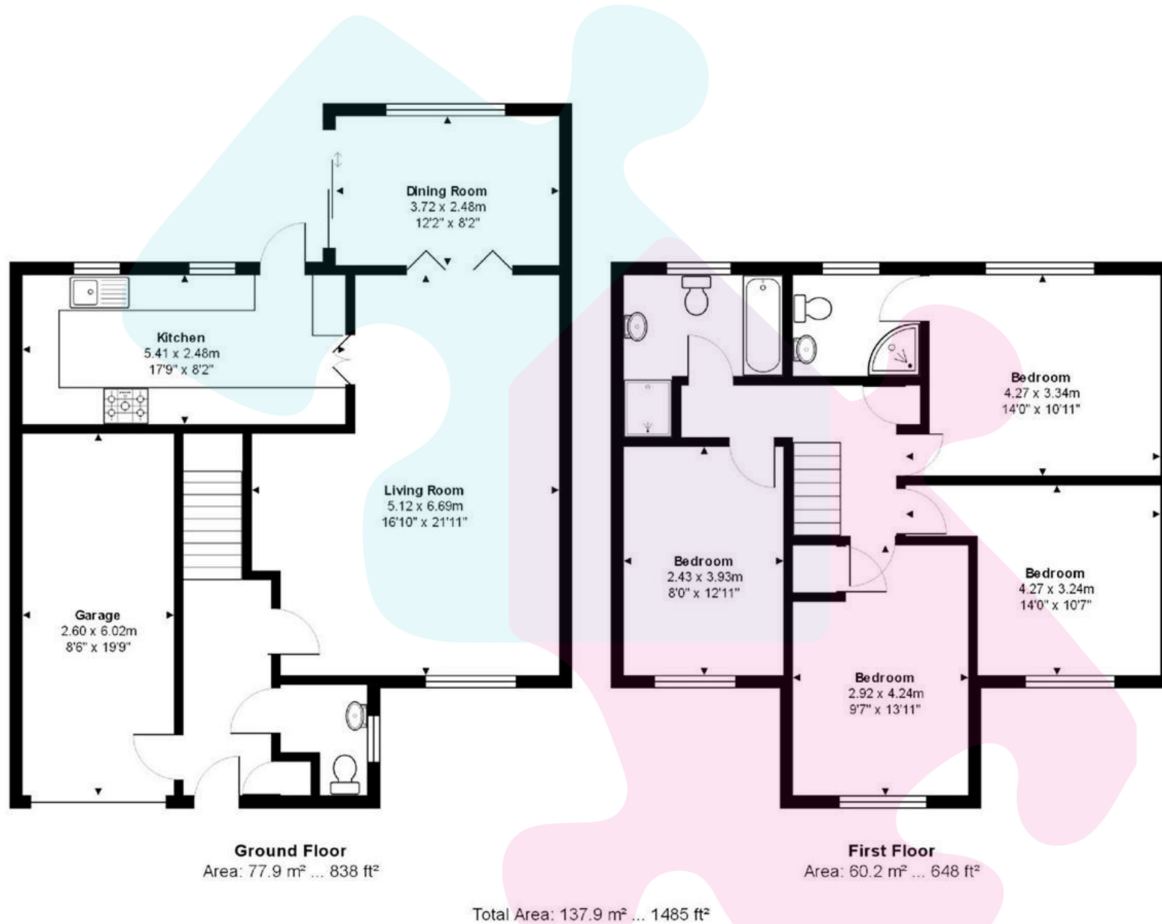

Whilst every attempt has been made to ensure the accuracy of the floor plan, measurements are approximate and no responsibility is taken for any error or mis-statement. The plan is for illustrative purposes only.

- VERY POPULAR CUL DE SAC ON THE HEATHERSIDE DEVELOPMENT
- FOUR DOUBLE BEDROOMS
- FAMILY BATHROOM WITH SEPARATE SHOWER CUBICLE
- DINING ROOM
- REAR GARDEN WITH NEW FENCING
- LINK DETACHED HOME
- EN-SUITE SHOWER ROOM
- LIVING ROOM
- KITCHEN
- GARAGE AND DRIVEWAY

Energy Efficiency Rating		Current	Potential
Very energy efficient - lower running costs			
(92+)	A		
(81-91)	B		84
(69-80)	C	70	
(55-68)	D		
(39-54)	E		
(21-38)	F		
(1-20)	G		
Not energy efficient - higher running costs			
England, Scotland & Wales		EU Directive 2002/91/EC	

