



Day & Co
ESTATE AGENTS

28 Cavendish Street
Keighley
BD21 3RG



36 Cliffe Terrace, Denholme,
Bradford, West Yorkshire, BD13
4BT

£179,995

T: 01535 664609

W: www.dayandcoestateagents.co.uk

E: keighley@dayandcoestateagents.co.uk

- VICTORIAN STONE TERRACE
- SPACIOUS ACCOMMODATION
- VIEWING ADVISED

- FOUR BEDROOMS
- WELL PRESENTED
- EPC RATING D

SUMMARY

** A WELL PRESENTED VICTORIAN STONE TERRACE HOUSE, FOUR BEDROOMS, OFFERS SPACIOUS FAMILY LIVING ACCOMMODATION, ENCLOSED REAR YARD, GAS CENTRAL HEATING, DOUBLE GLAZING, INTERNAL VIEWING ADVISED, EPC RATING D **

FULL DESCRIPTION

Day & Co are pleased to be marketing this spacious four bedroom, Victorian stone terrace situated in the popular village location of Denholme with excellent access to village amenities and views to the front. An internal viewing is recommended to fully appreciate the well presented accommodation that briefly comprises

Ground Floor - Entrance lobby, inviting Entrance Hallway with staircase, Living Room with bay window to the front elevation, open fire place, recess cupboards, period features. Spacious Dining Kitchen with a wood burning stove fire, feature stone floor, range of fitted wall and base units, worktops, sink, fridge/freezer, dishwasher, window to the rear. Utility with plumbing for washing machine, rear entrance door. Downstairs W.C with toilet, wash basin, window to the rear. Cellar.

First Floor - Landing, Three double bedrooms (The two front bedrooms enjoying views), House Bathroom which has a high ceiling comprising of a bath with shower over, w.c., wash basin, window to the rear.

Upper Floor - Large room with four roof windows this room has been stripped and allows a new buyer to put their own stamp on it.

Gas Central Heating & Double Glazing.

Outside Front garden with steps leading up to the property, sitting area. To the rear is an enclosed yard with deck area an raised bed.

EPC RATING D

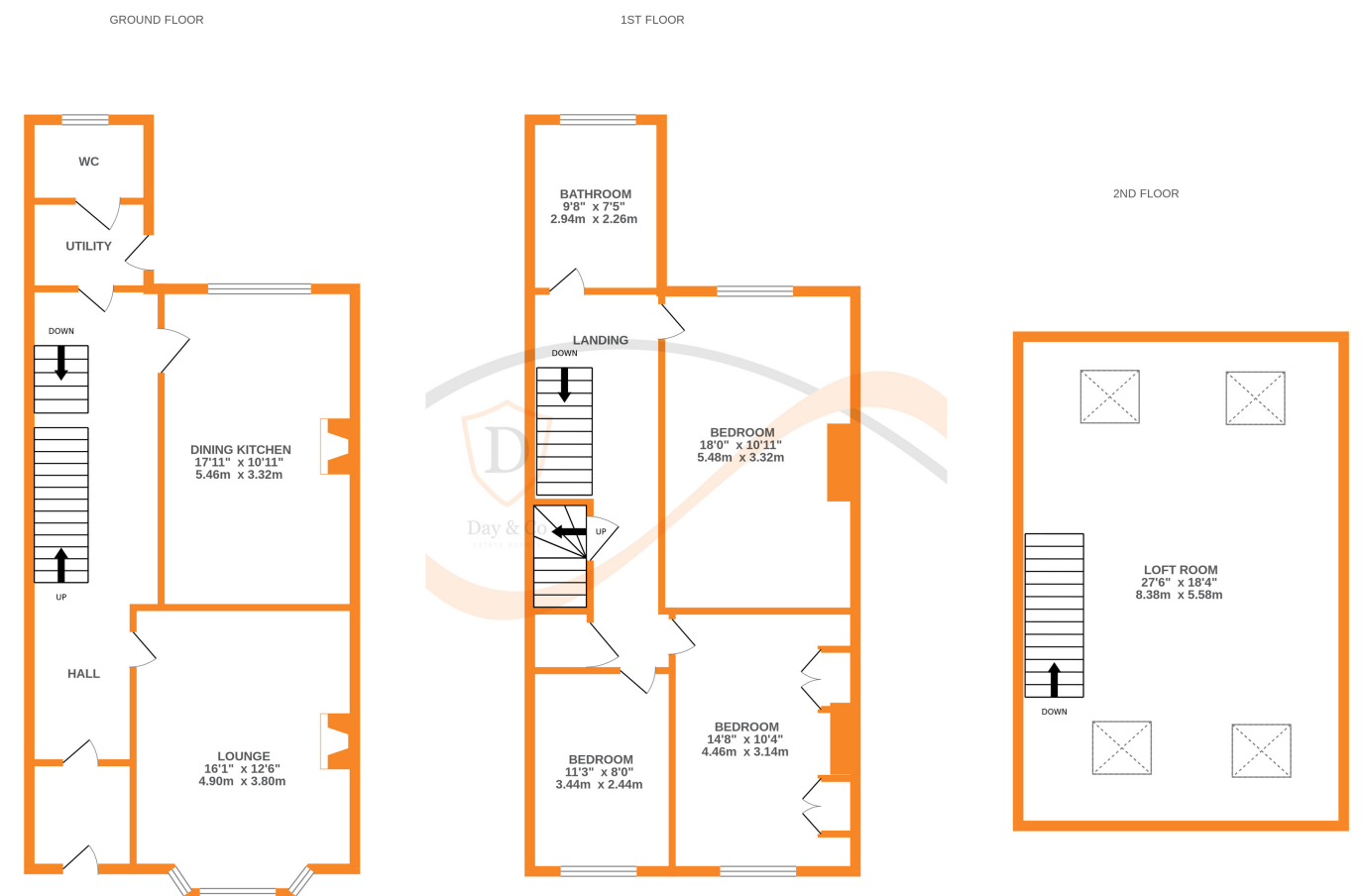

Whilst every attempt has been made to ensure the accuracy of the floorplan contained here, measurements of doors, windows, rooms and any other items are approximate and no responsibility is taken for any error, omission or mis-statement. This plan is for illustrative purposes only and should be used as such by any prospective purchaser. The services, systems and appliances shown have not been tested and no guarantee as to their operability or efficiency can be given.
Made with Metropix ©2024