

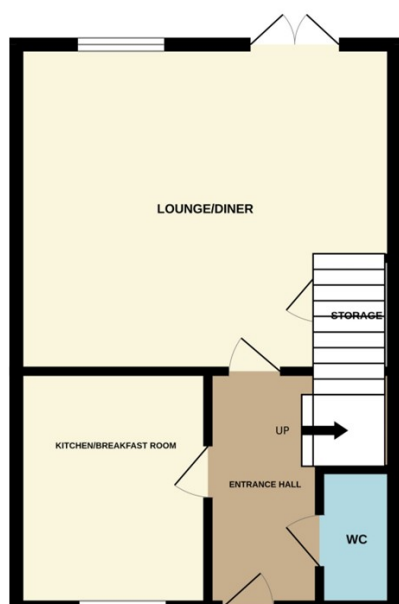

**Bourne**

**£215,000**



\*\*\* WELL PRESENTED THREE BEDROOM HOME \*\*\* Rosedale Property Agents are delighted to offer this lovely three bedroom semi detached home in the popular development of Elsea Park. The property is bright and spacious and decorated neutrally throughout. The accommodation offers an entrance hallway, downstairs cloakroom, kitchen breakfast room and an airy lounge diner with French doors into the rear garden. Upstairs are three bedrooms, Master ensuite and family bathroom. Outside offers a driveway adjacent to the property with off road parking for two vehicles and a good sized, fully enclosed rear garden. To fully appreciate this property viewings are highly recommended. Offers are invited in excess of £215,000. EPC Energy rating C / Council Tax band - B