

# Mews Cottage Glendevon, Dollar



Law Location Life



# Mews Cottage | Glendevon | Dollar

Built in the 1900's and set in tranquil countryside with spectacular views, Mews Cottage is a Detached Property requiring Full Renovation or Development.

Situated on a substantial plot of approximately 689sqm, the property offers huge potential to form a substantial family home with 132qm of potential floorspace.

The accommodation currently comprises; Ground Level Double Garages with Stable Doors, External Staircase, Kitchen, Sitting Room, 2 Bedrooms, Bathroom and External Unroofed Outbuilding.

Externally there are terraced gardens with breathtaking views and ample space for a large driveway or garage.

The sought after village of Glendevon offers excellent commuter links and is located only 6 miles from Gleneagles, with its Railway Station and famous hotel and golf course. Local towns of Auchterarder, Dollar and Kinross are all nearby, with excellent amenities, as well as private schooling at the renowned Dollar Academy.

Viewing is highly recommended and strictly by appointment only.





## Accommodation

### Kitchen

The property is accessed from the side via an external staircase. There are windows to the rear and side and door into the sitting room.

### Sitting Room

A good sized reception room with fireplace, window to the front and door to the hallway.

### Hallway

The hallway provides access to 2 bedrooms, bathroom and attic space. There is a skylight to the rear.

### Bedroom 1

A double bedroom with window to the front.

### Bedroom 2

A further double bedroom with window to the front.

### Bathroom

The bathroom has a bath, wc, pedestal wash hand basin and skylight to the front.

### Garages

Occupying the whole of the ground level are 2 garages with stable doors to the front.

### Outbuilding

There is a substantial unroofed outbuilding to the rear.

### Gardens

There are South facing terraced gardens to the rear.

### Driveway

There is a large driveway to the side.

### \*NOTE

The property requires full renovation, viewings are at your own risk.



GROUND FLOOR

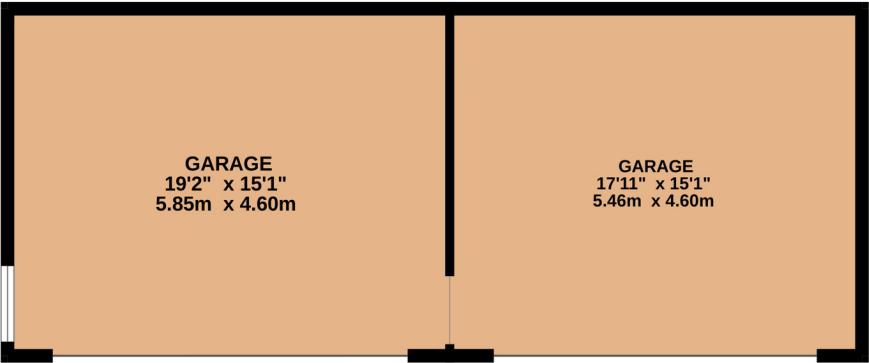

1ST FLOOR

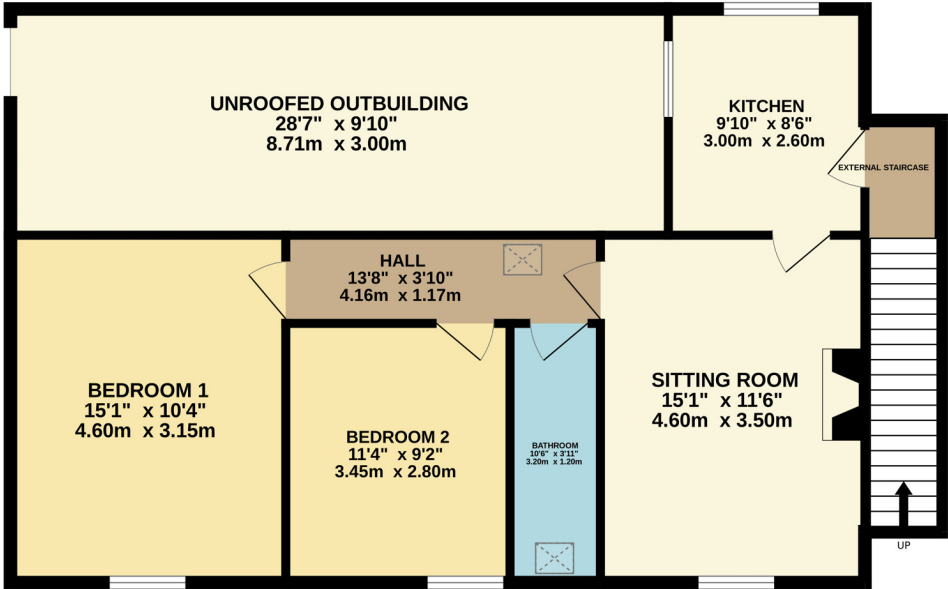

Whilst every attempt has been made to ensure the accuracy of the floorplan contained here, measurements of doors, windows, rooms and any other items are approximate and no responsibility is taken for any error, omission or mis-statement. This plan is for illustrative purposes only and should be used as such by any prospective purchaser. The services, systems and appliances shown have not been tested and no guarantee as to their operability or efficiency can be given.  
Made with Metropix ©2025









# DOLLAR - A BETTER PLACE TO LIVE

The picturesque village of Glendevon is situated only a short distance from Auchterarder, with its range of local amenities. The main road through the glen offers breathtaking views north to the famous Gleneagles Hotel and the mountains around Loch Earn. The nearby town of Dollar has further amenities, including private education with the renowned Dollar Academy. With excellent commuter links, including Gleneagles Train Station, Glendevon offers countryside living, with easy access to Central Scotland. Mews Cottage is situated a short walk from the Tormaukin Hotel, which is currently hosting a pop up cafe, shop and bar.

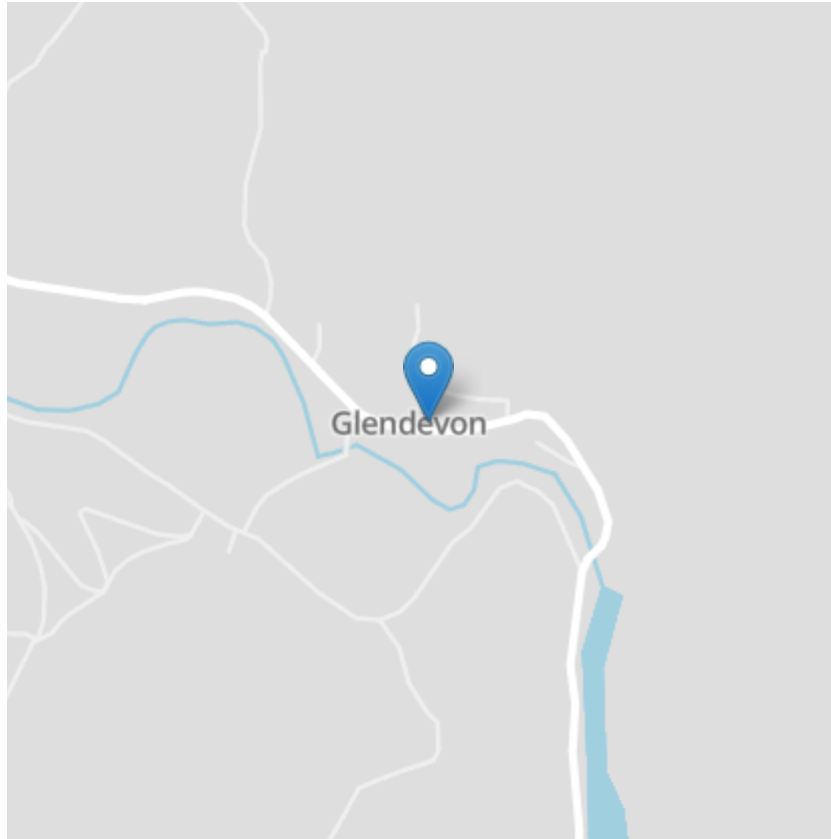

Andersons LLP  
40 High Street  
Kinross  
KY13 8AN

LP-2, Kinross

---

T: 01577 862405  
F: 01577 862829  
E: [property@andersons-kinross.co.uk](mailto:property@andersons-kinross.co.uk)  
[www.andersons-kinross.co.uk](http://www.andersons-kinross.co.uk)

---

## Partners

John Wellburn LL.B DIP L.P N.P  
Lorna E. Miller LL.B DIP L.P N.P

---

## Notes of Interest and Offers

All offers for this property should be submitted in Scottish legal terms to our Property Department. If you are interested in this property you are advised to "note interest" with Andersons via your solicitor.

---

Andersons LLP is a limited liability partnership (No. 300983) having their registered office at 40 High Street, Kinross KY13 8AN

