



2 The Rockery, Farnborough, Hampshire GU14 0RG

£625,000 Freehold

Jigsaw Estates Hampshire are pleased to present to the market, this detached family home, nestled in a quiet-spot within the Southwood development. The property is ideally situated with access a range of local amenities including; local schools, Morrisons supermarket, Nutfield Health & Fitness centre and local parks. Just a short drive away you also have; Farnborough airport, the mainline station to London and the town centre and also the M3 and A331 are very accessible. Accommodation comprises; fully fitted kitchen which opens up to a large family room, living room overlooking the rear garden, dining room, study, downstairs cloakroom and utility room which has direct access to the garage. Upstairs there are four generous bedrooms, an en-suite shower room and family bathroom. Outside to the rear is a secluded rear garden with a patio area accessed from either the family or living room. Mis-descriptions Act: We wish to inform prospective purchasers that we have not carried out a detailed survey or tested the services, appliances and specific fittings including any heating system for this property. Floorplans shown are for illustrative purposes only and are not drawn to scale.



- NO ONWARD CHAIN
- EN-SUITE SHOWER ROOM
- EXTENDED FAMILY DETACHED HOME
- GARAGE & DRIVEWAY
- FOUR BEDROOMS
- UTILITY & CLOAKROOM
- THREE RECEPTION ROOMS
- CLOSE PROXIMITY TO AMENITIES

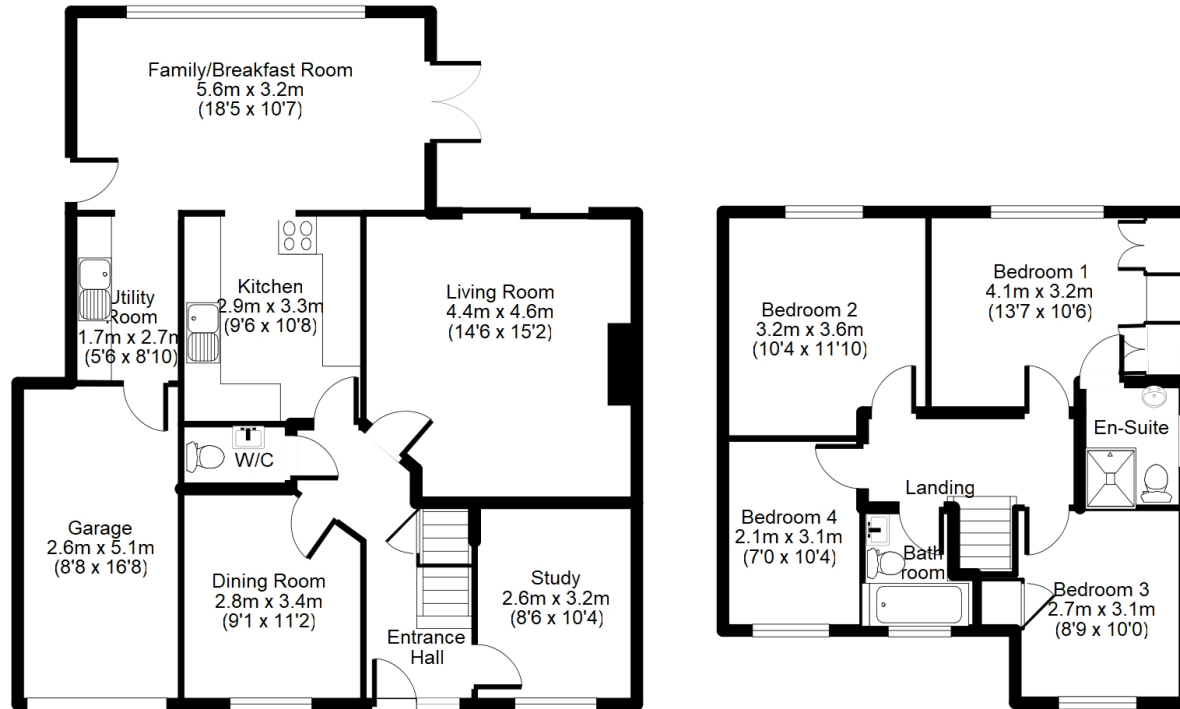

Approx. Total Floor Area:
148 Sq M = 1592 Sq Ft
(Includes Garage)

Floorplan is for illustration purposes only.
All measurements are approximate and should be verified.

