



Day & Co
ESTATE AGENTS

28 Cavendish Street
Keighley
BD21 3RG



6 Apsley Street, Oakworth,
Keighley, West Yorkshire, BD22
7EY

£239,995

T: 01535 664609

W: www.dayandcoestateagents.co.uk

E: keighley@dayandcoestateagents.co.uk

- EPC Rating Is C
- Three Bedrooms
- Conservatory
- Popular Village Location Of Oakworth/Excellent Access To Primary School

- Well Presented Detached Family Home
- Spacious Dining Kitchen
- Block Paved Driveway & Under House Garage

SUMMARY

****A SUPERBLY PRESENTED 3 BEDROOM DETACHED FAMILY HOME, POPULAR VILLAGE LOCATION OF OAKWORTH WITH EXCELLENT ACCESS TO THE PRIMARY SCHOOL!**** Having a spacious dining kitchen, conservatory, rear and side patio garden, block paved drive, under house garage - Viewing essential to fully appreciate!! EPC rating is C.

FULL DESCRIPTION

Of interest to a variety of buyers is this superbly presented three bedroom detached property situated in the ever popular village location of Oakworth with excellent access to the primary school. The well proportioned accommodation comprises of a spacious dining kitchen having a range of modern base and wall mounted units, integrated oven hob and extractor fan, plumbing for an automatic washing machine, two double glazed windows to the front and access to a useful cloaks WC. The lounge has an electric pebble effect fire, radiator, double glazed window to the rear. There is a conservatory with double glazed patio doors leading to the side garden. To the first floor there are three bedrooms, the bathroom having a spa bath with shower over and wash hand basin. A separate WC completes the internal accommodation. Externally there is a block paved drive leading to an under house garage with extensive under house storage. There are well maintained patio and garden areas to the rear and side of the property. Viewing essential to fully appreciate, EPC rating is C.

LOWER GROUND FLOOR

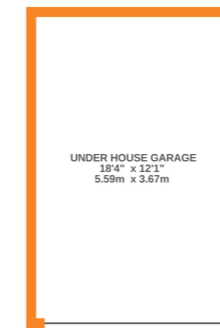

GROUND FLOOR

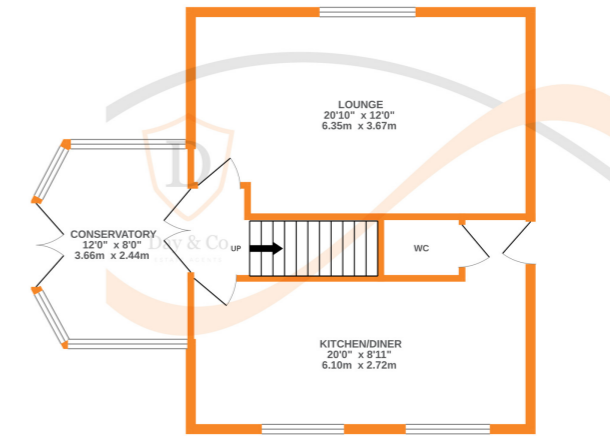

1ST FLOOR

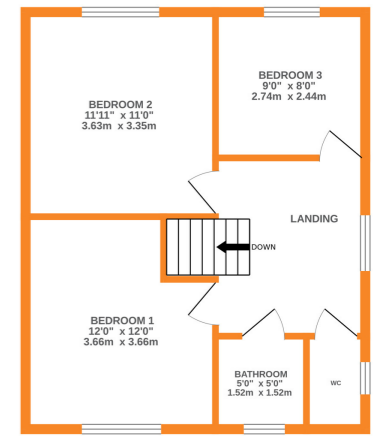

Whilst every attempt has been made to ensure the accuracy of the floorplan contained here, measurements of doors, windows, rooms and any other items are approximate and no responsibility is taken for any error, omission or mis-statement. This plan is for illustrative purposes only and should be used as such by any prospective purchaser. The services, systems and appliances shown have not been tested and no guarantee as to their operability or efficiency can be given.
Made with Metropix ©2024