



Three Bedroom Terraced House
Princes Avenue, Chatham, Kent, ME5 8AX

Offers in Excess of £200,000
Freehold

Princes Avenue, Chatham, Kent, ME5 8AX

Offers in Excess of £200,000

Freehold

Description

Three bedroom end of terrace house with kitchen / breakfast room, lounge, extensive rear garden and garage. The property requires a schedule of renovation and modernisation but presents an opportunity for a buyer to put their own stamp on the property and make it exactly how they'd like. The property is offered with vacant possession.

Please note that there is a connected interest with this property and an employee of Greyfox Sales and Lettings.

Key Features

- 3 Bedroom end of terrace
- Updating and refurbishment required
- No chain
- Garden 20'27 X 120'
- Separate lounge
- Kitchen / breakfast room
- Garage and parking
- Close to local amenities

Local Area

Walderslade is within reach of local primary and secondary schools, shopping parades, doctors surgery and dentist. Being close to Chatham and Maidstone town centres, Capstone Valley Ski and Snowboard Centre, Historic Rochester and Dockside centre plus Bluewater Shopping Centre being approximately 20 minutes away by car. The area offers good transport links to the A2/M2, M20 and M25 plus Ebbsfleet International and Ashford Eurostar

GROUND FLOOR
411 sq.ft. (38.2 sq.m.) approx.

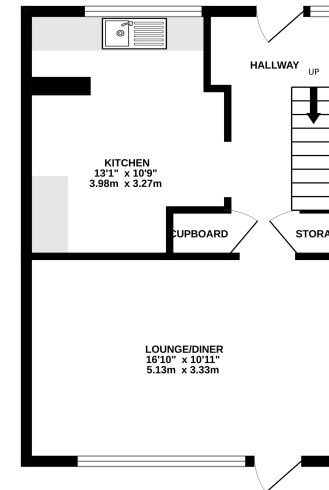

1ST FLOOR
411 sq.ft. (38.2 sq.m.) approx.

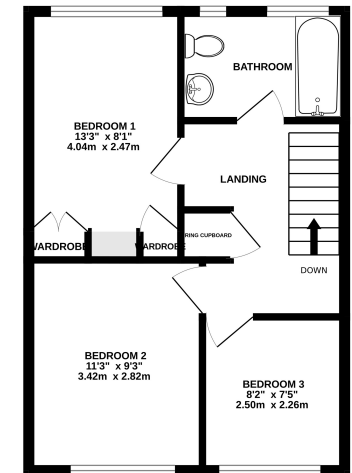

TOTAL FLOOR AREA : 822 sq.ft. (76.4 sq.m.) approx.

Whilst every attempt has been made to ensure the accuracy of the floorplan contained here, measurements of doors, windows, rooms and any other items are approximate and no responsibility is taken for any error, omission or mis-statement. This plan is for illustrative purposes only and should be used as such by any prospective purchaser. The services, systems and appliances shown have not been tested and no guarantee as to their operability or efficiency can be given.
Made with Metropix ©2023



Property Location

Princes Avenue, Chatham, Kent, ME5 8AX

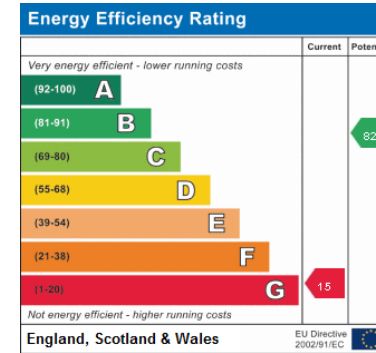
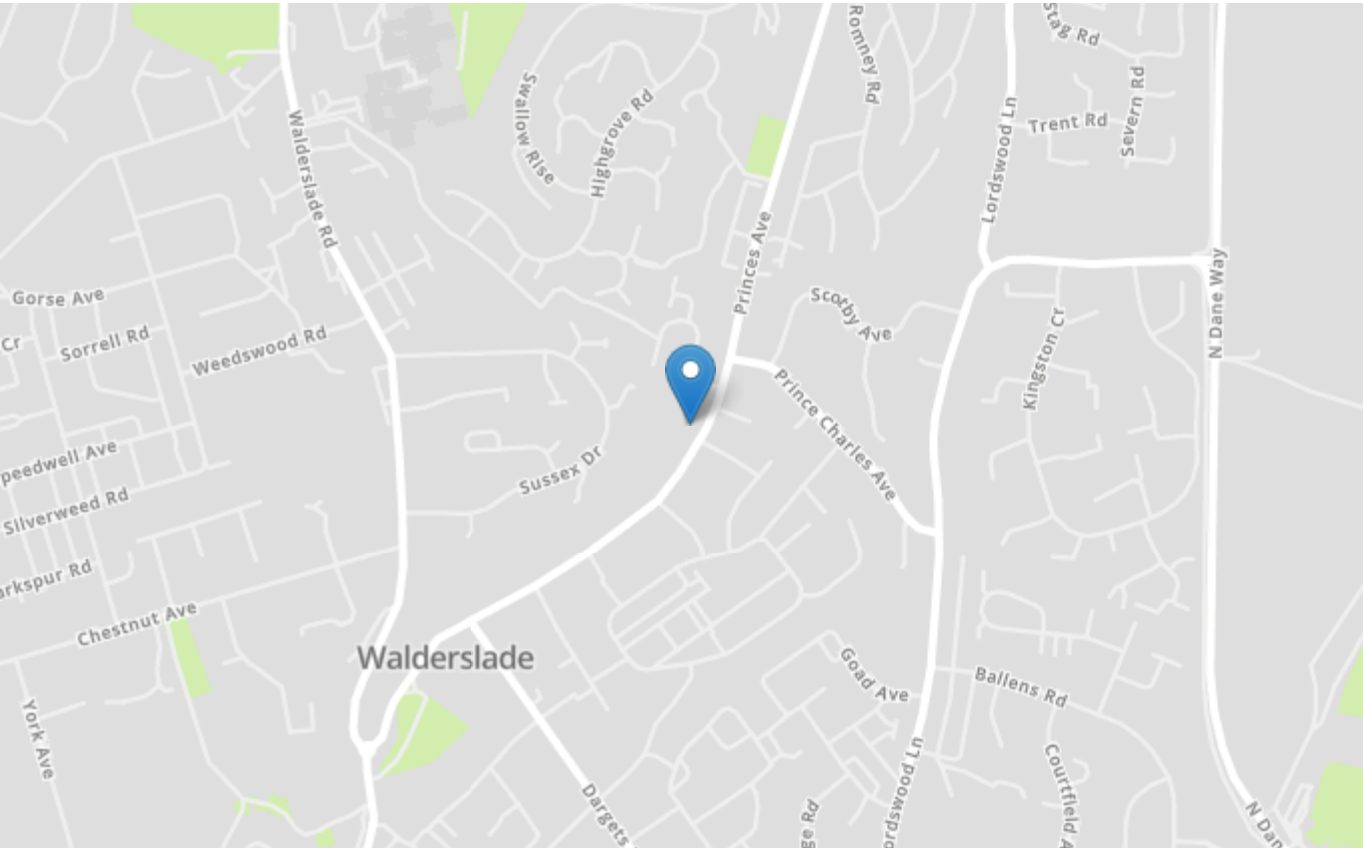

Tenure	Freehold
Lease Term	N/A
Ground Rent	N/A
Service Charge	N/A
Local Authority	
Council Tax	

Greyfox Walderslade

Unit 2, Thetford House
Walderslade Village Centre
Walderslade Road
Chatham
Kent
ME5 9LR
Tel: 01634 672227 Email:
walderslade@greyfox.co.uk

Greyfox Rainham

67C High Street
Rainham
Kent
ME8 7HS
Tel: 01634 377737 Email:
rainham@greyfox.co.uk

Agent Notes

These particulars are prepared as a general guide to a broad description of the property and should not be relied upon as a statement or representation of fact and do not constitute part of an offer or contract. The seller does not make or give nor do our employees or Greyfox have authority to make or give any representation or warranty to the property. We have not carried out a structural survey and the services, appliances and specific fittings have not been tested. All photographs, measurements, floorplans and distances referred to are given as a guide only and should not be relied upon for the purchase of carpets or any other fixtures or fittings. Lease details, service charges and ground rent (where applicable) and council tax are given as a guide only and should be checked and confirmed by you on inspection and your solicitor prior to exchange of contracts. If there are any points of particular importance to you we will be pleased to check the information for you and to confirm that the property remains available. This is particularly important should you be travelling some distance to view and where statements have been made by us to the effect that the information has not been verified. The copyright of all details, photographs and floorplans remain exclusive to Greyfox. For details of our privacy policy and referral fee arrangements with any of our selected partner companies please visit <https://www.greyfox.co.uk/legal/privacy> and <https://www.greyfox.co.uk/referral-fees>.