

Belsize Avenue, W13

Approximate Gross Internal Area = 113.8 sq m / 1225 sq ft

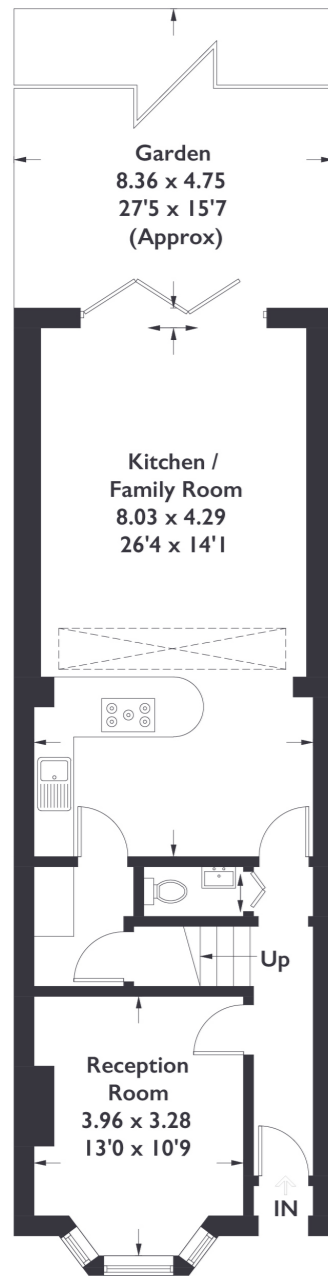

Ground Floor

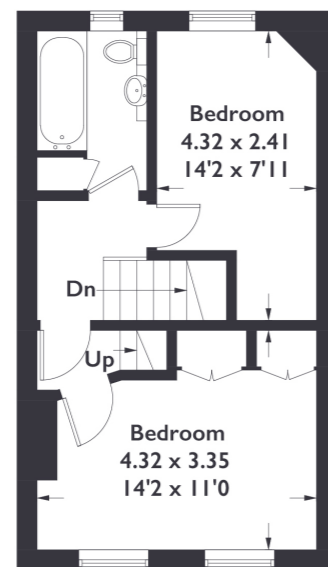

First Floor



Second Floor

Measured in accordance with RICS Code of Measuring Practice. To be used for identification and guidance purposes only. Whilst every care is taken in the preparation of this plan, please check all dimensions, shapes and compass bearings before making any decisions reliant upon them. www.london58.com © 2023 hello@london58.com



3 BEDROOM HOUSE

Belsize Avenue, W13
£895,000

Welcome to this exquisite three bedroom, two bathroom property where luxury meets functionality. The ground floor boasts a convenient W/C, a separate reception room adorned with bay windows, and a open plan kitchen, dining and living area. This space is not only designed for modern living but also features a large pantry, utility space and ample storage under the stairs providing a seamless blend of style and practicality.

FEATURES

- Three Bedrooms
- Two Bathrooms & Downstairs W/C
- Underfloor Heating
- Utility Room & Storage
- Northfields Station
- Fielding Primary Catchment
- EPC Rating D



3 BEDROOM HOUSE

Belsize Avenue, W13

Experience the comfort of underfloor heating in the living area, which leads effortlessly through bifold doors to a delightful garden, offering a perfect extension of your living space.

Upstairs, the property continues to impress with well proportioned bedrooms and a lovely sized bathroom. As you make your way to the top floor, and you'll find a spacious master suite complete with a shower room and built in storage, a private retreat for relaxation.

Nestled in the catchment area of Fielding Primary School, this property is an ideal family home. Convenience takes centre stage as Northfields Station is a mere 60 second walk away, ensuring easy commuting and access to nearby amenities. Embrace the epitome of comfortable and well connected living in this Northfields gem.

EPC Rating D.

