



**Hilton Grange
Knyveton Road
Bournemouth
Dorset
BH1 3QS**

Offers In Excess Of £135,000

bettermove

Knyveton Road Bournemouth

Bettermove are proud to present this 1 bedroom flat in Bournemouth.

The property benefits from double glazing, gas central heating throughout and has off street parking available.

The council tax band is A.

This is a leasehold property with 999 years on the lease from 1980; the ground rent and the service charge is £2,500pa.

The interior of this beautifully presented property comprises a spacious living room, fitted kitchen, 1 bedroom and the bathroom.

Located in the popular town of Bournemouth, the property is close to a range of amenities, including shops, supermarkets, restaurants and pubs. Excellent transport connections can be found from the A338, Bournemouth train station and local bus routes.

This exciting opportunity should not be missed! All enquiries can be made through Bettermove on 0330 004 0050.



GROUND FLOOR
321 sq.ft. (29.8 sq.m.) approx.

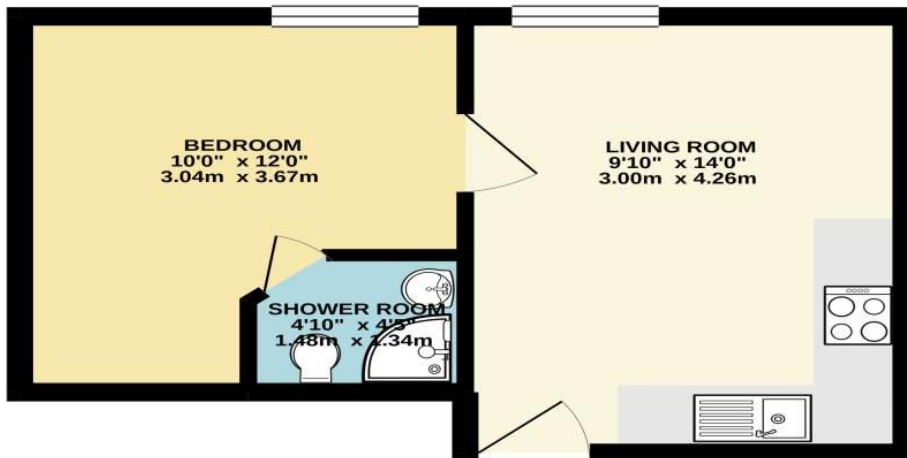

TOTAL FLOOR AREA : 321 sq.ft. (29.8 sq.m.) approx.

Whilst every attempt has been made to ensure the accuracy of the floorplan contained here, measurements of doors, windows, rooms and any other items are approximate and no responsibility is taken for any error, omission or mis-statement. This plan is for illustrative purposes only and should be used as such by any prospective purchaser. The services, systems and appliances shown have not been tested and no guarantee as to their operability or efficiency can be given.
Made with Metropix ©2021

Energy Efficiency Rating		
	Current	Potential
Very energy efficient - lower running costs		
(92+) A		
(81-91) B		
(69-80) C	74	77
(55-68) D		
(39-54) E		
(21-38) F		
(1-20) G		
Not energy efficient - higher running costs		
England, Scotland & Wales	EU Directive 2002/91/EC	

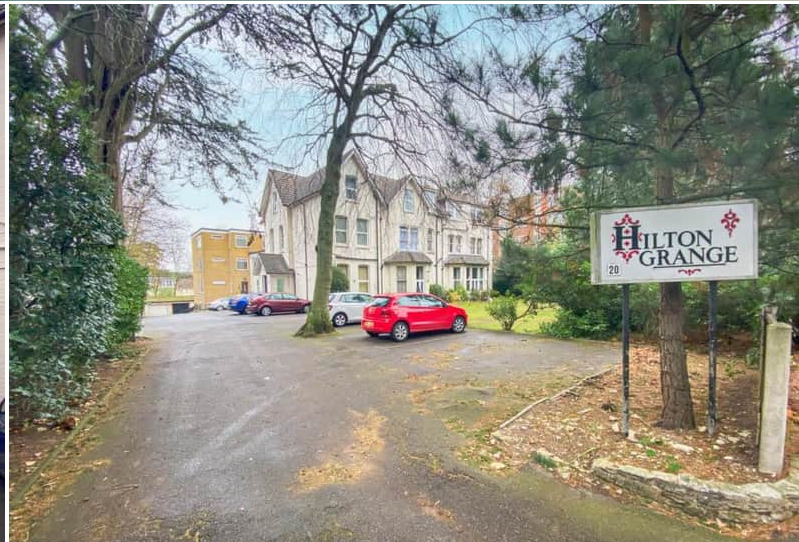

20-22 Bridge End, Leeds, LS1 4DJ
t: 0330 004 0050 e: hello@bettermove.co.uk
www.bettermove.co.uk