



16 The Butts Station Road, Langford, Bedfordshire, SG18 9PN

£200,000

GREAT BUY/INVESTMENT 2 BEDROOM TERRACED Home on small private development and offered with NO CHAIN. Although in need of some updating this property offers great potential and would make an excellent first time purchase or investment property. Spacious hallway with small study area, kitchen plus living room to rear with patio doors onto a lawned area. Upstairs are two good sized bedrooms plus bathroom. Outside is a lawned area leading directly to two private parking spaces.

LEASE 125 years from June 1987. SERVICE/MANAGEMENT CHARGE £70 PER MONTH Which covers building insurance, gardening and external maintenance plus communal lighting. Please note the LEASE can be extended for 999 years. Please call for further details.

*Lane &*  
BENNETTS



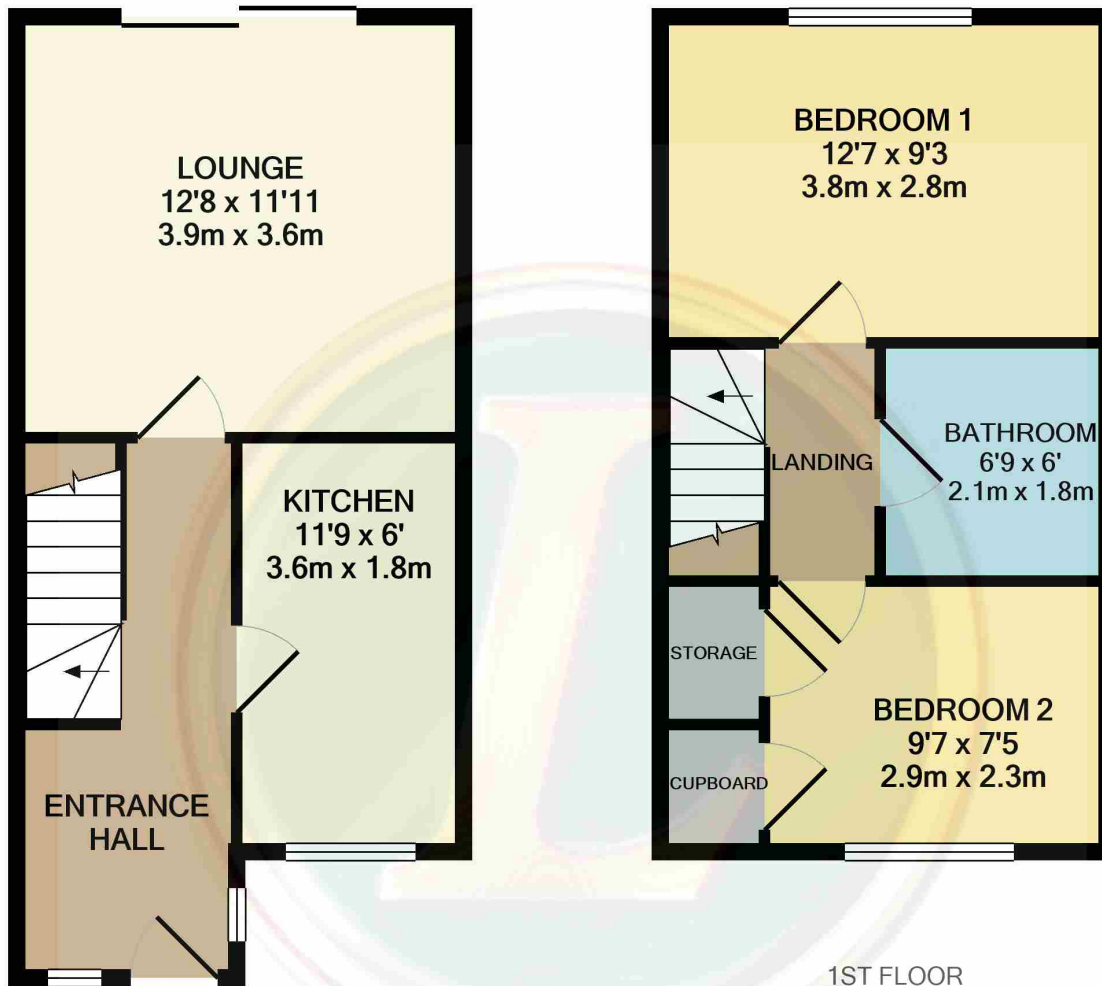

GROUND FLOOR  
APPROX. FLOOR  
AREA 322 SQ.FT.  
(29.9 SQ.M.)

TOTAL APPROX. FLOOR AREA 622 SQ.FT. (57.8 SQ.M.)

Whilst every attempt has been made to ensure the accuracy of the floor plan contained here, measurements of doors, windows, rooms and any other items are approximate and no responsibility is taken for any error, omission, or mis-statement. This plan is for illustrative purposes only and should be used as such by any prospective purchaser. The services, systems and appliances shown have not been tested and no guarantee as to their operability or efficiency can be given

Made with Metropix ©2020

- IDEAL FIRST PURCHASE OR INVESTMENT RENTAL
- NO CHAIN
- SOME UPDATING REQUIRED
- LOUNGE WITH PATIO DOORS ONTO LAWNED AREA
- TWO BEDROOM + UPSTAIRS BATHROOM
- TWO ALLOCATED PARKING SPACES \ COMMUNAL GROUNDS
- EASY ACCESS TO A1 & LOCAL TRAIN STATION
- COUNCIL TAX BAND C | EPC BAND D

