

Truuli



Norbury Rise, London, SW16 4JF

£475,000 Freehold

- Ground floor shower-room and upstairs bathroom
- Overall good condition with some minor decor work
- Close to Norbury train station
- Space to extend at rear and loft (STPP)
- Close to the green spaces of Pollards Hill Park
- Guide price £475,000 - £500,000

Southbridge Place, Surrey, CR0 4HA

Tel: 0330 043 0002

Email: save@truuli.co.uk Web: www.truuli.co.uk

Norbury Rise, London, SW16 4JF

£475,000 Freehold

*** Guide price £475,000 - £500,000 *** An opportunity to acquire this three-bedroom, two-bathroom family home located on this popular residential road in Norbury, SW16.

The property benefits from being near the vast green spaces of Pollards Hill Park.

Ground Floor
574 sq.ft. (53.3 sq.m.) approx.

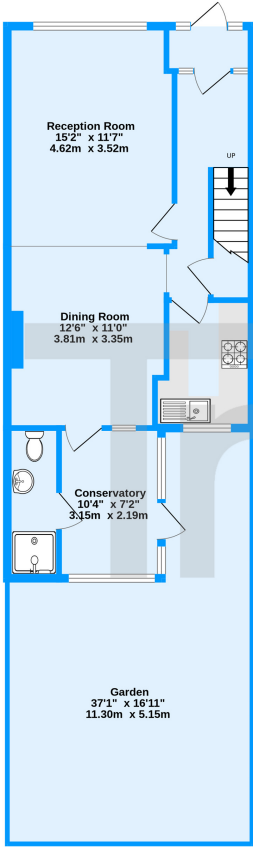

1st Floor
421 sq.ft. (39.1 sq.m.) approx.

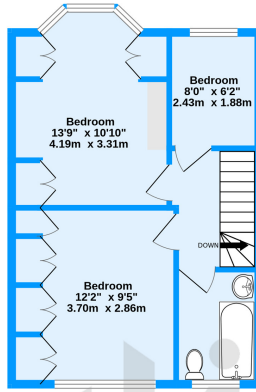

Norbury Rise, Norbury, SW16

TOTAL FLOOR AREA: 995 sq.ft. (92.4 sq.m.) approx.
Measurements are approximate. Not to scale. Illustrative purposes only
Made with Metropix 62024

Energy Efficiency Rating		Current	Potential
Very energy efficient - lower running costs			
(92+)	A		
(81-91)	B		88
(69-80)	C		
(55-68)	D	66	
(39-54)	E		
(21-38)	F		
(1-20)	G		
Not energy efficient - higher running costs			
England, Scotland & Wales		EU Directive 2002/91/EC	

