



Estate Agents and Solicitors

71 Canon Byrne Glebe, Kirkcaldy, Fife, KY1 2RE

Beautifully Presented, One Bedroom, Dual-Aspect, First Floor Flat

Up to date price and viewing info at [mov8realestate.com/property](https://www.mov8realestate.com/property)

éspsc rightmove[®] Zoopla
find your happy

Property Description

Beautifully presented, one bedroom, dual aspect, first floor flat, with an allocated parking space. Forming part of a modern, factored development with a quiet cul-de-sac setting, just north of Kirkcaldy town centre, Fife.

Comprises an entrance hall, living/dining room, kitchen, double bedroom, and a bathroom.

Highlights include a modern fitted kitchen and stylish bathroom, gas central heating, double glazing, and excellent storage provision.

In addition, there is a secured entry system, additional residents' and visitors' parking, and well-maintained communal grounds.

A welcoming entrance hall affords access throughout the property, and features two storage cupboards. Set to the front, a generous living room offers space for both lounge and dining furniture, and features two windows allowing plentiful natural light, wood effect flooring, a central light fitting and cornice-work. Also set to the front, the stylish kitchen is fitted with wall and base units, stone-effect worktops, a tiled-effect surround and a sink with drainer; with appliances including an integrated oven and gas hob.

Set to the rear, the tastefully finished bedroom features carpeted flooring, a central light fitting and two built-in wardrobes with mirror sliding doors. Completing the accommodation, also set to the rear, the bathroom is fitted with a modern three-piece suite including a mains shower over the bath with a rainfall showerhead, tiled splash walls and a ladder-style radiator.



71 Canon Burne Glebe, Kirkcaldy, KY1 2RE

Approximate Gross Internal Area: (527 sq ft - 49 sq m.)

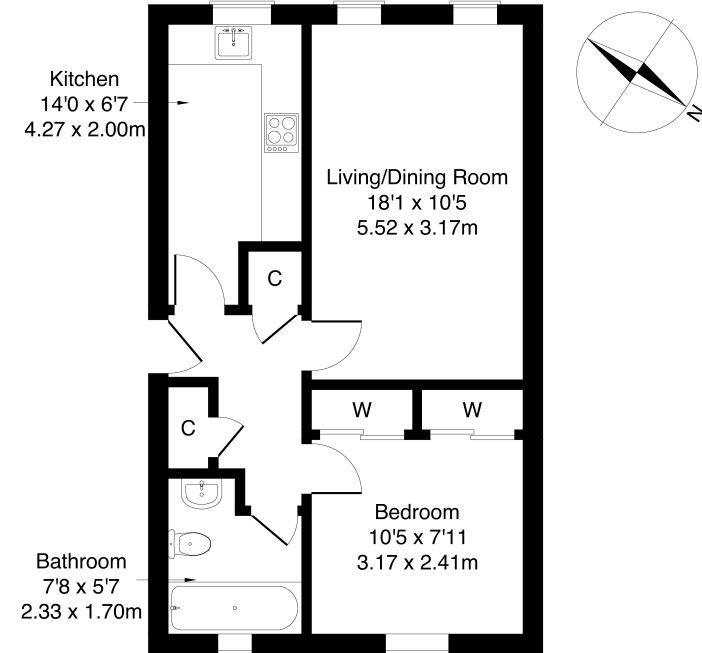

Legal Disclaimer : Floor-plan and measurements are for illustrative guidance only, and not intended to form part of any contract.

Area Description

Kirkcaldy is located on the north coast of the Firth of Forth, and is one of Fife's principal towns. It provides a wide range of retail, cultural and leisure services, as well as primary and secondary schooling, and further education at the Adam Smith College. It is home to a museum and an art gallery, as well as the renowned Adam Smith Theatre. Shopping facilities to be found in the Fife

Central Retail Park include a Sainsbury's, B&Q and Next, with many other high-street names also to be found in the town centre, whilst the modern Victoria Hospital serves much of Fife. The railway station brings Edinburgh and Dundee within easy commuting distance, whilst the A92 allows easy access to the motorway network and Edinburgh Airport.





Our Services

- Free pre-sale property valuations
- Great value fixed estate agency fees
- Extensive buyer matching database
- Purchase and sale conveyancing

Contact Us

0345 646 0208

sales@mov8realestate.com

www.mov8.com

Head Office

6 Redheughs Rigg, Edinburgh, EH12 9DQ

Glasgow Office

77 Renfrew Street, Glasgow, G2 3BZ



Estate Agents and Solicitors



These particulars do not form part of any contract and the statements or plans contained herein are not warranted nor are they to scale. All descriptions, dimensions, areas, reference to condition and necessary permissions for use and occupation and other details are given in good faith, and are believed to be correct, but any prospective purchaser should not rely on them as statements or representations of fact, and any prospective purchaser must satisfy themselves by inspection or otherwise as to the correctness of each of them. The Seller shall not be bound to accept the highest or any offer nor to accept a full offer of the Fixed Price where this is applicable. Approximate measurements have been taken by sonic device and measurements are most often taken to the widest point of any room or space. Services and appliances have not been tested for efficiency or safety and no warranty is given as to their compliance with any Regulations. Offers should be made using the Combined Standard Clauses.