



NEWSON & BUCK
ESTATE AGENTS

16 School Road
Terrington St John
Wisbech
Norfolk
PE14 7SE

£950 pcm

Newson & Buck are delighted to offer this well presented and styled two bedroom semi detached home, situated on School Road in Terrington St John. The property comprises of an entrance hallway, lounge, kitchen diner, two bedrooms and a family bathroom. Furthermore, there is a spacious enclosed rear garden, a garage and offer road parking for numerous vehicles. Further benefits include oil central heating heating and Upvc double glazing. The property is located within walking distance of the local school and is just six miles from King's Lynn Town Centre which in itself has mainline rail links to Cambridge and London.

- Two Bedrooms
- Off Road Parking For Numerous Vehicles
- Garage
- Rear Garden
- Kitchen Diner
- Oil Central Heating & New Double Glazing
- Close Proximity to Local School
- EPC RATING D
- AVAILABLE NOW
- COUNCIL TAX BAND B



Entrance Hallway

Tiled flooring, one radiator, staircase to first floor.

Lounge

11' 07" x 14' 01" (3.53m x 4.29m) Fitted carpet, one radiator, one double glazed window.

Kitchen

14' 11" x 11' 09" (4.55m x 3.58m) Tiled flooring, fitted kitchen units, sink, space for washing machine and fridge freezer, two double glazed windows, one radiator, storage cupboard.

Bedroom One

14' 11" x 11' 10" (4.55m x 3.61m) Fitted carpet, one radiator, one double glazed window.

Bedroom Two

8' 05" x 11' 0" (2.57m x 3.35m) Laminate flooring, one radiator, fitted cupboard space, one double glazed window.

Bathroom

6' 01" x 8' 04" (1.85m x 2.54m) Vinyl flooring, bath tub with shower, pedestal sink, low flush w/c, one radiator, one double glazed window.

Garage

9' 09" x 20' 06" (2.97m x 6.25m) Up and over front door, side exit door.

Rear Garden

Enclosed rear garden.



GROUND FLOOR

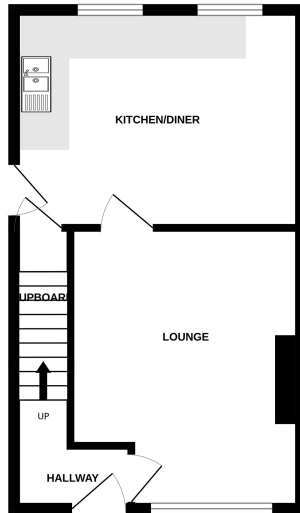

1ST FLOOR

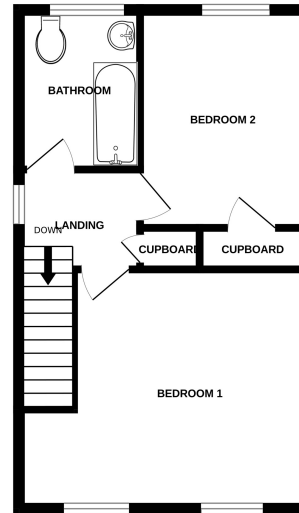

Whilst every attempt has been made to ensure the accuracy of the floorplan contained here, measurements of doors, windows, rooms and any other items are approximate and no responsibility is taken for any error, omission or mis-statement. This plan is for illustrative purposes only and should be used as such by any prospective purchaser. The services, systems and appliances shown have not been tested and no guarantee as to their operability or efficiency can be given.
Made with Netopix ©2024.



18-20 King Street, King's Lynn, Norfolk, PE30 1ES

Tel: 01553 775151 Email: kingslynn@millsopps.com www.millsopps.com