



Sutton Place, Bexhill-on-Sea, East Sussex, TN40 1PG
£1,000 pcm





Property Café are delighted to offer this well presented two bedroom apartment to the lettings market. The property is located on the third floor of a purpose built block directly on the seafront with amazing viewings across the English Channel. Internally the property benefits from a spacious living room with access to a private balcony looking out to sea, fitted kitchen with electric oven and hob, bathroom with shower over the bath and two bedrooms both with storage. The property has been decorated in neutral tones throughout and also benefits from gas central heating, double glazing, lift access and an allocated parking bay. Water rates are also included in the rent and internal viewings are highly recommended. A minimum annual income of £30,000 per household is required to be eligible for this property. To arrange a viewing, please contact our Bexhill office on 01424 224488 option 3.



THIRD FLOOR
686 sq.ft. (63.7 sq.m.) approx.

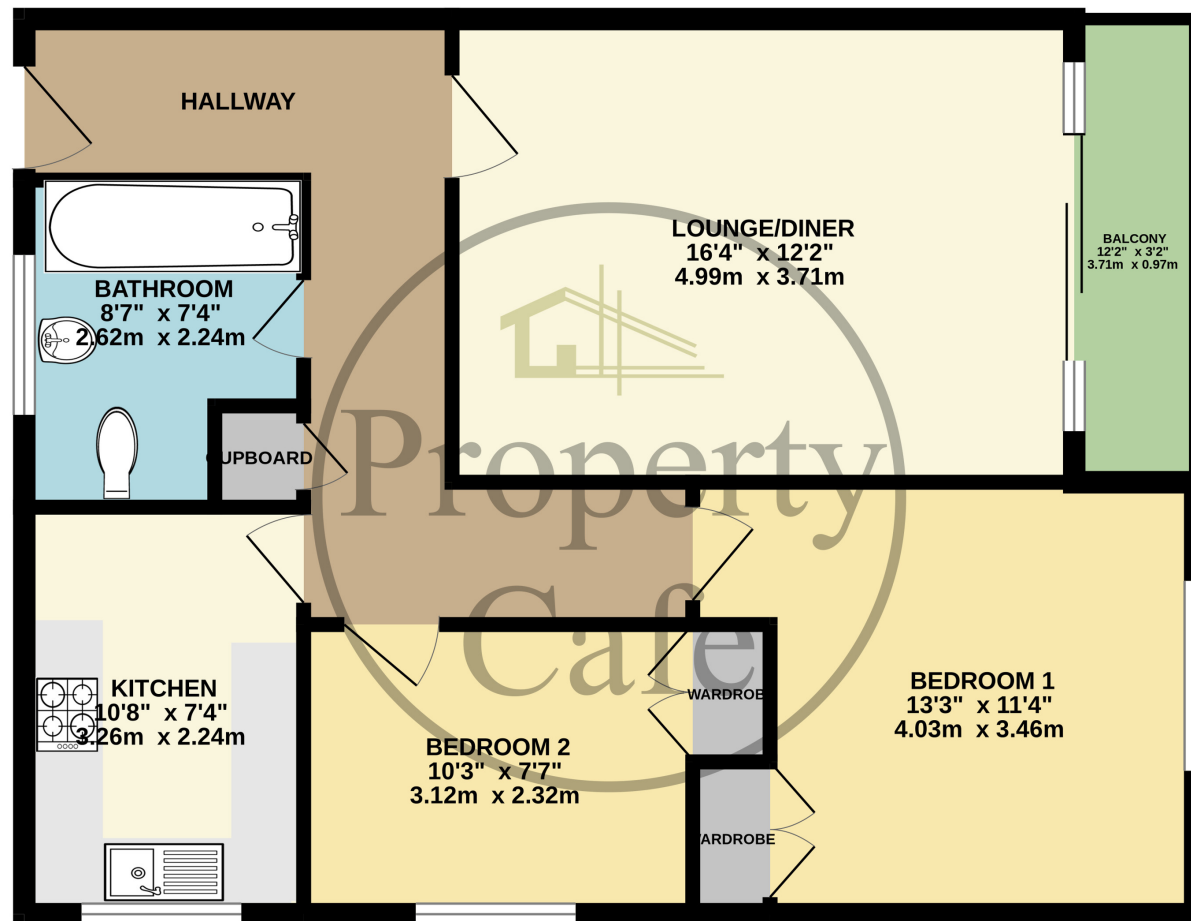

TOTAL FLOOR AREA : 686 sq.ft. (63.7 sq.m.) approx.

Whilst every attempt has been made to ensure the accuracy of the floorplan contained here, measurements of doors, windows, rooms and any other items are approximate and no responsibility is taken for any error, omission or mis-statement. This plan is for illustrative purposes only and should be used as such by any prospective purchaser. The services, systems and appliances shown have not been tested and no guarantee as to their operability or efficiency can be given.

Made with Metropix ©2023







- Stunning sea views.
- Private balcony.
 - Two double bedrooms.
- Third floor flat with lift access.
- Spacious living room.
- Fitted kitchen.
- Bathroom with shower over bath
- Neutrally decorated throughout.
- Double glazing and gas central heating.
- Available end of August.