



Mynors Street,
Hanley



OneAgency

01782 970222

hello@oneagencygroup.co.uk



Offers in Excess of £65,000

A two bedroom mid town house in the popular location of Hanley, within walking distance to the town centre. In need of full modernisation! The property benefits from front and rear gardens, lounge with bay window and two good sized bedrooms. An ideal investment property or buy to let! Viewing is highly advised. No Chain!





Ground Floor

Hall

UPVC front door and tiled flooring.

Lounge

3.92m x 3.77m (12' 10" x 12' 4") A double glazed bay window to the front and under stairs storage cupboard.

Kitchen

3.23m x 2.47m (10' 7" x 8' 1") Wall and base units, double glazed window and tiled flooring.

Guest W/C

A useful ground floor low level W/C.

First Floor

Bedroom One

3.93m x 3.78m (12' 11" x 12' 5") A double glazed window and radiator.

Bedroom Two

2.73m x 2.52m (8' 11" x 8' 3") A double glazed window and radiator.

Bathroom

2.09m x 1.80m (6' 10" x 5' 11") A white suite with bath, pedestal hand wash basin, low level W/C, double glazed window and radiator.

External

Front - A front rear courtyard with steps to the front door.

Rear - A paved patio area with steps leading to lawned section with fenced borders.

AGENTS NOTES

The council tax is band A. The local authority is Stoke-on-Trent.



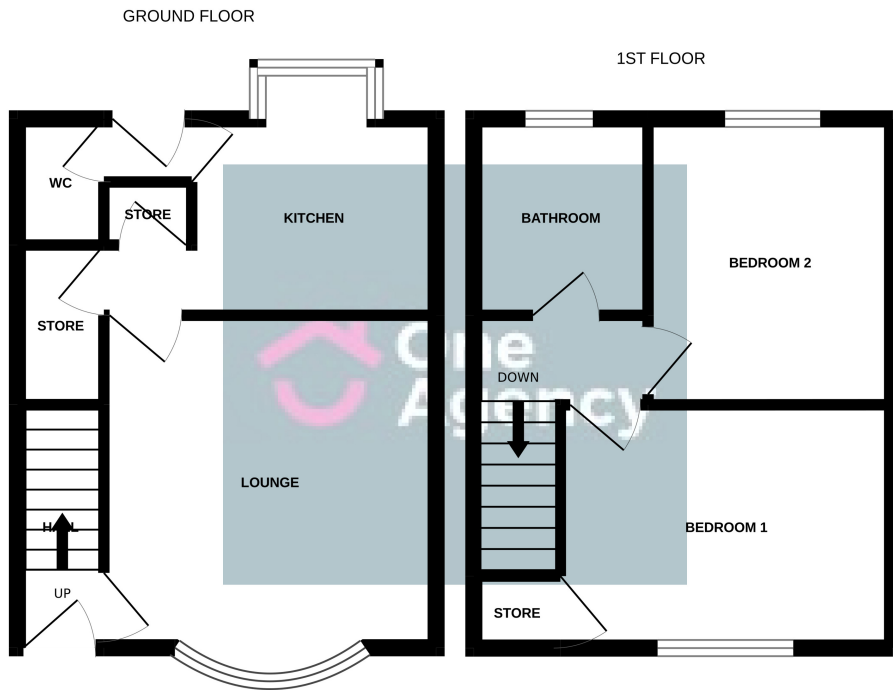

Whilst every attempt has been made to ensure the accuracy of the floorplan contained here, measurements of doors, windows, rooms and any other items are approximate and no responsibility is taken for any error, omission or mis-statement. This plan is for illustrative purposes only and should be used as such by any prospective purchaser. The services, systems and appliances shown have not been tested and no guarantee as to their operability or efficiency can be given.

Made with Metropix ©2022

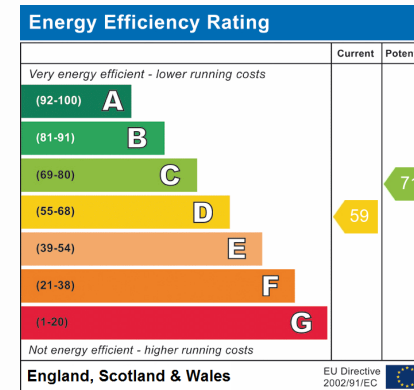

OneAgency, 9 & 10 Ridge House Drive, Festival Park, Stoke-on-Trent, ST1 5SJ

01782 970222

hello@oneagencygroup.co.uk

Every attempt has been made to ensure accuracy, however, all measurements are approximate and for illustrative purposes only. **Not to scale.**

In accordance with The Consumer Protection from Unfair Trading Regulations 2008 the following particulars have been prepared in good faith and they are not intended to constitute part of an offer or contract. We have not carried out a structural survey and the services, appliances and specific fittings have not been tested. All photographs, measurements, floor plans and distances referred to are given as a guide only and should not be relied upon for the purchase of carpets or any other fixtures and fittings. Lease details, service charges and ground rent (where applicable) are given as a guide only and should be checked and confirmed by your Solicitor prior to exchange of contracts.