



Shefford Road, Clifton, Bedfordshire. SG17 5WB

Satchells



2 Bedroom Bungalow

£1,700 pcm

Additional charges may apply

Welcome to Shefford Road, a beautifully designed new detached bungalow offering modern comfort, quality craftsmanship, and effortless single-level living. This newly built home combines contemporary style with practical design, making it ideal for families, professionals, or those looking to downsize without compromise.

The thoughtfully planned layout features bright, open living spaces filled with natural light, creating a warm and inviting atmosphere. The open-concept design seamlessly connects the living, dining, and kitchen areas—perfect for everyday living and entertaining. High-quality finishes and modern details throughout reflect the home's new construction and attention to detail. Available now. View ASAP to avoid disappointment.

- Brand new detached bungalow
- Stunning kitchen/dining area
- Parking for several cars and electric car charging point
- Two double bedrooms
- Four piece family bathroom
- Energy efficient 'Air Source' heat pump
- Pets considered
- Peaceful Location
- Available now
- EPC rating B. Council tax band E

Welcome to Shefford Road, a beautifully designed new detached bungalow offering modern comfort, quality craftsmanship, and effortless single-level living. This newly built home combines contemporary style with practical design, making it ideal for families, professionals, or those looking to downsize without compromise.

The thoughtfully planned layout features bright, open living spaces filled with natural light, creating a warm and inviting atmosphere. The open-concept design seamlessly connects the living, dining, and kitchen areas—perfect for everyday living and entertaining. High-quality finishes and modern details throughout reflect the home's new construction and attention to detail.

A security deposit is payable at the time of your offer being accepted by the landlord/s. This is equivalent to one weeks rent and for this property is £391.23. This does then form part of your five-week holding deposit meaning once all satisfactory references are passed you will then be required to pay £1,564.93

For more information, please contact the office.

Agents Note:

Draft particulars yet to be approved by the vendor and may be subject to change.

Anti-Money Laundering (AML):

It is a legal requirement that all purchasers comply with Anti-Money Laundering regulations. As such, once a purchase has been agreed subject to contract, the purchaser/s will be required to undertake an AML and financial sanctions check carried out by our third party provider at a cost of £66 inclusive of VAT per property, payable by the applicant/s.



These particulars are a guide only and do not constitute an offer or a contract. The floor plan is for identification purposes only and not to scale. All measurements are approximate and should not be relied upon if ordering furniture, white goods and flooring etc. We have presented the property as we feel fairly describes it but before arranging a viewing or deciding to let, should there be anything specific you would like to know about the property please enquire. Satchells have not tested any of the appliances or carried out any form of survey and advise you to carry out your own investigations on the state, condition, structure, services, title, tenure, and council tax band of the property or the tenancy terms. Some images may have been enhanced and the contents shown may not be included in the letting. Satchells routinely refer to 3rd party services for which we receive an income from their fee. If you would like us to refer you to one of these services please ask one of our staff who will pass your details on. We advise you check the availability of the property on the day of your viewing.

Satchells

Ground Floor

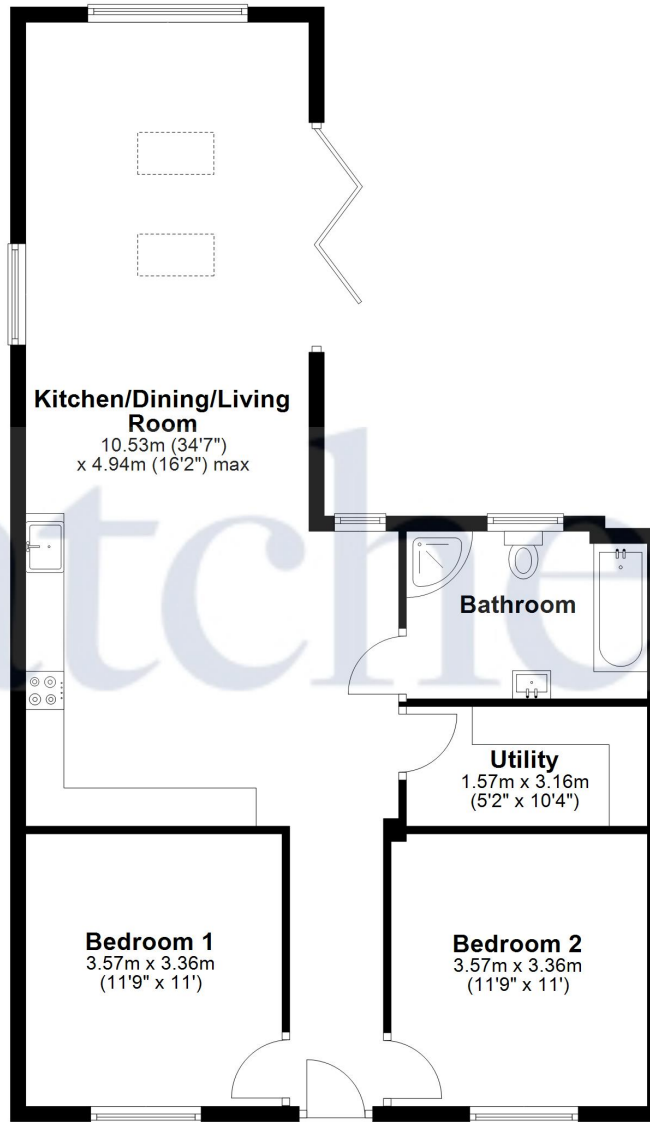

For illustrative purposes only - NOT TO SCALE - Measurements shown are approximate. The size and position of doors, windows, appliances and other features are approximate.
Plan produced using PlanUp.